

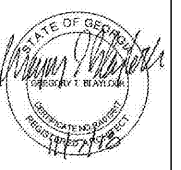

**RULE JOY TRAMMELL RUBIO**  
ARCHITECTURE INTERIOR DESIGN  
3000 Galloway Parkway Suite 740 Atlanta Georgia 30328  
770-661-1492 (phone) 770-661-1493 (fax)  
www.rjtdesign.com

PRINTED  
DATE 11/01/18  
ISSUE/REVISION Issued for Permit



LEVEL ONE RCP  
**EXTENDED STAY AMERICA**  
FOOLER, GA

COMMISSION NO: 18-276-6  
DRAWING NO:

A2.01

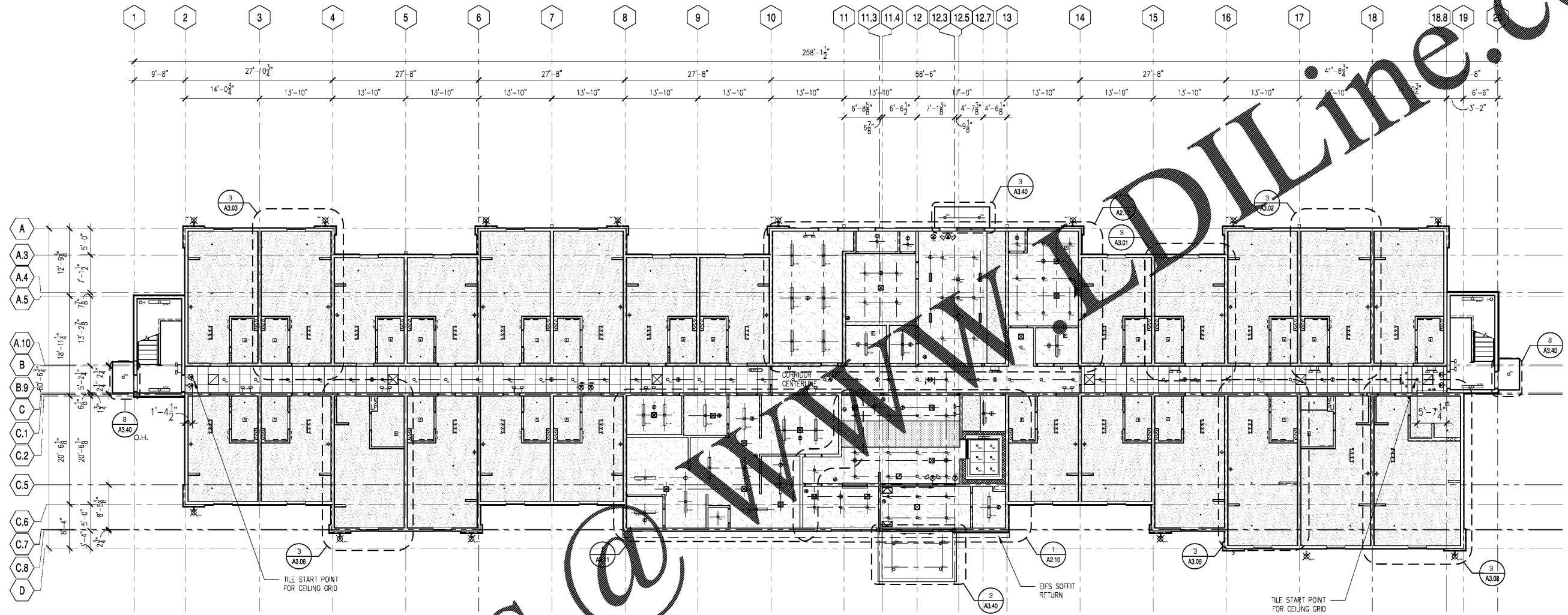

**1 LEVEL ONE RCP**  
Scale: 1/8"=1'-0"

**Order Plans**

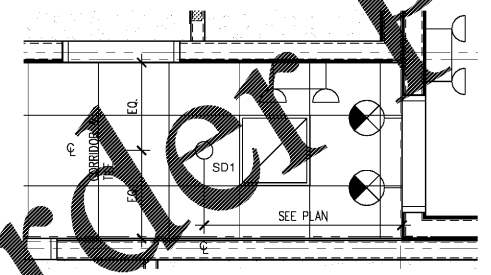

**2 TYP. CEILING TILE START POINT**  
Scale: 1/8"=1'-0"

REFLECTED CEILING SYMBOL LEGEND	
SYMBOL	DESCRIPTION
○ GL3	SURFACE DOWNLIGHT 4"
⊗ DP#	DECORATIVE PENDANT
⊕ GL7	DECORATIVE WALL SCONCE (PLUG-IN)
▽▽▽ GL2	TRACK LIGHTING
⊗ LF01	EXTERIOR WALL SCONCE
○ RD4	EXTERIOR SURFACE DOWNLIGHT 4"
▬ ELT06	LINEAR FLUSH SURFACE MOUNT LED WRAP (FIXTURES IN STAIRS ARE WALL MOUNT)
⊕	EMERGENCY BATTERY PACK
⊕ ⊕ ⊕ LOW	EXIT LIGHTS, SEE ELECTRICAL DWGS. & INTERIOR ELEVATIONS
F	EXHAUST FAN
⊗ ⊗	DIFFUSERS (SUPPLY/RETURN)
⊕	FIRE ALARM SMOKE DETECTOR
⊕	FIRE ALARM HEAT DETECTOR
⊕	VIDEO SURVEILLANCE CAMERA

REFLECTED CEILING PLAN KEY	
CEILING TAG	
○	CEILING HEIGHT A.F.F. OF EACH ROOM
▬	CEILING FINISH
▬	CEILING TYPE (SEE LEGEND)
CEILING TYPE LEGEND	
A	5/8" GYPSUM BOARD RATED ASSEMBLY. GUESTROOM BATHROOM CEILINGS TO BE MOISTURE RESISTANT & RATED GYPSUM BOARD.
B	SUSPENDED ACOUSTICAL CEILING TILE/GRID SYSTEM
C	LINEAR WOOD CEILING SYSTEM (MILLWORK) OVER CEILING TYPE 'A'.
REFLECTED CEILING PLAN KEY NOTES	
1	CENTER FIXTURE TO ROOM
2	DECORATIVE PENDANT FIXTURE
3	INSTALL ROLLER SHADE ON OFFICE SIDE OF WINDOW. SEE AT.07 FOR SHADE DETAILS
4	GYP. SOFFIT
5	GYP. BULKHEAD
6	ACCESS PANELS FOR SLIDING DOOR MOTOR
7	CEILING MOUNT DUPLEX/DATA/TV RECEPTACLE TO BE INSTALL BEHIND CEILING MOUNTED TV. SEE INTERIOR ELEVATIONS FOR TV LOCATION.
8	STAIRS: PROVIDE 2-HR HORIZONTAL SHAFT ASSEMBLY AT LEVEL 4 CEILING, SEE SYSTEM No. AER-09038 ON SHEET AT.05H FOR DETAILS.

GENERAL NOTES	
1.	DIMENSIONS ARE TO FACE OF STUD AND CENTER OF FIXTURE, UNO.
2.	REFER TO AT.06 & AT.07 AND ELECTRICAL DRAWINGS FOR FIXTURE INFORMATION.
3.	CENTER ALL EXIT SIGNS, SMOKE DETECTORS, ETC. IN THE CENTERLINE OF CORRIDORS AND CENTERLINE OF LIGHT FIXTURES, UNO, OR VIOLATION OF APPLICABLE CODES WOULD OCCUR.
4.	INSTALL REGISTERS AND LIGHT FIXTURES WITHIN GRID LINES. INSTALL SPEAKERS, LIGHT FIXTURES, AND OTHER CEILING ELEMENTS IN THE GEOMETRIC CENTER OF ACOUSTICAL UNITS OR CEILING PANELS, UNO.
5.	IN ACOUSTICAL CEILINGS, LOCATE ALL SPRINKLER HEADS IN THE GEOMETRIC CENTER OF PANELS, UNO. IF IT IS NOT POSSIBLE TO LOCATE SPRINKLER HEADS AS REQUIRED ABOVE FOR ANY REASON, INCLUDING, WITHOUT LIMITATION, CODE REQUIREMENTS, DO NOT PROCEED WITH WORK UNTIL SUCH CONDITIONS HAVE BEEN REVIEWED WITH ARCHITECT.
6.	PROVIDE SPRINKLER HEAD LOCATIONS FOR ARCHITECT'S REVIEW FOR AESTHETIC PURPOSES PRIOR TO ANY INSTALLATION, AND PRIOR TO SUBMITTING DRAWINGS FOR PERMIT. CONTRACTOR WILL, OTHERWISE, BE REQUIRED TO RELOCATE HEADS AT ITS SOLE EXPENSE.
7.	SEE MEP DRAWINGS FOR DESIGN OF MECHANICAL AND ELECTRICAL SYSTEMS. ARCHITECTURAL PLANS GOVERN FOR LOCATION OF ITEMS INSTALLED IN CEILINGS. NOTIFY ARCHITECT IF CONFLICTS OCCUR.
8.	SEE ELECTRICAL DRAWINGS FOR FIXTURE SCHEDULE, EXIT LIGHTS AND OTHER LIFE SAFETY DEVICES.
9.	ARRANGE CONCEALED ITEMS TO PROVIDE ADEQUATE CLEARANCES FOR CEILING AND ITS DEVICES.
10.	VERIFY ACCESS PANEL LOCATIONS WITH ARCHITECT PRIOR TO LAYOUT OF WORK REQUIRING ACCESS.
11.	PLUMB ALL STEM, AIRCRAFT CABLE, AND APPURTENANCES USED TO SUPPORT SUSPENDED LIGHT FIXTURES, UNO.
12.	FINISH HVAC DIFFUSERS, DRAPERY POCKETS, AND SPEAKER GRILLES TO MATCH ADJACENT FINISH, UNO.
13.	ALL SPRINKLER HEADS TO BE CONCEALED AND PROVIDE CAPS WHICH ARE FACTORY-PAINTED TO MATCH THE CEILING IN ALL DRYWALL CEILINGS. LOCATE ALL HEADS TO ALIGN WITH LIGHT FIXTURES, UNO.
14.	REFERENCE SPEC. SECTION 092900 FOR CONTROL JOINT LOCATIONS IN GYPSUM CEILINGS.
15.	PROVIDE PAINT (P120B) FOR CEILING VENTS AND ACCESS PANELS.

ISSUED FOR CONSTRUCTION