

PRINTED
 DATE 11/01/18
 ISSUE/REVISION Issued for Permit

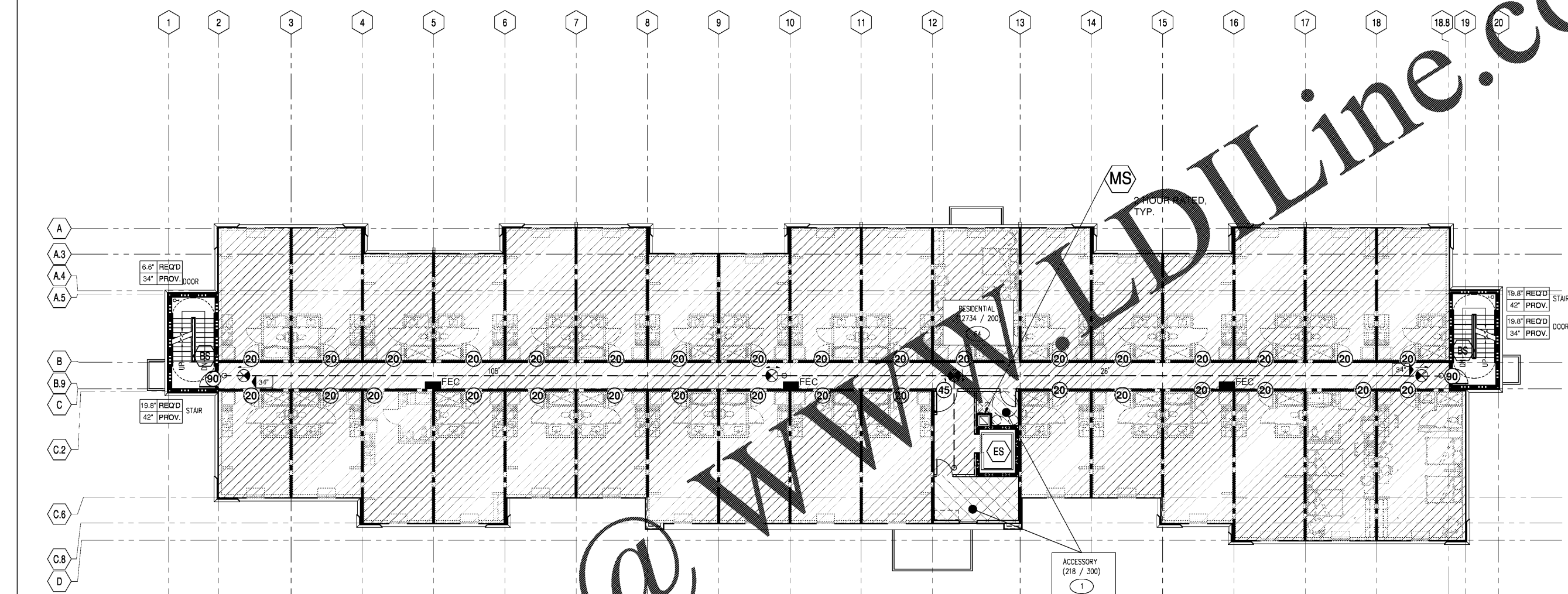

ISSUED FOR CONSTRUCTION
 LIFE SAFETY PLAN - LEVELS 2-4
EXTENDED STAY AMERICA
 COMMISSION NO: 18-276-G
 DRAWING NO:
 LS.02
 FOOILER, GA



1 LIFE SAFETY PLAN - LEVELS 2-4
 Scale: 1/8"=1'-0"

Project Information Table

- Project is a 4-story hotel, R1 occupancy.
- Project is type Five-A construction, fully sprinklered with NFPA 13R sprinkler system.
- Project is 124 keys total
 - Area of L1 = 13,515
 - Area of L2 = 13,454
 - Area of L3 = 13,454
 - Area of L4 = 13,454
 - Total Project Area = 53,877

LIFE SAFETY PLAN KEYNOTES

- BS BUILDING EXIT STAIR**
 2-HOUR FIRE-RATED SHAFT ENCLOSURE: IBC 708.4
 PRESSURIZED STAIR OPTION: NCBC 909.20.5
 SMOKEPROOF ENCLOSURE: REQUIRED PER IBC 708.4.1
 90° MIN. DOORS: IBC TABLE 715.4
 EGRESS THRU AREAS ON LEVEL OF DISCHARGE ALLOWED PER NCBC 1027, EXCEPTION 1 & IBC 1022.9.1, EXCEPTION 4
- ES ELEVATOR SHAFT**
 2-HOUR FIRE-RATED: IBC 708.4
 FIRE-RATED SHAFT NOT REQUIRED IN OPEN PARKING GARAGES: 708.2, EXCEPTION 14
- ER ELECTRICAL ROOM**
 1-HOUR FIRE-RATED:
 45-MINUTE DOORS: IBC TABLE 716.5

LIFE SAFETY LEGEND

- 1 HOUR FIRE-RATED
- 2 HOUR FIRE-RATED
- 75' → EGRESS PATH & TRAVEL DISTANCE
- FE ● BRACKET-MOUNTED FIRE EXTINGUISHER
- FEC ■ FIRE EXTINGUISHER CABINET
- EXIT LIGHT WITH ARROW DIRECTION
- XX EXIT WIDTH IN INCHES
- XX RATED DOOR ASSEMBLY IN MINUTES

**TYPE VA CONSTRUCTION, FULLY SPRINKLERED
 RESIDENTIAL - GROUP R1 OCCUPANCY**

- TRAVEL DISTANCE**
 300' MAX IF FIRE SPRINKLERED: IBC TABLE 1016.1
- MAX. DEAD END**
 50' MAX IF FIRE SPRINKLERED: IBC 1018.4, EXCEPTION 2
- MIN. NUMBER OF EXITS**
 2 EXITS: IBC 1021.1 TABLE 1021.1
- MAX. COMMON PATH OF TRAVEL**
 100' MAX IF FIRE SPRINKLERED: IBC 1014.3, EXCEPTION 1

EGRESS CAPACITY CALCULATION

EGRESS WIDTHS PER FBC 1005.1	
STAIRWAYS	= 0.3 INCHES PER OCCUPANT
OTHER EGRESS COMPONENTS (DOORS)	= 0.2 INCHES PER OCCUPANT
GROSS AREA	= 13,507 SF
OCCUPANT LOAD	= 78 OCCUPANTS
REQUIRED EGRESS WIDTH	
STAIRWAYS	= 78 OCC. x 0.3" = 23.4"
OTHER EGRESS COMPONENTS	= 78 OCC. x 0.2" = 15.6"
PROVIDED EGRESS WIDTH	
STAIRWAYS	= 42' x 2 = 84"
OTHER EGRESS COMPONENTS	= 34' x 2 = 68"

OCCUPANCY LEGEND

- ACCESSORY STORAGE / MAINTENANCE: 300 GROSS
- BUSINESS: 100 GROSS
- FITNESS: 50 GROSS
- RESIDENTIAL: 200 GROSS

Order Plans @