

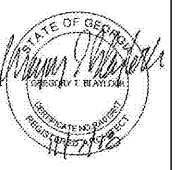

**RULE JOY TRAMMELL | RUBICOR DESIGN**  
 ARCHITECTURE | INTERIOR DESIGN  
 300 Galloway Parkway, Suite 740, Atlanta, Georgia 30303  
 770-661-1492 (phone) 770-661-1493 (fax)  
 www.rjtdesign.com

PRINTED	
DATE	ISSUE/REVISION
11/01/18	Issued for Permit



LIFE SAFETY PLAN - LEVEL ONE PLAN  
**EXTENDED STAY AMERICA**  
 COMMISSION NO: 18-276-6  
 DRAWING NO:

FOOLER, GA

ISSUED FOR CONSTRUCTION  
**LS.01**

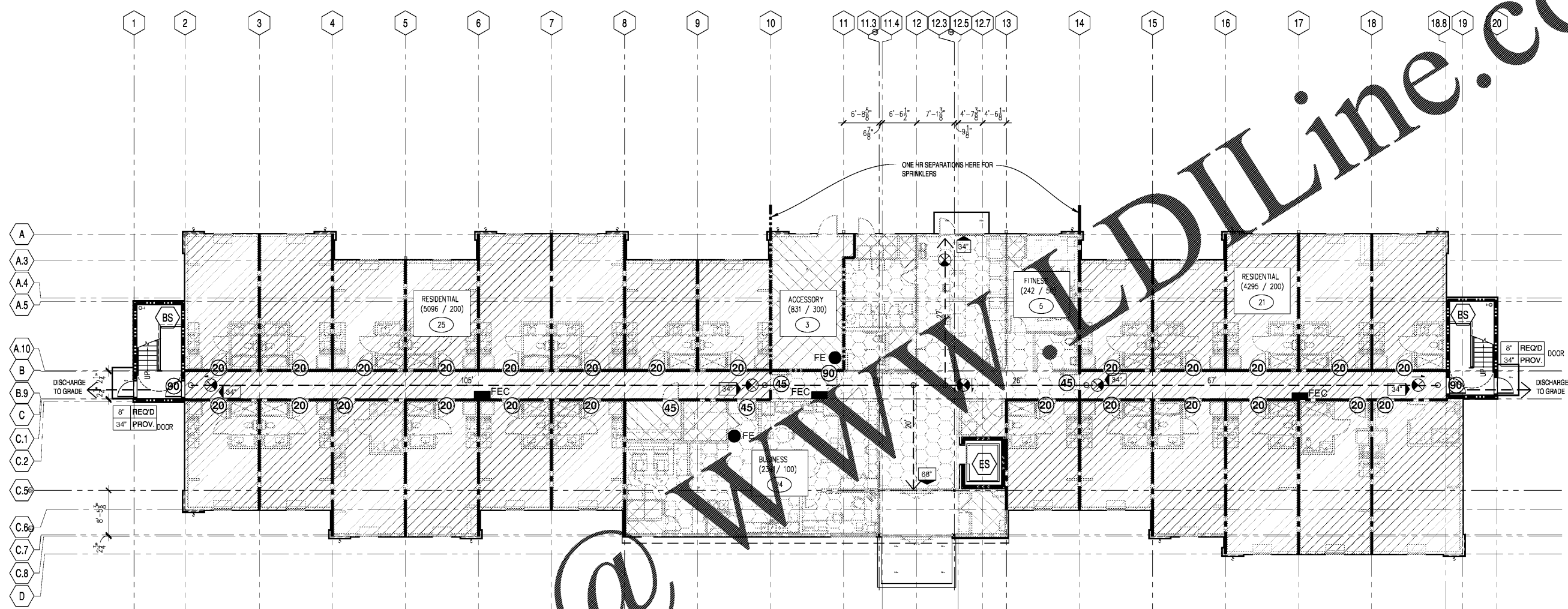

**1 LIFE SAFETY PLAN - LEVEL ONE**  
 Scale: 1/8"=1'-0"

**Project Information Table**

- Project is a 4-story hotel, R1 occupancy.
- Project is type Five-A construction, fully sprinklered with NFPA 13R sprinkler system.
- Project is 124 keys total

Area of L1 =	13,515
Area of L2 =	13,454
Area of L3 =	13,454
Area of L4 =	13,454
<b>Total Project Area =</b>	<b>53,877</b>

**LIFE SAFETY PLAN KEYNOTES**

**BS BUILDING EXIT STAIR**  
 2-HOUR FIRE-RATED SHAFT ENCLOSURE: IBC 708.4  
 PRESSURIZED STAIR OPTION: NCBC 909.20.5  
 SMOKEPROOF ENCLOSURE: REQUIRED PER IBC 708.4.1  
 90° SWING DOORS: IBC TABLE 715.4  
 EGRESS THRU AREAS ON LEVEL OF DISCHARGE ALLOWED PER NCBC 1027, EXCEPTION 1 & IBC 1022.9.1, EXCEPTION 4

**ES ELEVATOR SHAFT**  
 2-HOUR FIRE-RATED: IBC 708.4  
 FIRE-RATED SHAFT NOT REQUIRED IN OPEN PARKING GARAGES: 708.2, EXCEPTION 14

**ER ELECTRICAL ROOM**  
 1-HOUR FIRE-RATED:  
 45-MINUTE DOORS: IBC TABLE 716.5

**LIFE SAFETY LEGEND**

	1 HOUR FIRE-RATED
	2 HOUR FIRE-RATED
	EGRESS PATH & TRAVEL DISTANCE
	BRACKET-MOUNTED FIRE EXTINGUISHER
	FIRE EXTINGUISHER CABINET
	EXIT LIGHT WITH ARROW DIRECTION
	EXIT WIDTH IN INCHES
	RATED DOOR ASSEMBLY IN MINUTES

**TYPE VA CONSTRUCTION, FULLY SPRINKLERED**  
**RESIDENTIAL - GROUP R1 OCCUPANCY**

**TRAVEL DISTANCE**  
 300' MAX IF FIRE SPRINKLERED: IBC TABLE 1016.1

**MAX. DEAD END**  
 50' MAX IF FIRE SPRINKLERED: IBC 1018.4, EXCEPTION 2

**MIN. NUMBER OF EXITS**  
 2 EXITS: IBC 1021.1 TABLE 1021.1

**MAX. COMMON PATH OF TRAVEL**  
 100' MAX IF FIRE SPRINKLERED: IBC 1014.3, EXCEPTION 1

**EGRESS CAPACITY CALCULATION**

EGRESS WIDTHS PER FBC 1005.1	= 0.3 INCHES PER OCCUPANT
STAIRWAYS	= 0.2 INCHES PER OCCUPANT
OTHER EGRESS COMPONENTS (DOORS)	= 0.2 INCHES PER OCCUPANT
<b>GROSS AREA</b>	<b>= 13,507 SF</b>
<b>OCCUPANT LOAD</b>	<b>= 78 OCCUPANTS</b>
<b>REQUIRED EGRESS WIDTH</b>	<b>= 78 OCC. x 0.3" = 23.4"</b>
STAIRWAYS	= 78 OCC. x 0.2" = 15.6"
OTHER EGRESS COMPONENTS	= 78 OCC. x 0.2" = 15.6"
<b>PROVIDED EGRESS WIDTH</b>	<b>= 42" x 2 = 84"</b>
STAIRWAYS	= 34" x 2 = 68"
OTHER EGRESS COMPONENTS	= 34" x 2 = 68"

**OCCUPANCY LEGEND**

	ACCESSORY STORAGE / MAINTENANCE: 300 GROSS
	BUSINESS: 100 GROSS
	FITNESS: 50 GROSS
	RESIDENTIAL: 200 GROSS

Order Plans @ WWW.DILine.com