

© 2018 COLEMAN COMPANY, INC. DATE PLOTTED: 4/23/2018 8:17:53 AM BY: PAGES WORKING DRAWING PATH: C:\18-426\DWG\18-426-ESPC-18-2-18.dwg

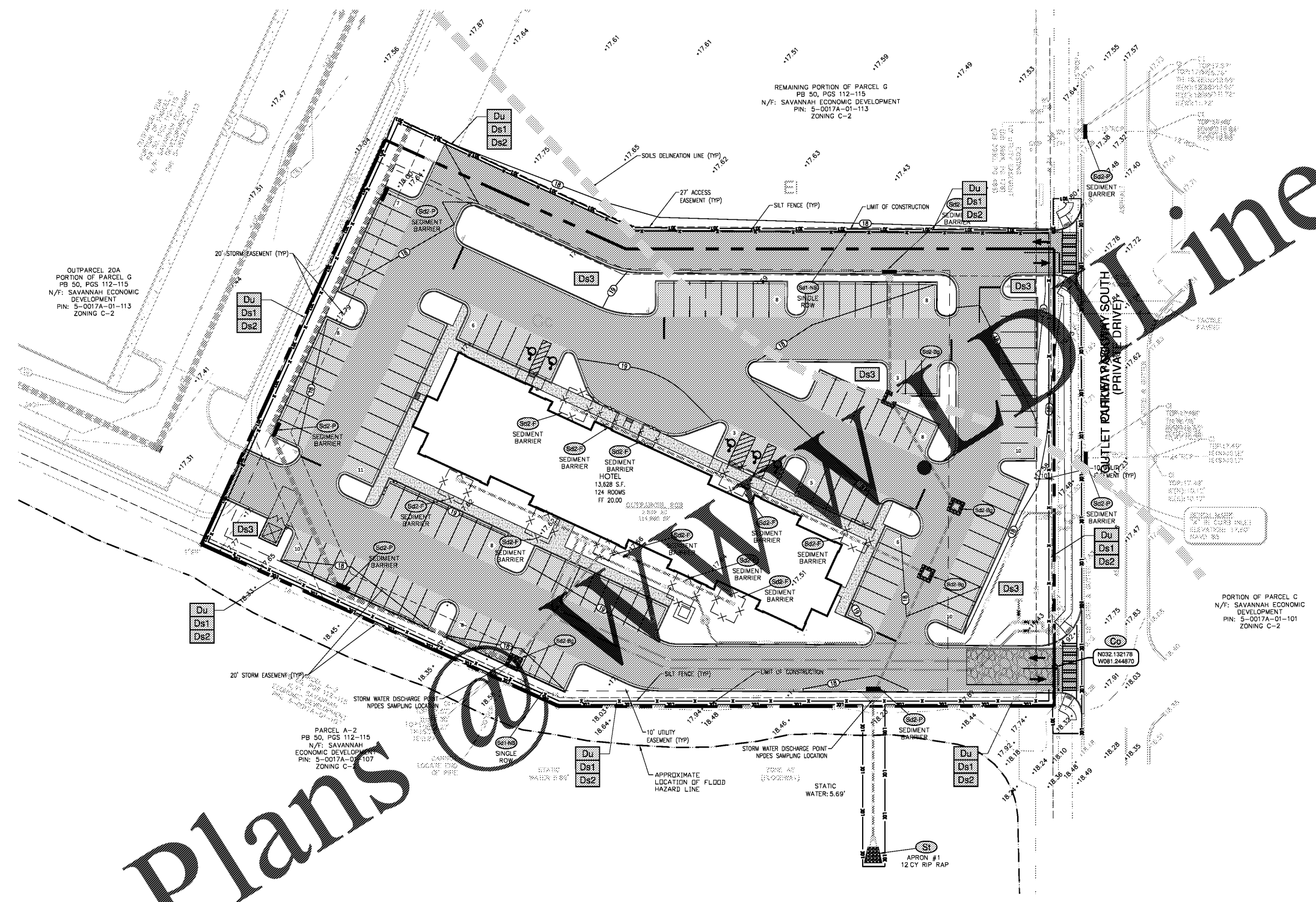

OUTPARCEL 20A
PORTION OF PARCEL G
PB 50, PGS 112-115
N/F: SAVANNAH ECONOMIC
DEVELOPMENT
PIN: 5-0017A-01-113
ZONING C-2

PARCEL A-2
PB 50, PGS 112-115
N/F: SAVANNAH
ECONOMIC DEVELOPMENT
PIN: 5-0017A-01-107
ZONING C-2

REMAINING PORTION OF PARCEL G
PB 50, PGS 112-115
N/F: SAVANNAH ECONOMIC DEVELOPMENT
PIN: 5-0017A-01-113
ZONING C-2

PORTION OF PARCEL C
N/F: SAVANNAH ECONOMIC
DEVELOPMENT
PIN: 5-0017A-01-101
ZONING C-2

SEQUENCE OF CONSTRUCTION

- INITIAL PHASE:**
1. MASS GRADE SITE TO FINAL ELEVATIONS.
 2. INSTALL UNDERGROUND UTILITIES INCLUDING WATER LINES, SANITARY SEWER AND STORM SYSTEMS.
 3. INSTALL INLET PROTECTION/SEDIMENT STORAGE AROUND SPECIFIED INLETS & SEDIMENT BASIN.
- FINAL PHASE:**
1. REMOVE SEDIMENT STORAGE AROUND SPECIFIED INLETS.
 2. INSTALL CURBING, SIDEWALKS, PAVEMENT SECTIONS, PAVEMENT INLET PROTECTIONS AND FINE GRADE SITE FOR LANDSCAPING.
 3. INSTALL LANDSCAPING AND STABILIZE ALL REMAINING DISTURBED AREAS.
 4. REMOVE ALL TEMPORARY EROSION CONTROL MEASURES AND STABILIZE DISTURBED AREAS ACCORDINGLY.

SEDIMENT STORAGE REQUIREMENTS

DISTURBED AREA (INITIAL): 2.88 AC
 REQUIRED STORAGE (INITIAL): 2.88 AC X 67 CY/AC = 191.86 CY = 5,180 CF
 STORAGE PROVIDED (INITIAL): 115 CY = 3,105 CF
 STORAGE PROVIDED: 384 CF @ 14 = 5,376 CF = REQUIRED STORAGE
 (INLET TRAPS, S&P)

5,376 CF > 5,180 CF; THEREFORE ADEQUATE STORAGE IS PROVIDED IN THE INITIAL PHASE.

DESIGN PROFESSIONAL'S CREDENTIALS:
 ENGINEER'S NAME (PRINTED): TRAVIS BURKE, PE
 GEORGIA PE NUMBER: 31215
 GSWCC LEVEL II CERTIFICATION NUMBER: 8134

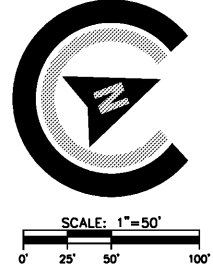

NRCS ORIGINAL SUBMITTAL: 8/23/2018
 NRCS SECOND SUBMITTAL: 10/4/2018



COLEMAN COMPANY
 ENGINEERS • SURVEYORS
 Savannah, Georgia | (912) 266-3841 | CCI-SAV.COM

NOT FOR CONSTRUCTION

REVISIONS:

CIVIL CONSTRUCTION PLANS FOR
EXTENDED STAY HOTEL
 LOCATED IN POOLER, GEORGIA
 PREPARED FOR TANGER OUTLET

JOB NUMBER: 18-426
 DATE: 8/23/18
 DRAWN BY: JWR
 CHECKED BY: JGB
 SCALE: AS NOTED

FINAL ES & PC

SHEET:
CE3.0