

© 2018 COLEMAN COMPANY, INC. DATE PLOTTED: 10/26/2018 10:56 AM BY: Darius Warner - DRAWING PATH: O:\18-426\DWG\18-426.dwg Project 8-16-18.dwg

# Order Plans

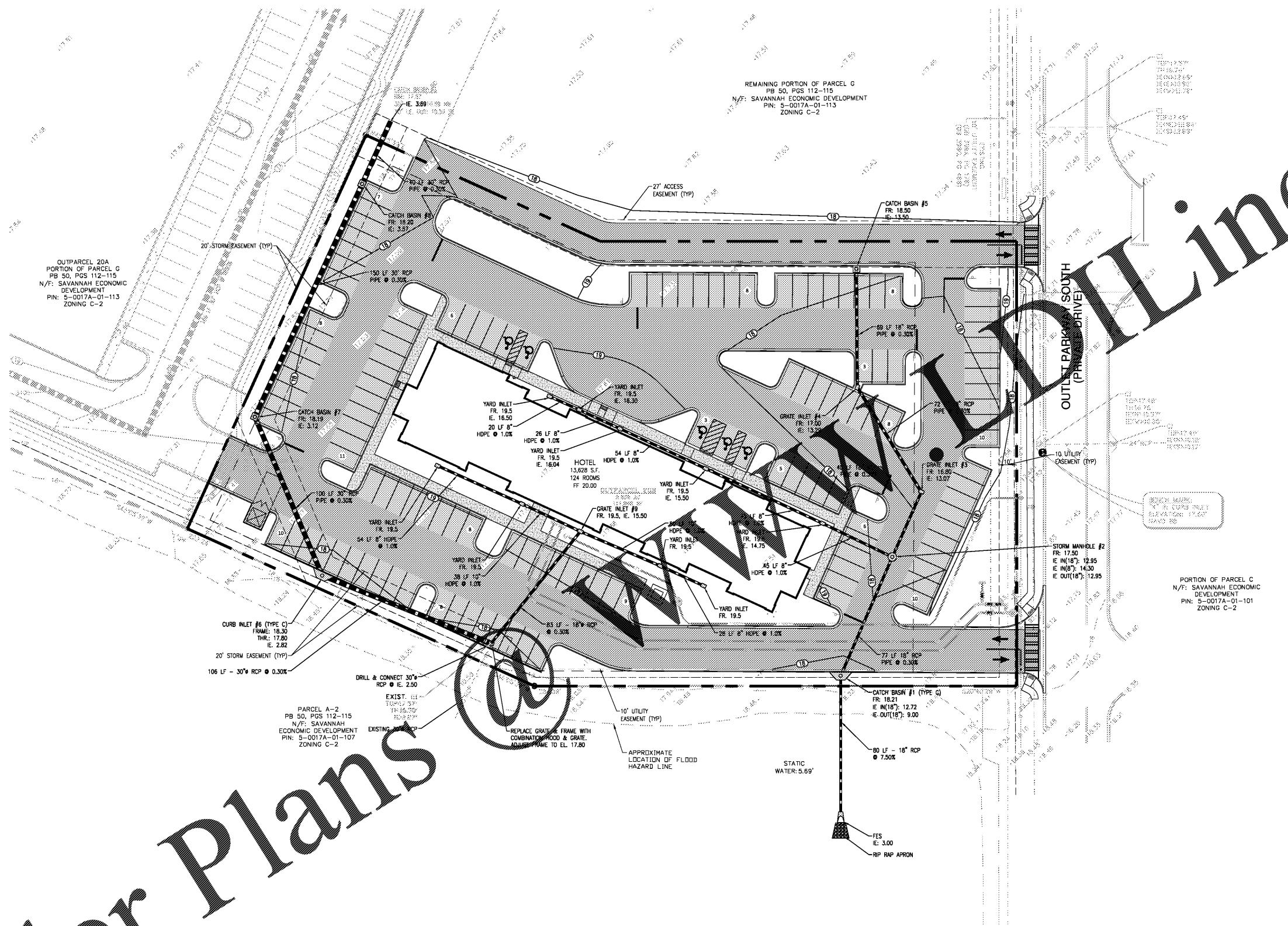

OUTPARCEL 20A  
PORTION OF PARCEL G  
PB 50, PGS 112-115  
N/F: SAVANNAH ECONOMIC  
DEVELOPMENT  
PIN: 5-0017A-01-113  
ZONING C-2

REMAINING PORTION OF PARCEL G  
PB 50, PGS 112-115  
N/F: SAVANNAH ECONOMIC DEVELOPMENT  
PIN: 5-0017A-01-113  
ZONING C-2

PARCEL A-2  
PB 50, PGS 112-115  
N/F: SAVANNAH  
ECONOMIC DEVELOPMENT  
PIN: 5-0017A-01-107  
ZONING C-2

PORTION OF PARCEL C  
N/F: SAVANNAH ECONOMIC  
DEVELOPMENT  
PIN: 5-0017A-01-101  
ZONING C-2

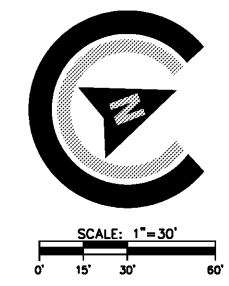

**811**  
Know what's below.  
Call before you dig.

**COLEMAN COMPANY**  
ENGINEERS • SURVEYORS  
Savannah, Georgia (912) 200-3041 | CCI-SAV.COM

**NOT FOR CONSTRUCTION**

REVISIONS:

CIVIL CONSTRUCTION PLANS FOR  
**EXTENDED STAY HOTEL**  
LOCATED IN POOLER, GEORGIA  
PREPARED FOR TANGER OUTLET

JOB NUMBER: 18-426  
DATE: 8/23/18  
DRAWN BY: JWR  
CHECKED BY: TGB  
SCALE: AS NOTED

DRAINAGE PLAN

SHEET:  
**C5.0**