

© 2018 COLEMAN COMPANY, INC. DATE PLOTTED: 10/26/2018 10:54 AM BY: Darius Warner DRAWING PATH: O:\18-426\DWG\18-426 Main Project & TC 18.dwg

Order Plans

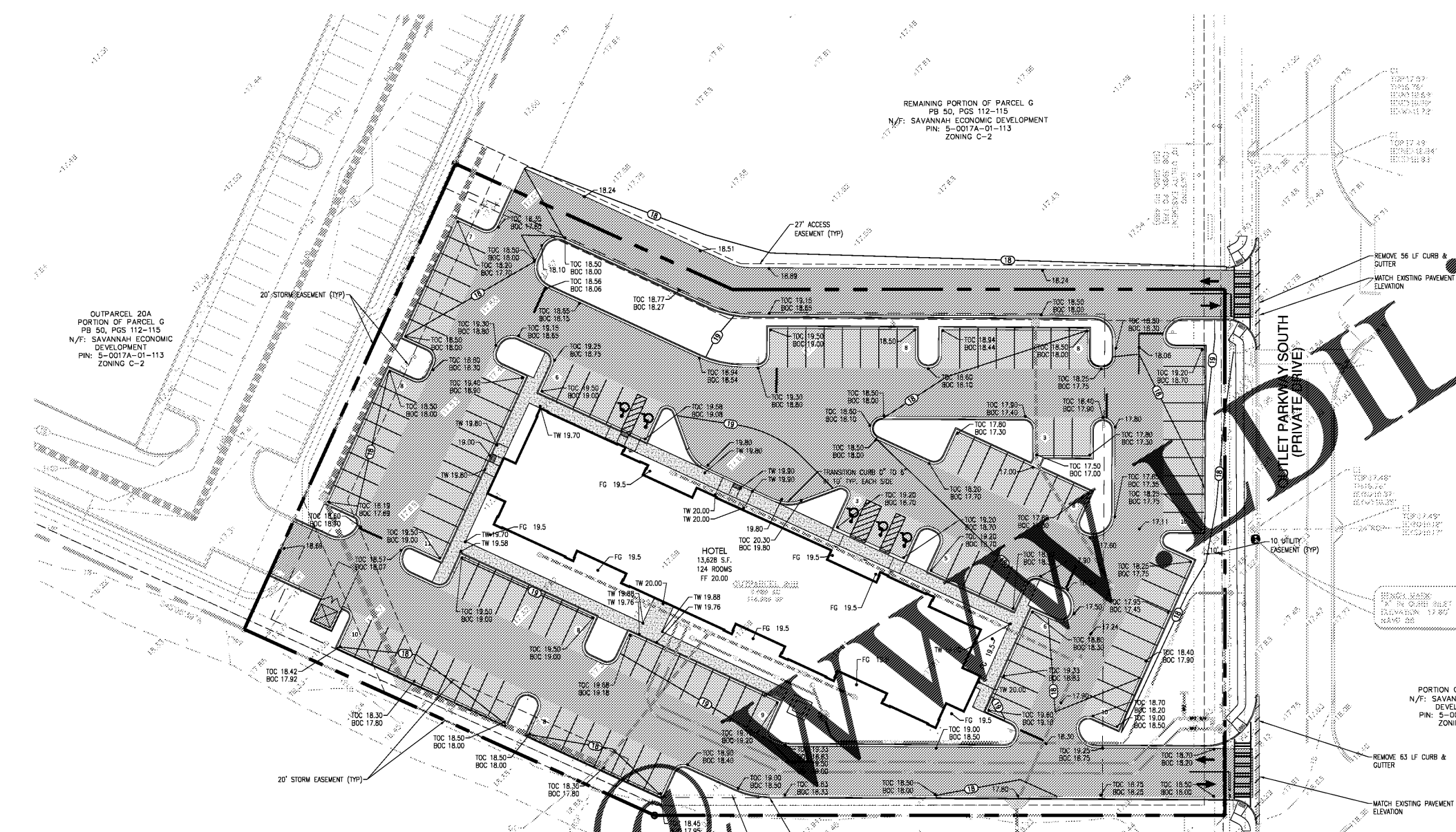

PAVEMENT SECTIONS

LIGHT DUTY:	6" GAB 2" 9.5mm OR 12.5mm SUPER PAVE
HEAVY DUTY:	8" GAB 2" 19mm SUPER PAVE 2" 9.5mm OR 12.5mm SUPER PAVE

COLEMAN COMPANY
ENGINEERS • SURVEYORS
Savannah, Georgia (912) 200-3041 | CCI-SAV.COM

NOT FOR CONSTRUCTION

REVISIONS:

CIVIL CONSTRUCTION PLANS FOR
EXTENDED STAY HOTEL
LOCATED IN POOLER, GEORGIA
PREPARED FOR TANGER OUTLET

JOB NUMBER:	18-426
DATE:	8/23/18
DRAWN BY:	JWR
CHECKED BY:	JGB
SCALE:	AS NOTED

PAVING & GRADING

SHEET:
C4.0

