

Order Plans @

WWW.IDLine.com

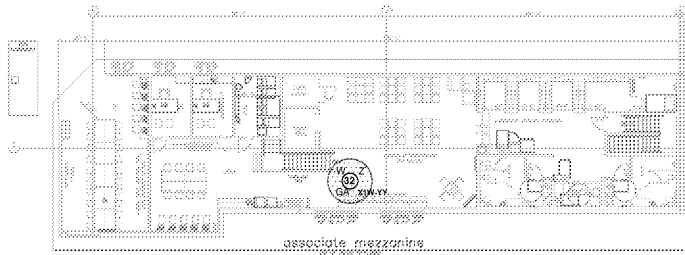
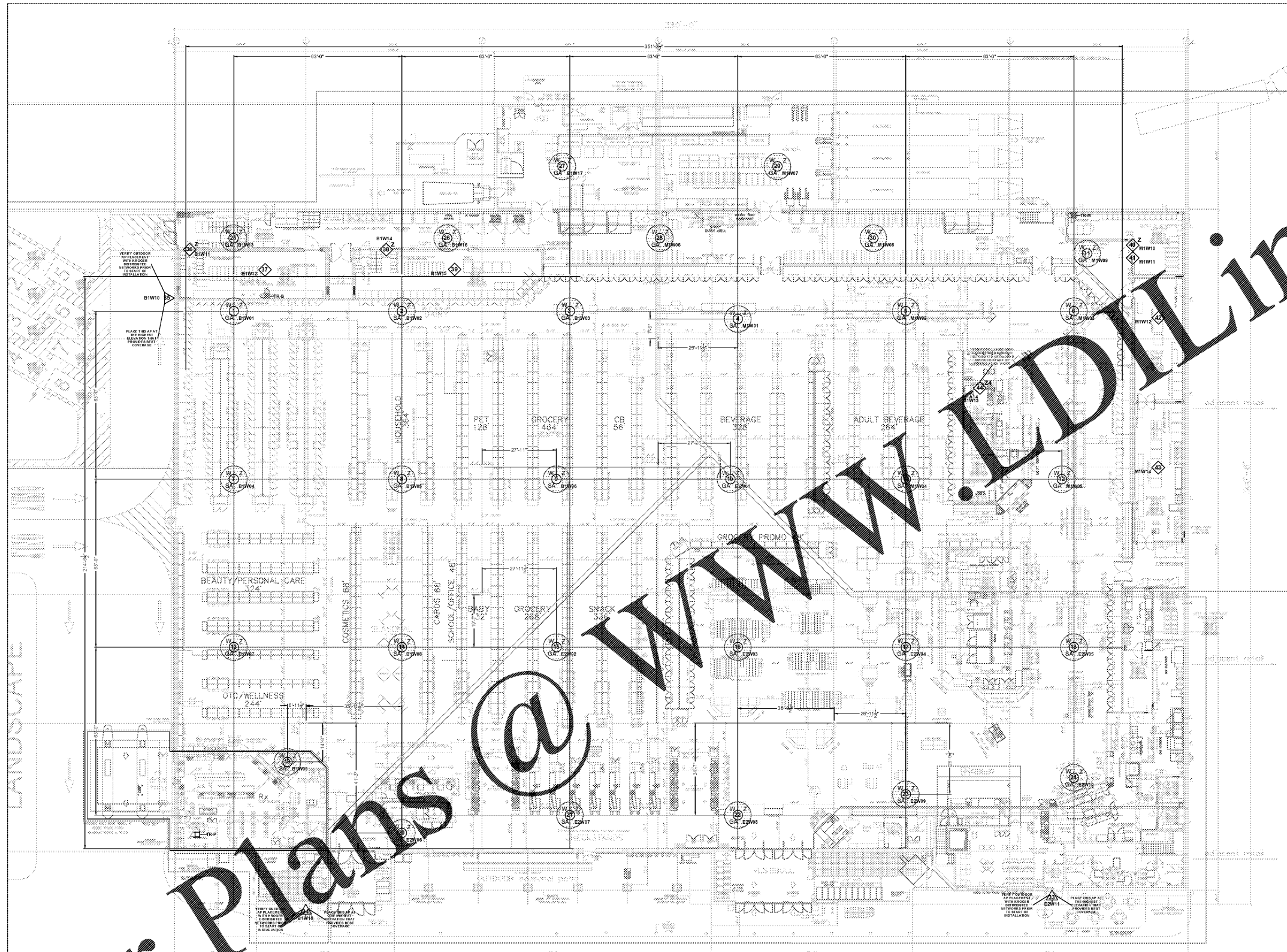

- ACCESS POINT LOCATIONS**
- ONE (1) CATEGORY 6, 4-PAIR UTP CABLE TERMINATED IN A SINGLE PORT BSCUT MOUNTED AT CEILING HEIGHT WITH A 20-FOOT SERVICE LOOP FOR 2M MOUNTING WIRELESS AP AT LOCATION. Z-BOX AT LOCATION. #REF SEQUENCE NUMBERING (GABA 8 FOR KROGER USE ONLY)
  - ◇ ONE (1) CATEGORY 6, 4-PAIR UTP CABLE MOUNTED AS REQUIRED FOR A FREEZER WIRELESS ACCESS POINT. SEE DETAIL ON SHEET T1.3
  - ◇-1 ONE (1) CATEGORY 6, 4-PAIR MOUNTED IN A SINGLE PORT BSCUT IN A 6"x6"x4" BOX INSIDE THE FREEZER/REF AREA
  - ◇-2 ONE (1) CATEGORY 6, 4-PAIR MOUNTED IN A 2-PORT BSCUT IN A 6"x6"x4" BOX INSIDE THE FREEZER/REF AREA. SEE DETAIL ON SHEET T1.3
  - △ ONE (1) CATEGORY 6, 4-PAIR UTP CABLE MOUNTED AS REQUIRED FOR AN OUTSIDE WIRELESS ACCESS POINT. SEE DETAIL ON SHEET T1.3

MID-ATLANTIC COMMOT  
INFRASTRUCTURE SOLUTIONS  
(NEW) ARTISAN  
PROJECT: (NEW) MERCURY BLVD  
LOCATION: HAMPTON, VA  
DATE: 11/1/2018

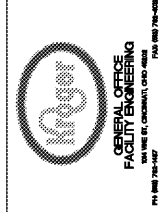

NEW STORE IFB  
R-543  
MERCURY BLVD.  
HAMPTON, VA.

DATE	11/1/2018
BY	SP/2018
NO.	104,824
REV.	0
DESCRIPTION	OVERALL STORE AP LOCATIONS
PROJECT	R-543
DESCRIPTION	T1.6.1