

KEYED NOTES	
PW08	FREEZE PROOF WALL HYDRANT TO BE MOUNTED 4'-0" ABOVE GRADE. PLUMBER TO PROVIDE A HOSE TO CONNECT WALL HYDRANT TO HOSE REEL. REFER TO ARCHITECTURAL PLANS FOR HOSE REEL LOCATION. REFER TO PSD-107 ON SHEET P-2.
PW10	BRANCH ISOLATION VALVES TO BE MOUNTED AT 10'0" A.F.F. UNLESS PHYSICALLY IMPOSSIBLE, IN WHICH CASE MOUNT AS CLOSE TO 10'0" A.F.F. AS POSSIBLE. MAKE ACCESSIBLE AND HIDDEN FROM PUBLIC VIEW.
PW12	ROUTE HW PIPING ALONG THE TOP OF CASES TO HH-02.
PW21	3" DOMESTIC WATER SERVICE. SEE CIVIL SITE UTILITY PLAN FOR CONTINUATION AND METER FIT.
PW24	WATER PIPING UP THROUGH ROOF TO SERVE ROOF HYDRANT. REFER TO SHEET P-13A FOR CONTINUATION.
PW25	8" FIRE SERVICE ENTRANCE.

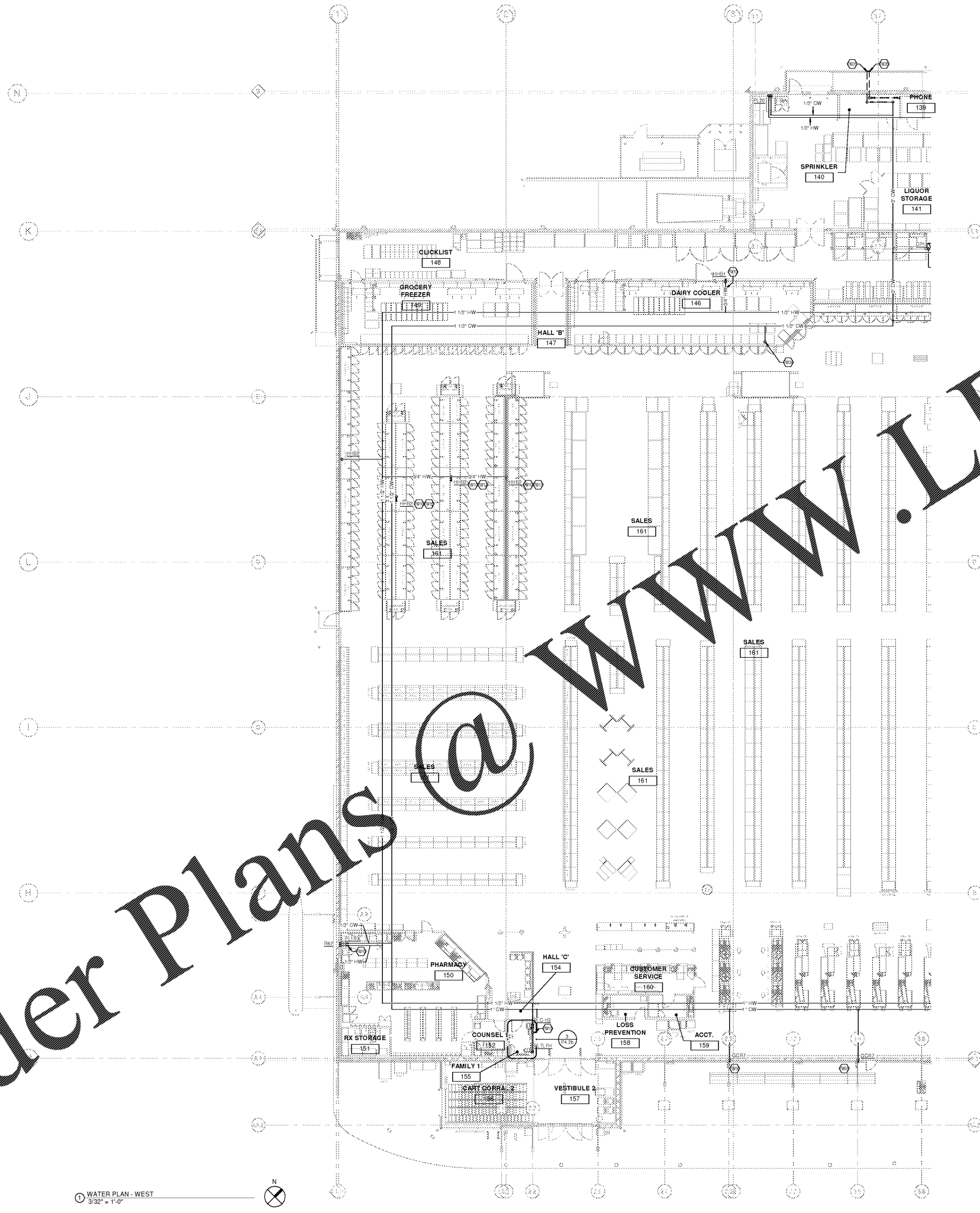

CINCINNATI 600 Vine Street, Suite 200, Cincinnati, OH 45202
 DENVER 1475 Broadway, Suite 1000, Denver, CO 80202
 SEATTLE 805 3rd Avenue, Suite 2000, Seattle, WA 98104

CR
 architecture + design

creating extraordinary places
 www.cr-architects.com
 800-460-6849

CONSULTANTS

MECHANICAL/ELECTRICAL ENGINEERS
 WWW.KHENGERS.COM
 LEWINGTON, KENTUCKY
 LOUISVILLE, KENTUCKY
 NEW YORK, NEW YORK

KEKLH
 ENGINEERS

150 ALEXANDRIA PARK SUITE 11
 FT. THOMAS, KENTUCKY 40310
 938-442-8286 FAX

OWNER

DATE	ISSUE
10/25/18	5% OWNER REVIEW
11/01/18	10% BOPERMAT

DATE	REVISION

PROJECT TITLE

KROGER STORE R543

MERCURY BLVD.
HAMPTON, VA

COMMISSIONING: 5/17/15
 ISSUE DATE: 10/23/2018
 SHEET TITLE: WATER PLAN - WEST

SHEET NO.

P1.2a

©2018 Architectural Record, Inc.

OWNERSHIP OF INSTRUMENTS OF SERVICE
 All rights, title, and interest in this document and the instruments prepared by the Consultant are retained by the Consultant. The Consultant shall retain all rights in this document, including without limitation, the right to use the information contained herein for the Consultant's own business and for other projects.

11/02/18 2:30:53 PM

WATER PLAN - WEST
 3/32" = 1'-0"

2" REFERENCE LINE