

SMOKE DETECTOR FLUSH MOUNTING DETAIL
SCALE: NO SCALE

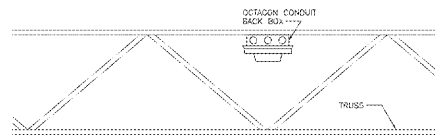

SMOKE DETECTOR MOUNTING DETAIL
SCALE: NO SCALE

THE WRAPS MUST BE UL LISTED, APPROVED AND PLENUM RATED WHEN APPLICABLE.
CABLEING SHALL BE SEPARATED A MINIMUM OF 24" FROM ANY OTHER CONDUCTORS.

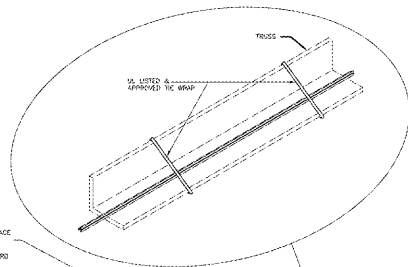

WIRE RUN DETAIL
SCALE: NO SCALE

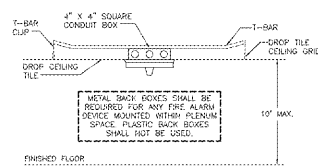

CEILING HORN/STROBE FLUSH MOUNTING DETAIL
SCALE: NO SCALE

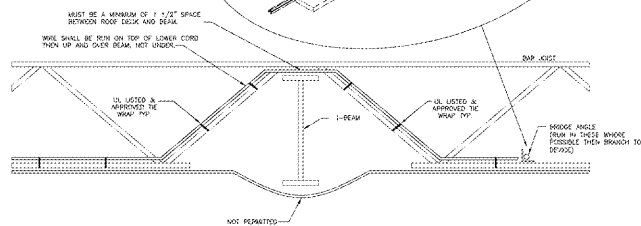

ALL STROBES AND HORN/STROBES SHALL BE CENTERED OVER THEIR RESPECTIVE AISLES. THE ALARM CONTRACTOR SHALL PROVIDE AND INSTALL UNDERLATH IF NECESSARY TO ACHIEVE THIS PURPOSE.



CEILING HORN/STROBE MOUNTING DETAIL
SCALE: NO SCALE

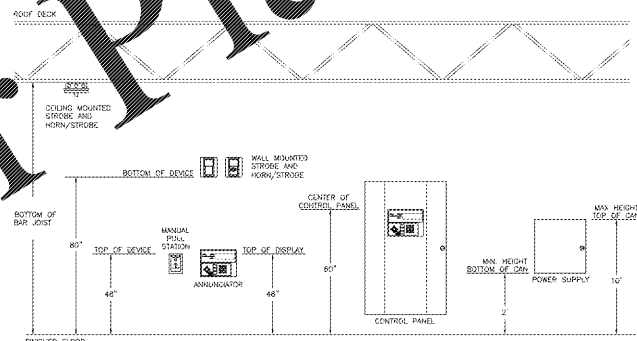

TYPICAL DEVICE MOUNTING HEIGHT
SCALE: NO SCALE

telgian

CONSULTANT:
Tarron Gable
OWNER:
B&B Merchants
QUALITY CONTROL:
Brian Scudder

CONSULTANTS

OWNER



ISSUE/REVISION

10/05/16
80% OWNER REVIEW
11/04/16
100% PERMIT-BID
01/04/17
BULLETIN #1

PROJECT TITLE
KROGER STORE #543

Hampton, VA

COMMISSION NO.
ISSUE DATE 08/11/16
SHEET TITLE

FIRE ALARM
DETAILS

SHEET NO.

FA4.0

Order Plans @ www.LDILine.com