

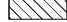





GENERAL NOTES

1. AREAS OF STAIN PROTECTION ARE SHOWN FOR ESTIMATING PURPOSES ONLY. ACTUAL LOCATIONS TO BE DETERMINED BY KROGER PM AND MECHANICAL PLANS.

CONCRETE POLISHING

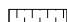
-  SALT PROTECTION TREATMENT - 1,786 S.F.
-  STANDARD CONCRETE POLISHING - 42,708 S.F.
-  MODIFIED CONCRETE POLISHING - 3,184 S.F.
-  STAIN PROTECTION TREATMENT - 5,818 S.F.
-  SLIP RESISTANT TREATMENT - 1,754 S.F.
-  HAND GRINDING - 1824 L.F.

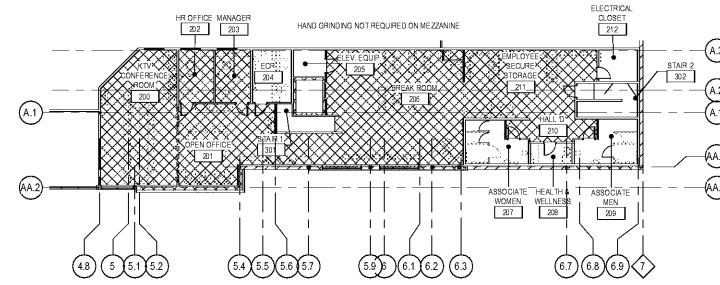

2 MEZZANINE CONCRETE POLISHING PLAN
SCALE: 1/16" = 1'-0"

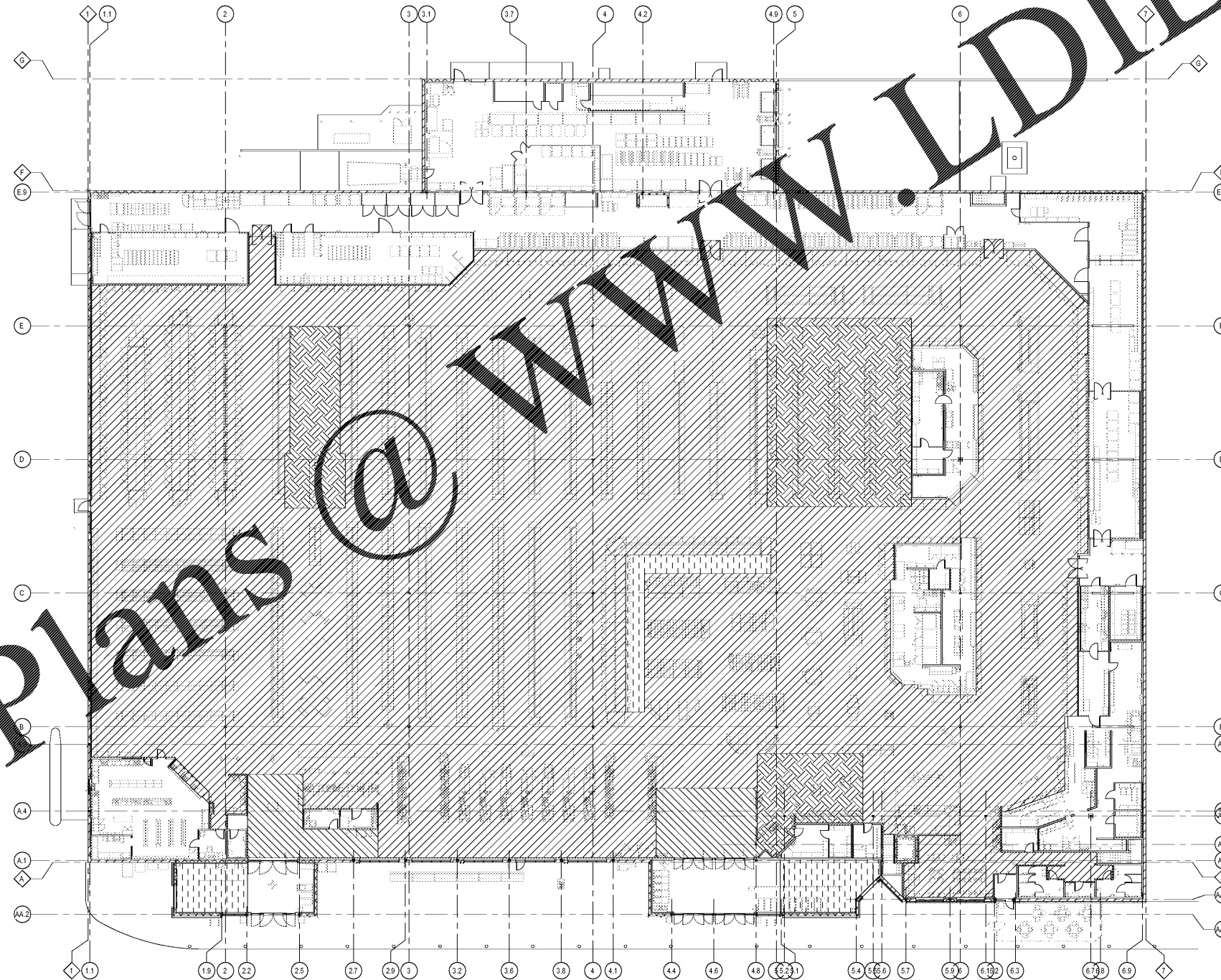

1 CONCRETE POLISHING PLAN
SCALE: 1/16" = 1'-0"

EXECUTED BY: GB
REVIEWED BY: AF

100 West River Street, Suite 200, Portland, ME 04101
CINCINNATI: 800 West River Street, Suite 200, Cincinnati, OH 45202
DENVER: 1700 North Lincoln Street, Suite 100, Denver, CO 80202
DALLAS: 200 West Ross Avenue, Suite 200, Dallas, TX 75201
EAST RICHMOND: 10000 East 14th Avenue, Suite 100, East Richmond, VA 23061
HOUSTON: 10000 West Loop South, Suite 100, Houston, TX 77042
LOS ANGELES: 1000 West 10th Street, Suite 100, Los Angeles, CA 90015
MEMPHIS: 1000 West 10th Street, Suite 100, Memphis, TN 38103
MIAMI: 1000 West 10th Street, Suite 100, Miami, FL 33133
MINNEAPOLIS: 1000 West 10th Street, Suite 100, Minneapolis, MN 55401
NEW YORK: 1000 West 10th Street, Suite 100, New York, NY 10001
PHOENIX: 1000 West 10th Street, Suite 100, Phoenix, AZ 85001
SAN ANTONIO: 1000 West 10th Street, Suite 100, San Antonio, TX 78201
SEATTLE: 1000 West 10th Street, Suite 100, Seattle, WA 98101

CR
architecture + design

creating extraordinary places
www.cr-architects.com
800-499-4949

CONSULTANTS

OWNER



DATE	ISSUE
10/28/18	95% OWNER REVIEW
11/01/18	100% BID PERMIT

DATE	REVISION

PROJECT TITLE
KROGER STORE R543

1050 W. Mercury Blvd.
Hampton, VA 23066

COMMISSION NO: 518344
ISSUE DATE: 11/01/18

SHEET TITLE
CONCRETE POLISHING PLANS

SHEET NO.
A1.5

Order Plans @

THIS DOCUMENT IS THE PROPERTY OF CR ARCHITECTS. IT IS TO BE USED ONLY FOR THE PROJECT AND SITE SPECIFICALLY IDENTIFIED HEREIN. IT IS NOT TO BE REPRODUCED, COPIED, OR DISTRIBUTED IN ANY MANNER WITHOUT THE WRITTEN PERMISSION OF CR ARCHITECTS, INC. 11/01/18 4:52 PM