

Order Plans @

Symbol	Qty	Label	Arrangement	LF	Description	Len. Ratio	Total Watts	Len. Loading
1	4	LSK61	SINGLE	0.912	SLK61-AB-09-LED-VOLT-147-02	31.6	1280	50897
2	3	LSK61	SINGLE	0.912	SLK61-AB-08-LED-VOLT-147-02	31.6	945	50875
3	1	LSK69	3 6 90°	0.912	SLK69-AB-08-LED-VOLT-147-02	31.6	630	10873
4	3	LSK61	SINGLE	0.912	SLK61-AB-06-LED-VOLT-147-02	31.6	1875	36127
5	14	LSK101	SINGLE	0.912	SLK101-AB-10-LED-VOLT-147-02	31.6	2732	53499
6	1	LSK92	BACK-BACK	0.912	273 2 SLK92-AB-09-LED-VOLT-147-02	470	3700	48200
7	23	LSK92	SINGLE	0.912	273 2 SLK92-AB-09-LED-VOLT-147-02	109.5	2530	16699
8	14	LSK92	SINGLE	0.912	273 2 SLK92-AB-09-LED-VOLT-147-02	109.5	1265	16982
9	2	LSK92	SINGLE	0.912	273 2 SLK92-AB-09-LED-VOLT-147-02	109.5	219.0	10785
10	6	LSK92	SINGLE	0.912	273 2 SLK92-AB-09-LED-VOLT-147-02	31.6	1260	32307
11	16	ACN	SINGLE	0.880	ACN102AK3X1X	186	1180	8702
12	35	RP	SINGLE	0.884	874-05-06-1.8_039-VOLT-ALP	34.5	955.5	1259

Label	CalcType	Units	Avg	Max	Min	Avg/Min	Max/Min
COLLECTOR GRADE	ILLUMINANCE	Fc	1.18	6.1	0.0	N.A.	N.A.
BUILDING PERM & WDR	ILLUMINANCE	Fc	2.99	7.7	1.0	2.99	7.70
CLAYC BLST	ILLUMINANCE	Fc	3.36	4.0	2.0	1.68	1.84
ENTRANCE #1	ILLUMINANCE	Fc	3.94	4.0	1.6	1.79	3.00
ENTRANCE #2	ILLUMINANCE	Fc	3.17	4.0	1.8	2.11	3.00
ENTRANCE #3	ILLUMINANCE	Fc	2.38	4.0	1.7	1.52	2.50
TRUCKER PARKING	ILLUMINANCE	Fc	3.28	7.3	1.9	1.73	3.84
WALK WAY	ILLUMINANCE	Fc	4.09	6.1	1.8	2.27	3.39
PARKING AREA #1	ILLUMINANCE	Fc	3.30	5.2	1.0	1.83	2.89
PARKING AREA #2	ILLUMINANCE	Fc	3.29	4.8	2.0	1.64	2.40

Project manager to specify fixture voltage for each fixture type

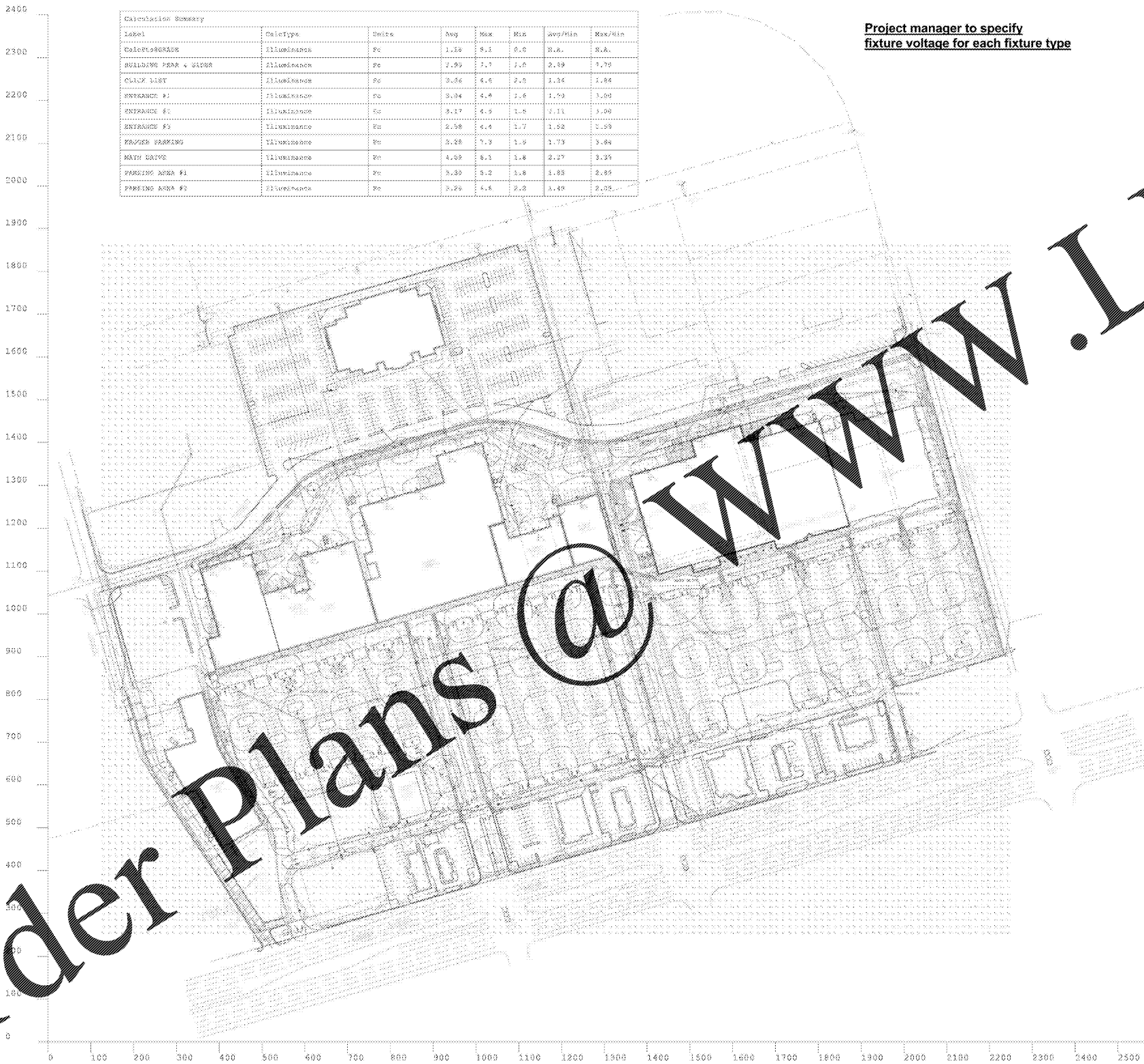

Symbol	Qty	Label	Arrangement	LF	Description	Len. Ratio	Total Watts	Len. Loading
1	4	LSK61	SINGLE	0.912	SLK61-AB-09-LED-VOLT-147-02	31.6	1280	50897
2	3	LSK61	SINGLE	0.912	SLK61-AB-08-LED-VOLT-147-02	31.6	945	50875
3	1	LSK69	3 6 90°	0.912	SLK69-AB-08-LED-VOLT-147-02	31.6	630	10873
4	3	LSK61	SINGLE	0.912	SLK61-AB-06-LED-VOLT-147-02	31.6	1875	36127
5	14	LSK101	SINGLE	0.912	SLK101-AB-10-LED-VOLT-147-02	31.6	2732	53499
6	1	LSK92	BACK-BACK	0.912	273 2 SLK92-AB-09-LED-VOLT-147-02	470	3700	48200
7	23	LSK92	SINGLE	0.912	273 2 SLK92-AB-09-LED-VOLT-147-02	109.5	2530	16699
8	14	LSK92	SINGLE	0.912	273 2 SLK92-AB-09-LED-VOLT-147-02	109.5	1265	16982
9	2	LSK92	SINGLE	0.912	273 2 SLK92-AB-09-LED-VOLT-147-02	109.5	219.0	10785
10	6	LSK92	SINGLE	0.912	273 2 SLK92-AB-09-LED-VOLT-147-02	31.6	1260	32307
11	16	ACN	SINGLE	0.880	ACN102AK3X1X	186	1180	8702
12	35	RP	SINGLE	0.884	874-05-06-1.8_039-VOLT-ALP	34.5	955.5	1259

Symbol	Qty	Label	Arrangement	LF	Description	Len. Ratio	Total Watts	Len. Loading
1	4	LSK61	SINGLE	0.912	SLK61-AB-09-LED-VOLT-147-02	31.6	1280	50897
2	3	LSK61	SINGLE	0.912	SLK61-AB-08-LED-VOLT-147-02	31.6	945	50875
3	1	LSK69	3 6 90°	0.912	SLK69-AB-08-LED-VOLT-147-02	31.6	630	10873
4	3	LSK61	SINGLE	0.912	SLK61-AB-06-LED-VOLT-147-02	31.6	1875	36127
5	14	LSK101	SINGLE	0.912	SLK101-AB-10-LED-VOLT-147-02	31.6	2732	53499
6	1	LSK92	BACK-BACK	0.912	273 2 SLK92-AB-09-LED-VOLT-147-02	470	3700	48200
7	23	LSK92	SINGLE	0.912	273 2 SLK92-AB-09-LED-VOLT-147-02	109.5	2530	16699
8	14	LSK92	SINGLE	0.912	273 2 SLK92-AB-09-LED-VOLT-147-02	109.5	1265	16982
9	2	LSK92	SINGLE	0.912	273 2 SLK92-AB-09-LED-VOLT-147-02	109.5	219.0	10785
10	6	LSK92	SINGLE	0.912	273 2 SLK92-AB-09-LED-VOLT-147-02	31.6	1260	32307
11	16	ACN	SINGLE	0.880	ACN102AK3X1X	186	1180	8702
12	35	RP	SINGLE	0.884	874-05-06-1.8_039-VOLT-ALP	34.5	955.5	1259

NOTE: DECORATIVE ACORN DVP FIXTURE TO BE DESIGNED BY DVP AND SUBJECT TO APPROVAL BY THE COMMUNITY DEVELOPMENT DIRECTOR.

Eaton
 Applications Engineering
 1121 Highway 74 South
 Peachtree City, GA 30269
 Tel no: 770-486-4533
 Fax no: 770-486-4599
 e-mail: lightingapplications@eaton.com

Eaton
 www.LDILine.com

Project Name: **KROGER R543 - HAMPTON, VA**
 Client: **WENDY NORMAN - EATON**

Drawn By: **EL**
 Date: **10/7/2016**
 Project No: **1600901E.AGI**

C-700