

1. PLAN SHALL BE USED IN CONJUNCTION WITH THE CITY OF HAMPTON STANDARD SPECIFICATIONS FOR CONSTRUCTION, LATEST EDITION, AND THE CITY OF HAMPTON STANDARD SPECIFICATIONS FOR SANITARY SEWER, LATEST EDITION.

NOW OR FORMERLY
 PLAZA ASSOCIATES
 PARCEL TEN
 LSRN #7001562
 D.B. 907, PG. 476

UTILITY PLAN LINE LEGEND	
	PROPOSED WATER LINE
	EXISTING WATER LINE
	PROPOSED SANITARY SEWER
	EXISTING SANITARY SEWER
	PROPOSED STORM SEWER
	EXISTING STORM SEWER
	PROPOSED CONTOUR
	PROPOSED RETAINING WALL
	PROPOSED CURB & GUTTER
	PROPOSED FENCE
	PROPOSED RIGHT OF WAY
	SHEET MATCH LINE
	EXISTING TELEVISION CABLE
	EXISTING GAS LINE
	EXISTING TELEPHONE LINE
	EXISTING OVERHEAD POWER
	EXISTING UNDERGROUND POWER
	PROPOSED BUILDING
	SITE BOUNDARY LINE
	ADJACENT PROPERTY LINE
	PHASING DIVISION LINE
	LAND LOT LINE
	INTERIOR PROPERTY LINE

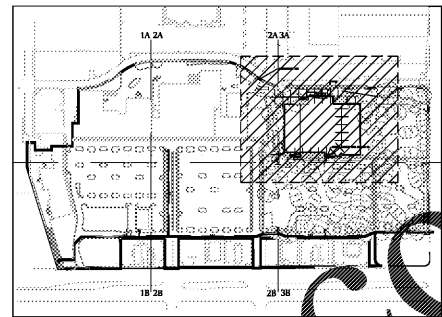

SHEET LEGEND

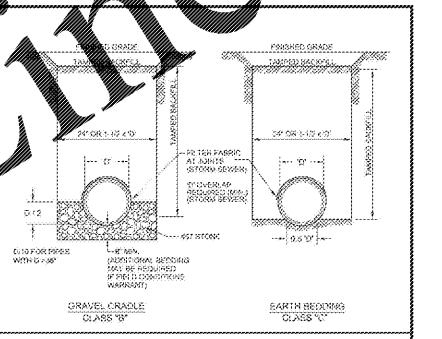

NOTES:

STORM SEWER

- PIPE IS TO BE DUCTILE IRON C-76 OR 84 R/L WHERE SUBJECT TO TRAFFIC. CLAYS & MAY BE USED OTHERWISE.
- JOINTS ARE TO BE TONGUE AND GROOVE WITH RUBBER COMPRESSION JOINTS OR BUTYL-RUBBER SIMILAR TO BUTYL-FITL OR OTHER APPROVED EQUAL COMPLYING TO FEDERAL SPEC. 8-1070A.
- PIPE WITH LEAK INDEX IS NOT ACCEPTABLE.

SANITARY SEWER:

- PIPE IS TO BE 60R OR 60R-20 PIPE OR 60R-20 PIPE WITH MECHANICAL OR PUSH ON JOINTS. LATERALS ARE TO BE 60R-20 OR DUCTILE IRON.
- JOINTS WILL BE MADE IN ACCORDANCE WITH MANUFACTURER'S RECOMMENDATIONS.

GENERAL:

- CLASS 'B' BEDDING IS REQUIRED UNLESS ALL PIPES AND JOINTS OTHERWISE DIRECTED BY THE DIRECTOR OF PUBLIC WORKS OR OTHERWISE.
- BACKFILL IS TO BE IN ACCORDANCE WITH HAMPTON STANDARD SPEC. 8-1070A.
- TRANCH IS TO BE PAISE OF WATER PRIOR TO THE INSTALLATION OF ANY PIPE.

October 2, 1923
 CITY OF HAMPTON, VA. - DESIGN & CONSTRUCTION STANDARDS
 Revised June 28, 2012

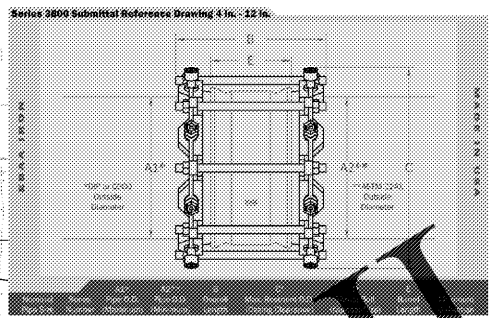

PIPE CONNECTION DETAIL

UTILITY MATERIAL NOTES

FOR DUCTILE IRON PIPE, USE SPECIAL CLASS 51 MINIMUM WALL THICKNESS. FLANGED JOINTS, IF USED, SHALL BE CLASS 125 PER ANSI B16.1. STANDARD FITTINGS SHALL BE IN ACCORDANCE WITH AWWA C110 OF AWWA C153.

UTILITY NOTES

- CONTACT MISS UTILITY AT 1-800-552-7001 A MINIMUM OF 72 HOURS PRIOR TO THE START OF CONSTRUCTION.
- CONTACT WASTEWATER OPERATIONS MANAGER, BARRY DOBBINS AT 757-726-2944, A MINIMUM OF TWO WORKING DAYS PRIOR TO EXCAVATION OF , OR IN THE VICINITY OF, CITY OF HAMPTON SEWER MAINS. MISS UTILITY CALLS DO NOT FULFILL THIS REQUIREMENT.
- ALL TESTING OF PUBLIC INFRASTRUCTURE SHALL BE IN ACCORDANCE WITH THE HAMPTON ROADS PLANNING DISTRICT COMMISSION REGIONAL CONSTRUCTION STANDARDS, LATEST EDITION.
- OWNER SHALL COORDINATE WITH HRSD TO ABANDON EXISTING SEWER EASEMENT

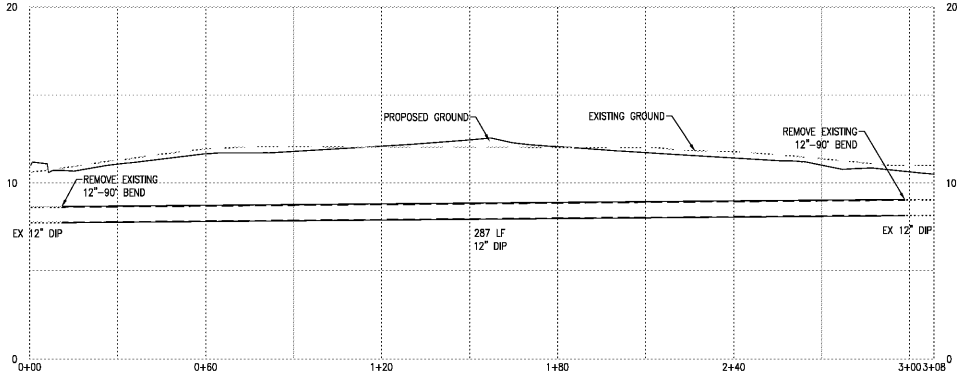

SANITARY SEWER PROFILE FORCEMAIN

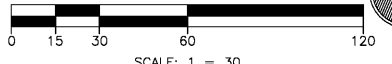

REVISIONS

DATE	REVISION	BY
07.05.16	CITY COMMENTS	
07.18.16	CITY COMMENTS	
10.04.16	CITY COMMENTS	
10.13.16	CITY COMMENTS	

BEFORE YOU DIG, CALL MISS UTILITY 1-800-552-7001

24 HR EMERGENCY CONTACT
 MARK SENN
 MARK.SENN@SOUTHEASTERNCOMPANY.COM

2014169u-2.dwg 06.28.16

SANITARY SEWER FORCEMAIN RELOCATION PLAN

SHEET C-320

SP 2016-0020

PAULSON MITCHELL
 INCORPORATED
 200 HILL STREET
 ROSWELL, GEORGIA 30075
 VOICE 770.650.7685
 FAX 770.650.7684
 www.paulsonmitchell.com

PROJECT:
RIVERPOINTE PLAZA PHASE 2
 1048 & 1050 W. MERCURY BLVD.
 HAMPTON, VIRGINIA 23666

FOR:
KB RIVERDALE, LLC
 2743 PERIMETER PARKWAY
 BLDG. 100, SUITE 370
 AUGUSTA, GA 30909
 PH. (706) 854-6714

Order Plans @

SANITARY SEWER FORCEMAIN RELOCATION PLAN