

13/24/2016 10:48:18 AM C:\pwworking\paulsonmitchell.com\Projects\2016\160821\160821.dwg, AND ALL FILES IN THIS PROJECT, TOGETHER MAKE UP ONE (1) SET OF DRAWINGS.

NOTE:
 1. STRUCTURES FOR PROPOSED SANITARY SEWER SYSTEM WILL BE INSTALLED WITH THEIR DESIGNATED COVER AS FOUND ON SHEET C-631, DESIGNATED AS SEWER MANHOLE FRAME AND COVER.
 2. THE WATER SYSTEM IMPROVEMENTS ARE TO BE INSTALLED IN ACCORDANCE WITH THE MOST RECENTLY APPROVED EDITION OF THE "NEWPORT NEWS WATERWORKS DISTRIBUTION STANDARDS FOR MATERIAL AND CONSTRUCTION". THE DISTRIBUTION STANDARDS ARE AVAILABLE ONLINE AT www.nva.gov/waterworks

UTILITY PLAN LINE LEGEND	
PROPOSED WATER LINE	EXISTING TELEVISION CABLE
EXISTING WATER LINE	EXISTING GAS LINE
EXISTING SANITARY SEWER	EXISTING TELEPHONE LINE
PROPOSED SANITARY SEWER	EXISTING OVERHEAD POWER
EXISTING FIBER OPTIC LINE	EXISTING UNDERGROUND POWER
PROPOSED CONTOURS	PROPOSED STORM SEWER
PROPOSED RETAINING WALL	PROPOSED BUILDING
PROPOSED CURB & GUTTER	SITE BOUNDARY LINE
PROPOSED FENCE	ADJACENT PROPERTY LINE
PROPOSED RIGHT OF WAY	PHASING DIVISION LINE
SHEET MATCH LINE	LAND LOT LINE
	INTERIOR PROPERTY LINE

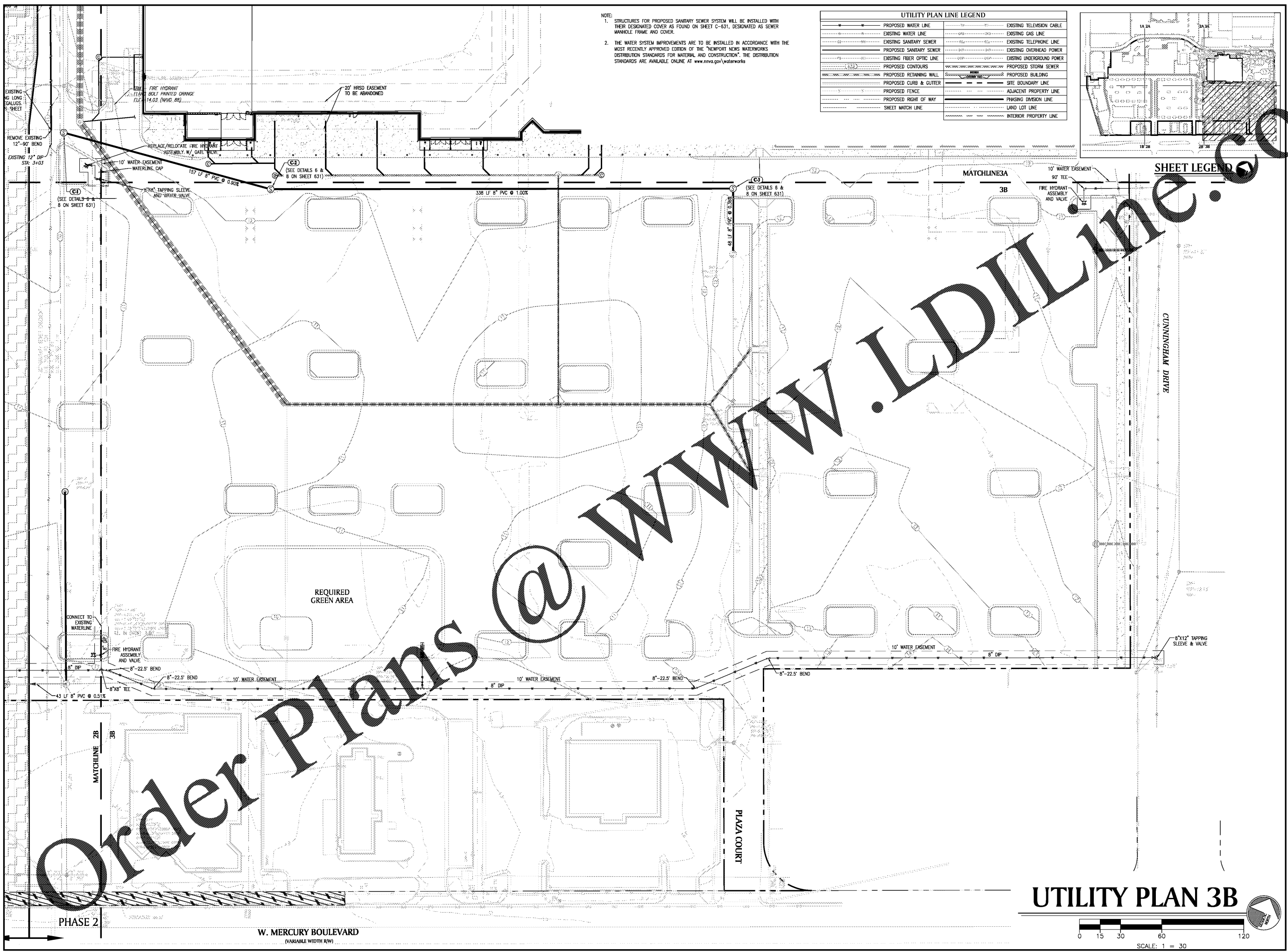
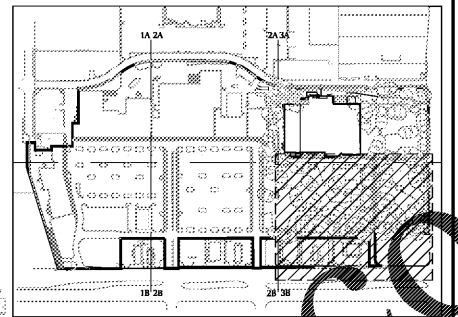

SHEET LEGEND

Order Plans @ www.ldilinc.com

PAULSON MITCHELL
 INCORPORATED
 LAND PLANNERS
 ENGINEERS • SURVEYORS
 ARCHITECTS
 200 HILL STREET
 SUITE 200
 ROSWELL, GEORGIA 30075
 VOICE 770.650.7685
 FAX 770.650.7684
www.paulsonmitchell.com

PROJECT:
RIVERPOINTE PLAZA PHASE 2
 1048 & 1050 W. MERCURY BLVD.
 HAMPTON, VIRGINIA 23666

FOR:
KB RIVERDALE, LLC
 2743 PERIMETER PARKWAY
 BLDG. 100, SUITE 370
 AUGUSTA, GA 30909
 PH. (706) 854-6714

REVISIONS	
▲ 08.19.16	CITY COMMENTS
▲ 10.04.16	CITY COMMENTS
▲ 10.13.16	CITY COMMENTS
▲ 11.01.16	CLIENT COMMENTS

va811.com
 Dig With **GO**
 BEFORE YOU DIG, CALL MISS UTILITY 1-800-552-7001
24 HR EMERGENCY CONTACT
MARK SENN
 MARK.SENN@SOUTHEASTERNCOMPANY.COM

2014169u-2.dwg 06.28.16

UTILITY PLAN 3B

UTILITY PLAN 3B

