

DATE: 08/15/2016 10:58:43 AM DRAWN BY: JAMES W. MITCHELL, PE, LICENSE NO. 28643 PROJECT NO.: 16-0020 SITE PLAN 3A

NOTE:  
 1. TRASH RECEPTACLE, BIKE RACKS, AND BENCH LOCATION, TYPE, AND MATERIAL SHALL BE AS SPECIFIED BY THE OWNER'S ARCHITECT. TRASH RECEPTACLE SHALL NOT BLOCK A DOOR, CURB RAMP, FIRE EXIT, ETC.

SITE LINE LEGEND	
	EXISTING BUILDING
	PROPOSED CURB & GUTTER
	PROPOSED FENCE
	PROPOSED RETAINING WALL
	SITE BOUNDARY LINE
	PROPOSED RIGHT OF WAY
	ADJACENT PROPERTY LINE
	PHASING DIVISION LINE
	BUILDING SETBACK
	LANDSCAPE BUFFER
	SHEET MATCH LINE
	EXISTING CURB & GUTTER
	EXISTING FENCE
	INTERIOR PROPERTY LINE

REQUIRED GREEN SPACE	
	GRASSED AREA

PAVEMENT SPECIFICATIONS:	
STANDARD DUTY:	
2"	ASPHALT CONCRETE TYPE SM-9.5
8"	GRADED AGGREGATE BASE
HEAVY DUTY:	
1.5"	ASPHALT CONCRETE TYPE SM-9.5
3"	ASPHALT CONCRETE TYPE BM-25
8"	GRADED AGGREGATE BASE
LIGHT DUTY CONCRETE:	
6"	4000 PSI CONCRETE
4"	GRADED AGGREGATE BASE
HEAVY DUTY CONCRETE:	
8"	4000 PSI CONCRETE
6"	GRADED AGGREGATE BASE
MILL/OVERLAY	
1.5"	MILL
1.5"	OVERLAY

\*REFER TO THE ENGINEERING & TESTING SERVICES REPORT, ETS REPORT NO.: ETS-15E106-3

PAVEMENT LEGEND	
	LIGHT DUTY PAVING
	HEAVY DUTY PAVING
	HEAVY DUTY CONCRETE
	REPLACE/MILL/OVERLAY

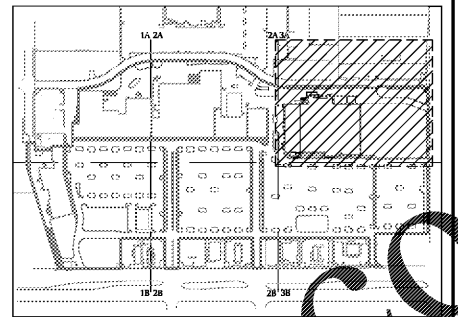

SHEET LEGEND

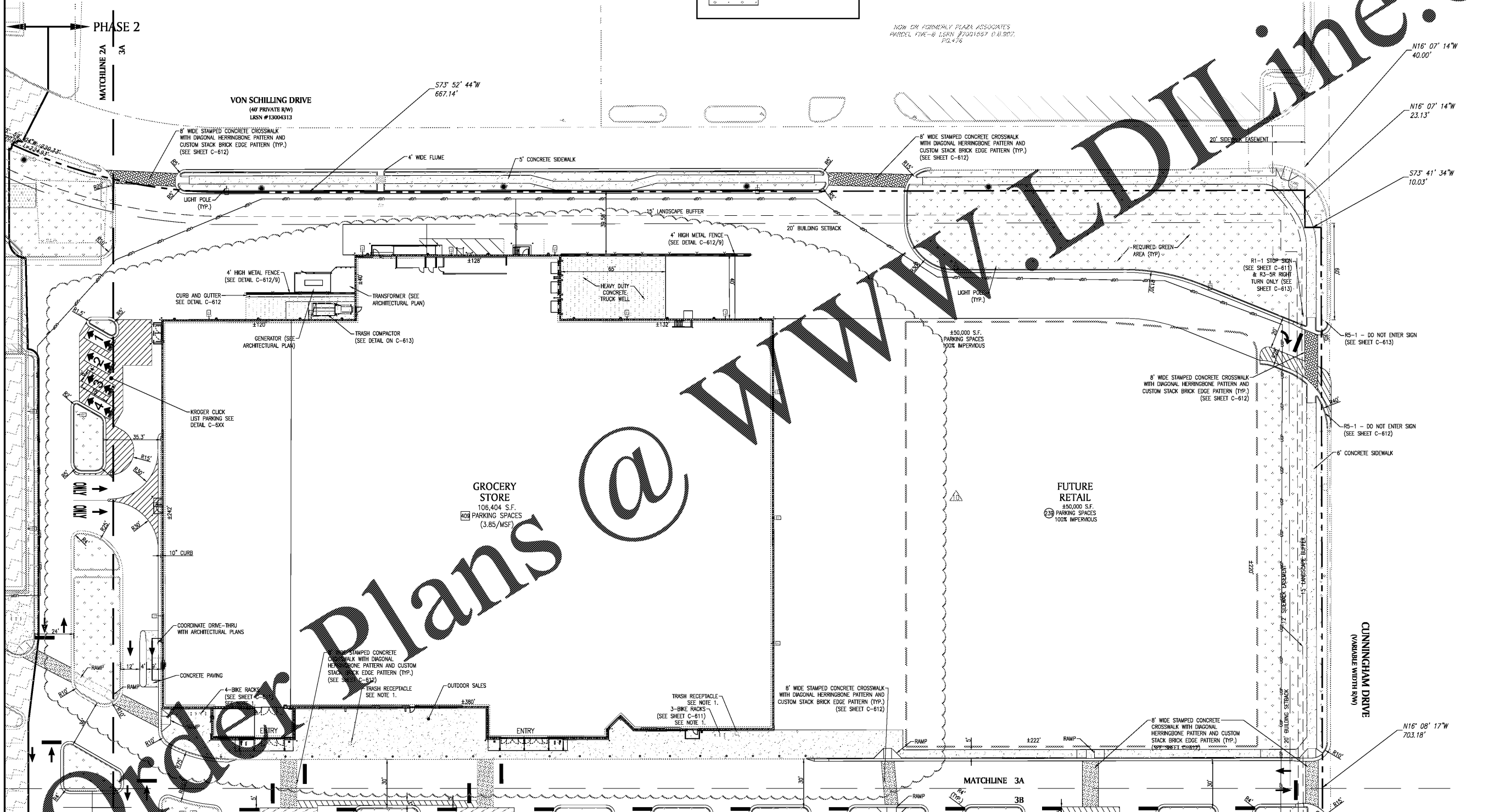

SITE PLAN 3A

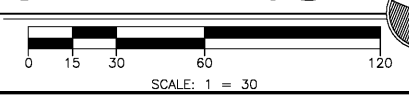

**PAULSON MITCHELL**  
 INCORPORATED  
 200 HILL STREET  
 SUITE 200  
 ROSWELL, GEORGIA 30075  
 VOICE 770.650.7685  
 FAX 770.650.7684  
 www.paulsonmitchell.com

PROJECT:  
**RIVERPOINTE PLAZA PHASE 2**  
 1048 & 1050 W. MERCURY BLVD.  
 HAMPTON, VIRGINIA 23666

FOR:  
**KB RIVERDALE, LLC**  
 2743 PERIMETER PARKWAY  
 BLDG. 100, SUITE 370  
 AUGUSTA, GA 30909  
 PH. (706) 854-6714

REVISIONS		
△	08.19.16	CITY COMMENTS
△	10.04.16	CITY COMMENTS
△	10.06.16	CITY COMMENTS
△	10.13.16	CITY COMMENTS
△	02.01.17	CLIENT COMMENTS
△	11.01.18	CLIENT COMMENTS

**va811.com**  
 Dig With G.O.G.  
 BEFORE YOU DIG, CALL MISS UTILITY 1-800-552-7001

**24 HR EMERGENCY CONTACT**  
 MARK SENN  
 MARK.SENN@SOUTHEASTERN.COM

2014169s-2.dwg 06.28.16

SITE PLAN 3A