

Order Plans @ [www.LDILine.com](http://www.LDILine.com)

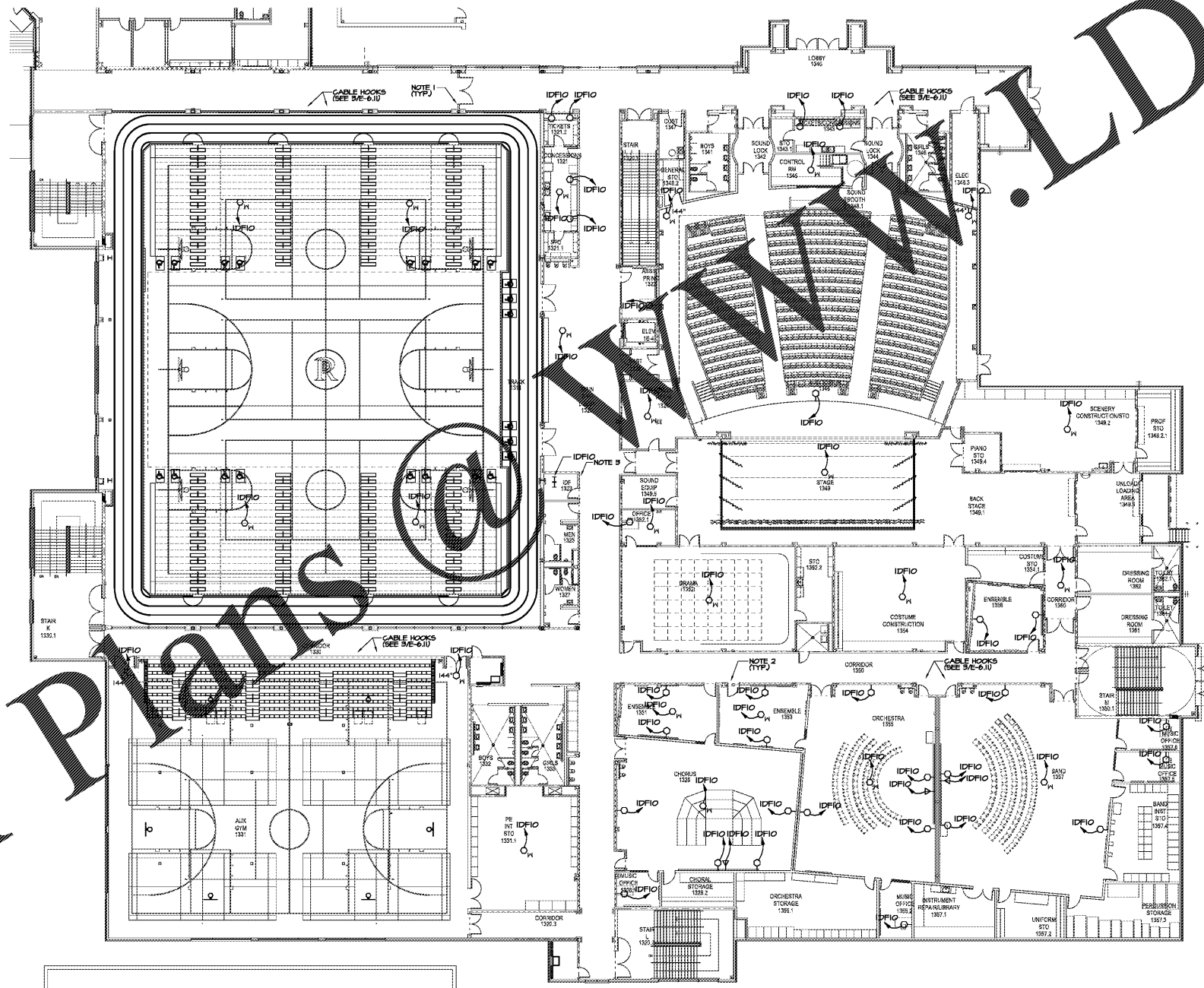

LEVEL 100 FLOOR PLAN - DATA  
E-5.21 1/16"=1'-0"

SEE SHEET E-5.11 FOR REFERENCED NOTES.

- REFERENCED NOTES:** (APPLIES TO E-5.11 THRU E-5.31)
- WHERE CABLES PASS THROUGH FIRE WALLS FROM CABLE HANGERS ON EACH SIDE, INSTALL THREE 3" CONDUIT SLEEVES WITH BUSHINGS ON BOTH SIDES. FIRE STOP AFTER ALL CABLES ARE INSTALLED.
  - WHERE CABLES PASS THROUGH FIRE WALLS TO INDIVIDUAL ROOMS, INSTALL (3) 1" CONDUIT SLEEVES WITH BUSHINGS ON BOTH SIDES, 1 FOR DATA, 1 FOR INTERCOM, 1 FOR ALL OTHERS. FIRE STOP AFTER ALL CABLES ARE INSTALLED.
  - WHERE CABLES PASS THRU FIRE WALLS FROM CABLE HANGERS IN TO IDF ROOM, INSTALL TWO 3" CONDUIT SLEEVES WITH BUSHINGS ON BOTH ENDS. FIRE STOP AFTER ALL CABLES ARE INSTALLED.
  - PROVIDE (2) 4" FROM IDF 1216 TO FUTURE LOCATION OF MODULAR TRAILERS. STUD CONDUIT UP INTO ABOVE GROUND BOX AND CAP. SEE SITE PLAN FOR APPROXIMATE LOCATION. COORDINATE EXACT LOCATION WITH OWNER. SEE SPECIFICATIONS FOR PULLBOXES, DO NOT USE 90 DEGREE ELBOWS.

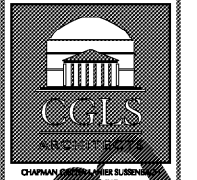
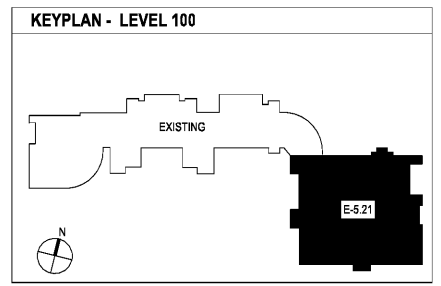

CHAPMAN GRIFFIN LANIER SUSSENBACH ARCHITECTS  
INC.



2970 Clairmont Rd., Suite 420  
Atlanta, GA 30329  
P: 404.633.0245  
F: 404.633.1756

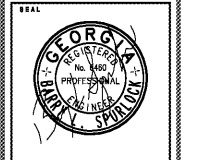

DATE	NO.	DESCRIPTION
03/27/18		ISSUE PRELIMINARY DRAWINGS
04/19/18		ISSUE DESIGN DEVELOPMENT DOCUMENTS
08/17/18		ISSUE CONSTRUCTION PERMIT SET
11/07/18		ISSUE FINAL SUBMITTAL FOR PERMITS
11/07/18		ISSUE FINAL SUBMITTAL FOR PERMITS

**RIVERWOOD HIGH SCHOOL-PHASE 3-8  
AUDITORIUM / GYMNASIUM ADDITION**  
5900 RAIDER DRIVE NW SANDY SPRINGS, GA 30328  
FULTON COUNTY SCHOOLS RFP NO. 411-19

**LEVEL 100  
FLOOR PLAN -  
DATA**

PROJECT NO. 18015.02

DATE 09/17/18

DRAWN BY: GTR  
CHECKED BY: BLS

**E-5.21**