

NOTE: AC POWER PROVIDED AT MIXER LOCATION MUST BE ON SAME PHASE OF SERVICE AS THAT PROVIDED TO EQUIPMENT RACK

CONDUIT FILL

WEST PENN 291: 1-7 1/2" 8-12 3/4" 13-20 1" 21-35 1 1/4"	WEST PENN 424: 1-3 1/2" 4-5 3/4" 6-9 1"
WEST PENN 224: 1-3 1/2" 4-5 3/4"	WEST PENN 813: 1-4 1/2" 5-7 3/4"
WEST PENN C207: 1-2 1/2" 3-3 1/2" 4-5 1" 6-1 1 1/4" 7-15 1 1/2" 16-25 2"	WEST PENN XT DTP 24: 1-2 3-5 3/4" 6-1"
WEST PENN D430: 1-2 1/2"	WEST PENN 225: 1-2 1/2" 3-4 3/4" 5-6 1"

WIRE LEGEND

SYMBOL	WEST PENN #	DESCRIPTION
a	291	WEST PENN # 291
b	224	WEST PENN # 224
c	C207	WEST PENN # C207
d	D430	WEST PENN # D430
e	XTP DTP 24	WEST PENN # XTP DTP 24
f	424	WEST PENN # 424
g	225	WEST PENN # 225
h	813	WEST PENN # 813

LEGEND

- M6 WALL MOUNTED MICROPHONE JACK, 6 INPUTS PROCO TYPE G REQUIRES THREE GANG BOX AT OUTLET HEIGHT
- M4 WALL MOUNTED MICROPHONE JACK, 4 INPUTS PROCO TYPE E REQUIRES TWO GANG BOX AT OUTLET HEIGHT
- Ⓜ CEILING MOUNTED MICROPHONE JACK REQUIRES SINGLE GANG BOX ATTACHED TO STRUCTURE
- A WIRELESS MIC/HEARING ASSIST REMOTE ANTENNA REQUIRES SINGLE GANG BOX AT 18" AFF
- FB FLOORBOX IN STAGE FLOOR ACE BACKSTAGE SUPER POCKET REQUIRES BRK1028BX BACKBOX
- SM DANLEY SOUND LABS TH-118 SUBWOOFER SUSPENDED FROM STRUCTURE
- DANLEY SOUND LABS SHIP LOUVER SUSPENSION FROM STRUCTURE AT 21" AFF
- RP REMOTE POWER CONTROL LOWELL RPS92-MKP REQUIRES SINGLE GANG BOX AT SWITCH HEIGHT
- RV REMOTE VOLUME CONTROL (DIRECT MIC ONLY) BIAMP TEC-11 REQUIRES SINGLE GANG BOX AT SWITCH HEIGHT
- MS WALL MOUNTED MONITOR SPEAKER JACK PROCO TYPE E REQUIRES TWO GANG BOX AT OUTLET HEIGHT
- M2 MIXER/DATA CONNECTION JACK PLATE PROCO TYPE E REQUIRES TWO GANG BOX AT OUTLET HEIGHT
- Ⓢ FLUSH CEILING MOUNTED SPEAKER ASSEMBLY JBL CONTROL 26CT
- Ⓢ SURFACE MOUNTED WALL SPEAKER ASSEMBLY JBL CONTROL HST
- IC WALL MOUNTED INTERCOM SYSTEM JACK (TYPE 1) CLEARCOM WP-2 REQUIRES SINGLE GANG BOX AT OUTLET HEIGHT
- I2 WALL MOUNTED INTERCOM SYSTEM JACK (TYPE 2) CLEARCOM WP-8 REQUIRES SINGLE GANG BOX AT OUTLET HEIGHT
- IS WALL MOUNTED INTERCOM SPEAKER STATION CLEARCOM KB702GM REQUIRES FOUR GANG BOX AT SWITCH HEIGHT
- V2 WALL MOUNTED VOLUME CONTROL (25 WATT) LOWELL 25LVC REQUIRES SINGLE GANG BOX SWITCH HEIGHT
- V5 WALL MOUNTED VOLUME CONTROL (50 WATT) LOWELL 50LVC REQUIRES SINGLE GANG BOX SWITCH HEIGHT
- WALL MOUNT FOR VIDEO PROJECTOR (PROJECTOR FBO) MOUNTED ABOVE CONTROL BOOTH WINDOWS ON CENTERLINE OF ROOM
- V1 WALL MOUNTED REMOTE VIDEO CONTROL EXTRON MLC PLUS 100 REQUIRES TWO GANG BOX AT SWITCH HEIGHT
NOTE: BOX MUST BE 3" DEEP, MINIMUM DO NOT USE CANCELEABLE BOXES
- AV1 WALL MOUNTED AUDIO/VIDEO INPUT EXTRON DTP T UWP 4K 332 D REQUIRES TWO GANG BOX AT OUTLET HEIGHT
NOTE: BOX MUST BE 3" DEEP, MINIMUM DO NOT USE CANCELEABLE BOXES

SOUND SYSTEM CABINET LOCATION (SSJB)
PROVIDE 18X18X4 J-BOX AT 18" AFF.
PROVIDE 4 EA. 120VAC 20A CIRCUITS W/DEDICATED NEUTRAL AND GROUND ON DUPLEX OUTLETS ALL ON SAME PHASE OF SERVICE

NOTE: PROVIDE 120VAC AT EACH FLOORBOX
NOTE: SPEAKER/MICROPHONE/INTERCOM CABLES MAY NOT BE COMBINED IN SAME CONDUIT
ALL HOME RUNS SHOWN ROUTE TO SOUND SYSTEM EQUIPMENT CABINET (SSJB)

THEATER SOUND SYSTEM PLAN
E-3.24 1/8"=1'-0"

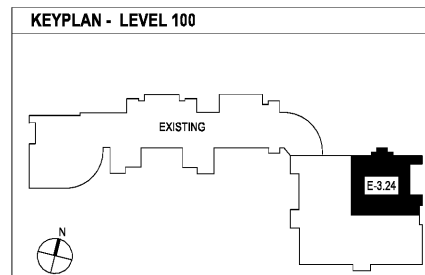

Order Plans @ WWW.DIPLINE.COM

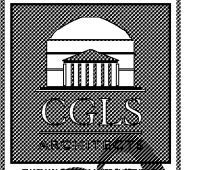

SPURLOCK ASSOCIATES, INC.
2970 Clairmont Rd., Suite 420
Atlanta, GA 30329
P: 404.633.0245
F: 404.633.1756

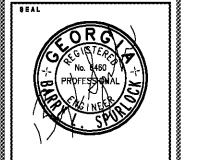

DATE	NO.	DESCRIPTION
03/27/18		ISSUE PRELIMINARY QUANTITIES
04/19/18		DESIGN DEVELOPMENT
04/19/18		ISSUE CONSTRUCTION DOCUMENTS
04/17/18		ISSUE PERMIT SET
11/07/18		FINAL ISSUE SUBMITTAL
11/07/18		ISSUE FOR PROPOSALS

DOE FACILITY CODE: 660 -3066
RIVERWOOD HIGH SCHOOL-PHASE 3-8 AUDITORIUM / GYMNASIUM ADDITION
5900 RAIDER DRIVE NW SANDY SPRINGS, GA 30328
FULTON COUNTY SCHOOLS RFP NO. 411-19

SHEET TITLE
LEVEL 100 FLOOR PLAN - THEATER SOUND SYSTEM
PROJECT NO. 18015.02
DATE 09/17/18
DRAWN BY: GTR
CHECKED BY: BLS
SHEET NO. **E-3.24**

CHAPMAN GRIFFIN LANIER ARCHITECTS
5800 GRANTVILLE PARKWAY, SUITE 100, ATLANTA, GEORGIA 30328 • PHONE: 404.733.5492 • FAX: 404.733.6800