

Order Plans @ www.dline.com

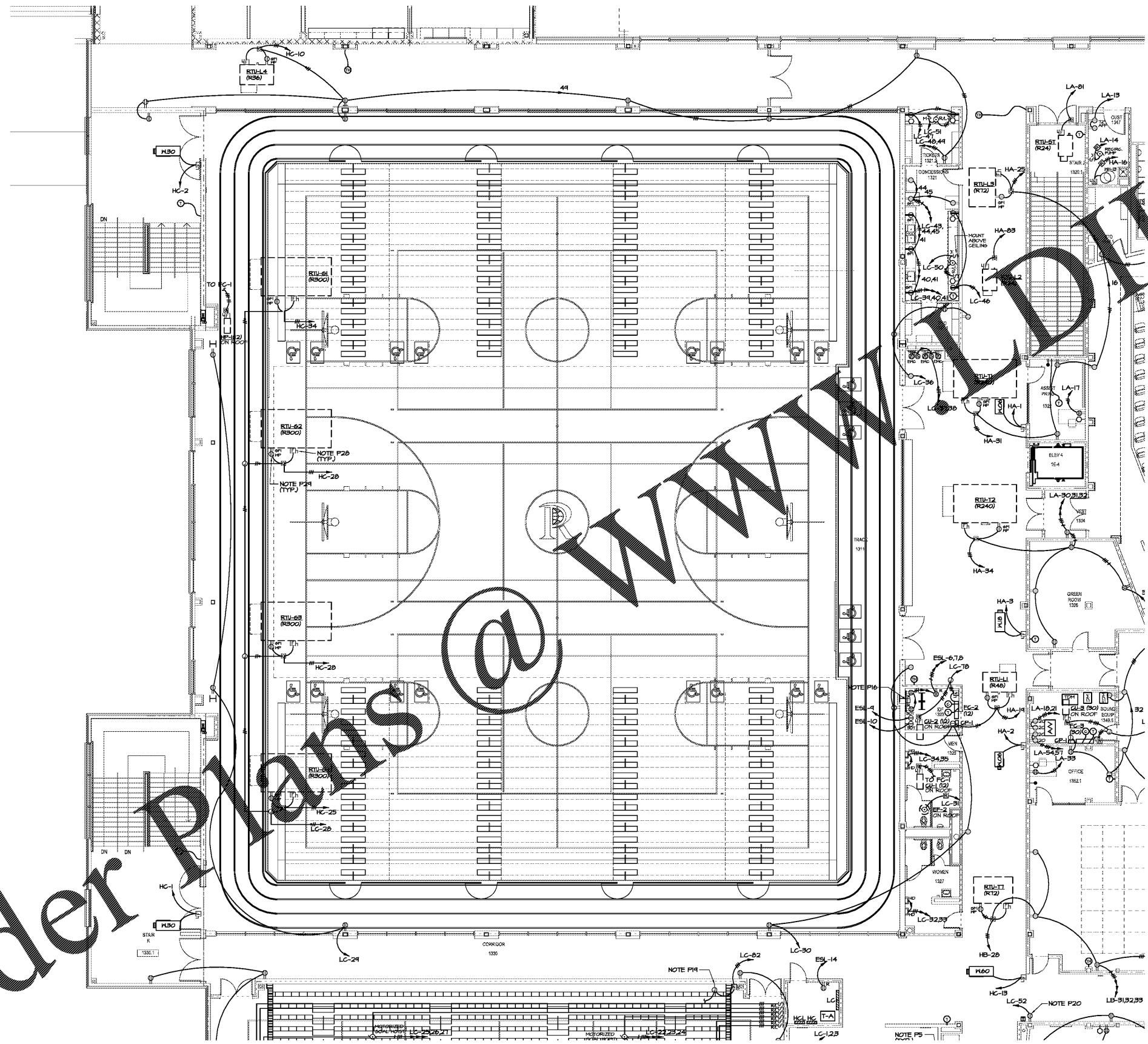

1 LEVEL 100 FLOOR PLAN - PART I - POWER
E-2.21 1/8"=1'-0"

2 ELEC ROOM
E-2.21 1/4"=1'-0"

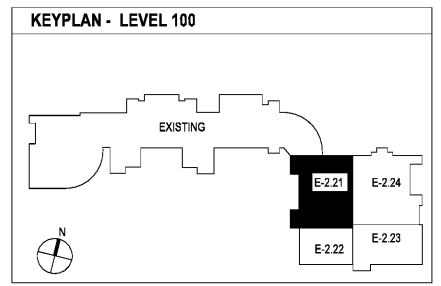

SEE SHEET E-2.11 FOR REFERENCED POWER NOTES.

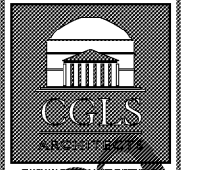

FOR RELEASED OR CONSTRUCTION

SPURLOCK ASSOCIATES, INC.
2970 Clairmont Rd., Suite 420
Atlanta, GA 30329
P: 404.633.0245
F: 404.633.1756

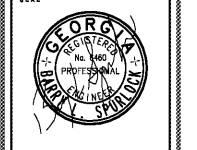

DATE	NO.	DESCRIPTION
03/27/18		ISSUE PRELIMINARY QUANTITIES
05/19/18		ISSUE PRELIMINARY DESIGN DEVELOPMENT DOCUMENTS
08/17/18		ISSUE PRELIMINARY-SCF/PERMIT SET
11/15/18		FINAL ISSUE SUBMITTAL READY FOR PROPOSALS

**RIVERWOOD HIGH SCHOOL-PHASE 3-8
AUDITORIUM / GYMNASIUM ADDITION**
5900 RAIDER DRIVE NW SANDY SPRINGS, GA 30328
FULTON COUNTY SCHOOLS RFP NO. 411-19

**LEVEL 100
FLOOR PLAN-
PART 1-
POWER**

PROJECT NO. 18015.02
DATE 09/17/18
DRAWN BY: G.T.R.
CHECKED BY: B.L.S.

E-2.21