

Order Plans

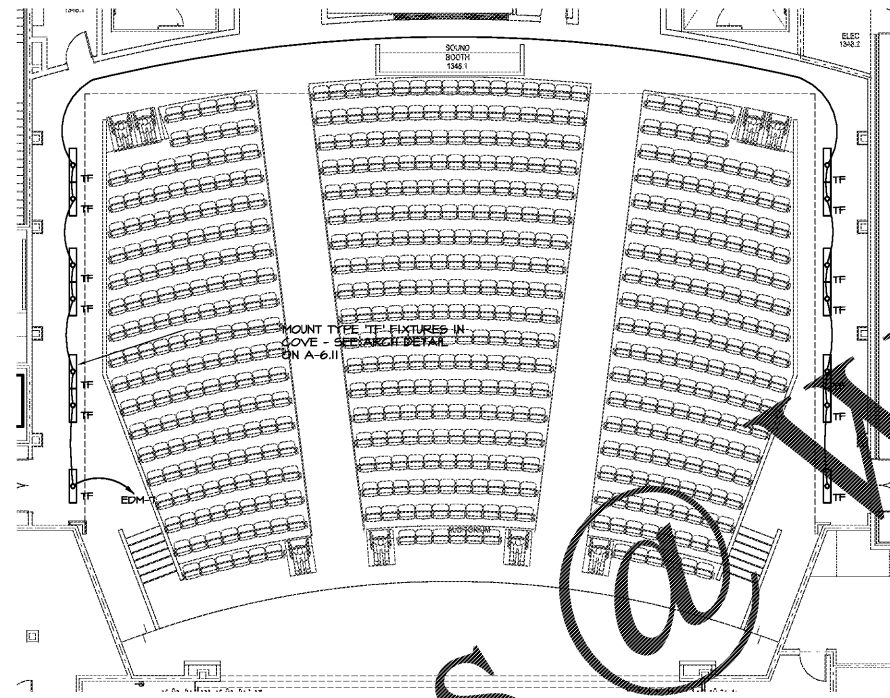

2 AUDITORIUM COVE LIGHTING
E-1.25 1/8" = 1'-0"

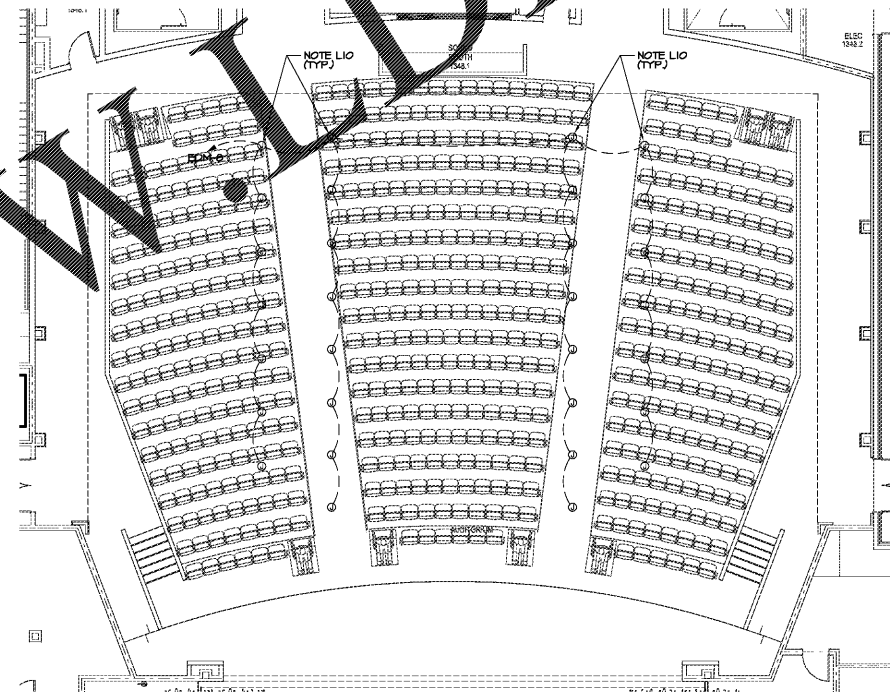

1 AUDITORIUM AISLE LIGHTING
E-1.25 1/8" = 1'-0"

SEE SHEET E-1.11 FOR REFERENCED LIGHTING NOTES.

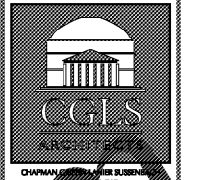
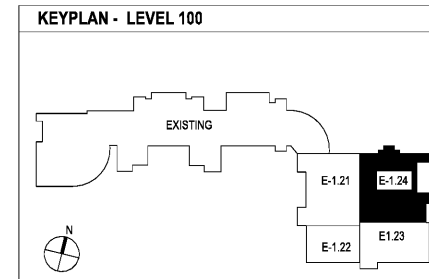

CHAPMAN GRIFFIN LANIER SUSSENBACH ARCHITECTS
4000 GOLFVIEW PARKWAY, SUITE 100, ATLANTA, GEORGIA 30339 • PHONE: 404.733.5492 • FAX: 404.733.6804

FOR RELEASED OR CONSTRUCTION
CONSULTANT
SPURLOCK ASSOCIATES, INC.
2970 Clairmont Rd., Suite 420
Atlanta, GA 30329
P: 404.633.0245
F: 404.633.1756

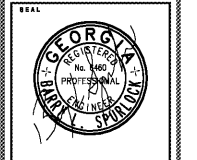

DATE	NO.	DESCRIPTION
03/27/18		ISSUE PRELIMINARY QUANTITIES
05/19/18		ISSUE PRELIMINARY DESIGN DEVELOPMENT DOCUMENTS
08/17/18		ISSUE CONSTRUCTION DOCUMENTS
11/15/18		FINAL ISSUE SUBMITTAL ISSUED FOR PROPOSALS

DOE FACILITY CODE: 660 -3066
RIVERWOOD HIGH SCHOOL-PHASE 3-8 AUDITORIUM / GYMNASIUM ADDITION
6900 RAIDER DRIVE NW SANDY SPRINGS, GA 30328
FULTON COUNTY SCHOOLS RFP NO. 411-19

SHEET TITLE
LEVEL 100 AISLE AND COVE LIGHTING

PROJECT NO. 16015.02
DATE 09/17/18
DRAWN BY: G.T.R.
CHECKED BY: B.L.S.

SHEET NO.
E-1.25