

Order Plans @ www.LDILine.com

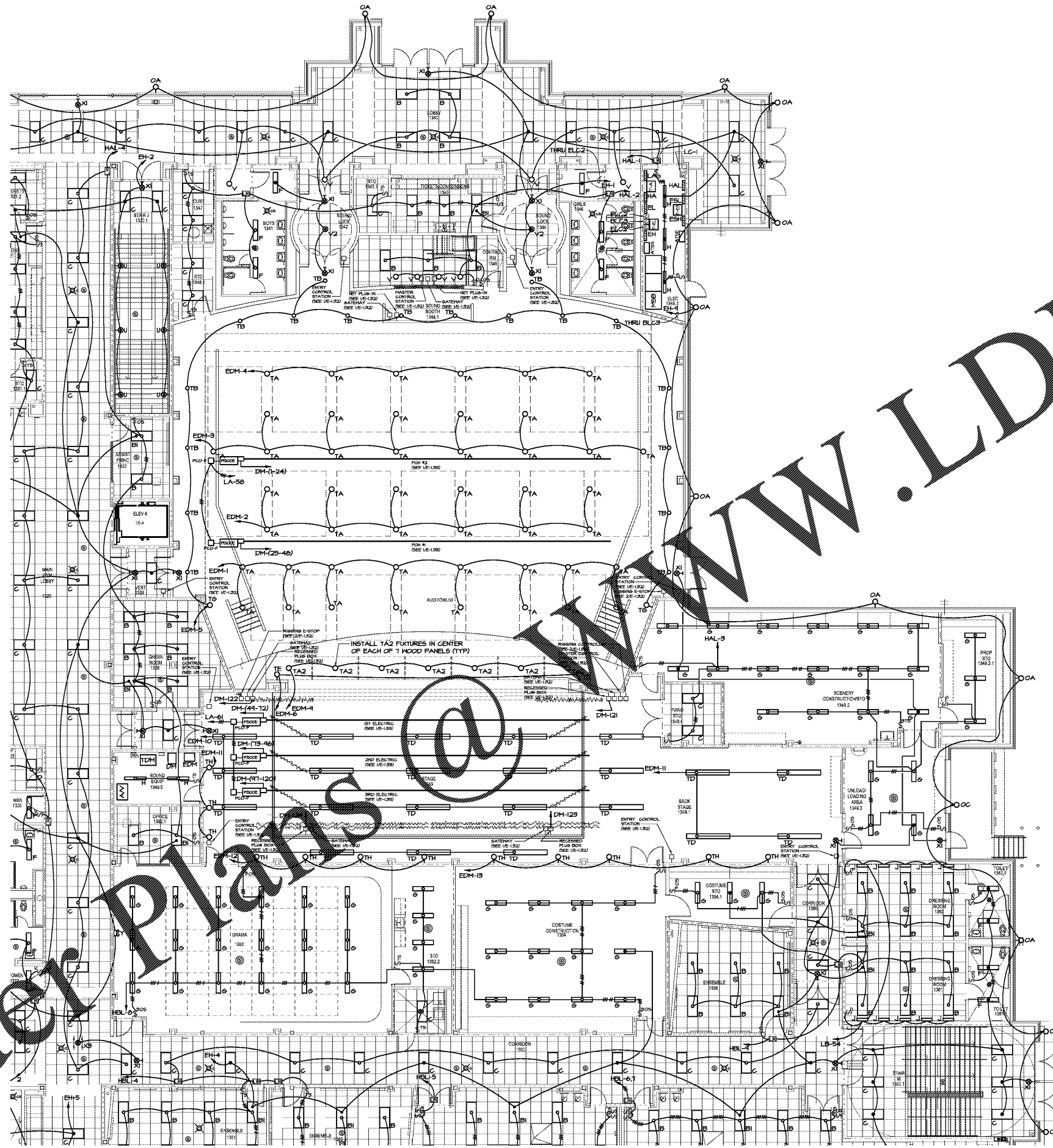

① LEVEL 100 FLOOR PLAN - PART 4- LIGHTING
E-1.24 1/8"=1'-0"

SEE SHEET E-1.11 FOR REFERENCED LIGHTING NOTES.

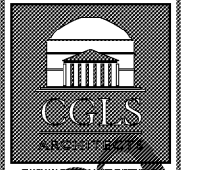
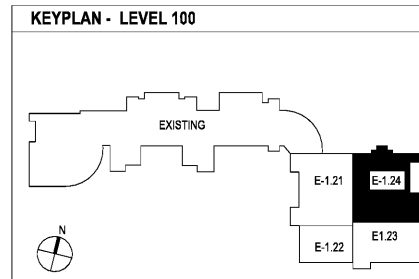

ARCHITECTS
PLANNING
REGISTRATION NUMBER
CHAPMAN GRIFFIN LANIER SUSSENBACH ARCHITECTS
INC.



REGISTERED PROFESSIONAL ENGINEER
FOR CONSTRUCTION
SPURLOCK ASSOCIATES, INC.
2970 Clairmont Rd., Suite 420
Atlanta, GA 30329
P: 404.633.0245
F: 404.633.1756

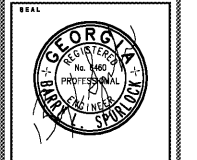

DATE	NO.	DESCRIPTION
03/27/18		ISSUE PRELIMINARY SCHEMATIC
05/18/18		ISSUE PRELIMINARY DESIGN DEVELOPMENT DOCUMENTS
08/17/18		ISSUE PRELIMINARY-SC/PERMIT SET
10/17/18		FINAL ISSUE SUBMITTAL
11/02/18		ISSUED FOR PROPOSAL

DOE FACILITY CODE: 660 -3066
RIVERWOOD HIGH SCHOOL-PHASE 3-8
AUDITORIUM / GYMNASIUM ADDITION
5900 RAIDER DRIVE NW SANDY SPRINGS, GA 30328
FULTON COUNTY SCHOOLS RFP NO. 411-19

SHEET TITLE
LEVEL 100
FLOOR PLAN-
PART 4-
LIGHTING

PROJECT NO.
16015.02
DATE
09/17/18
DRAWN BY
G.T.R.
CHECKED BY
B.L.S.

SHEET NO.
E-1.24

CHAPMAN GRIFFIN LANIER SUSSENBACH ARCHITECTS
4000 GRANTLAND PARKWAY, SUITE 100, ATLANTA, GEORGIA 30329 • PHONE: 404.733.5492 • FAX: 404.733.6806