

Order Plans @ www.WLDILine.com

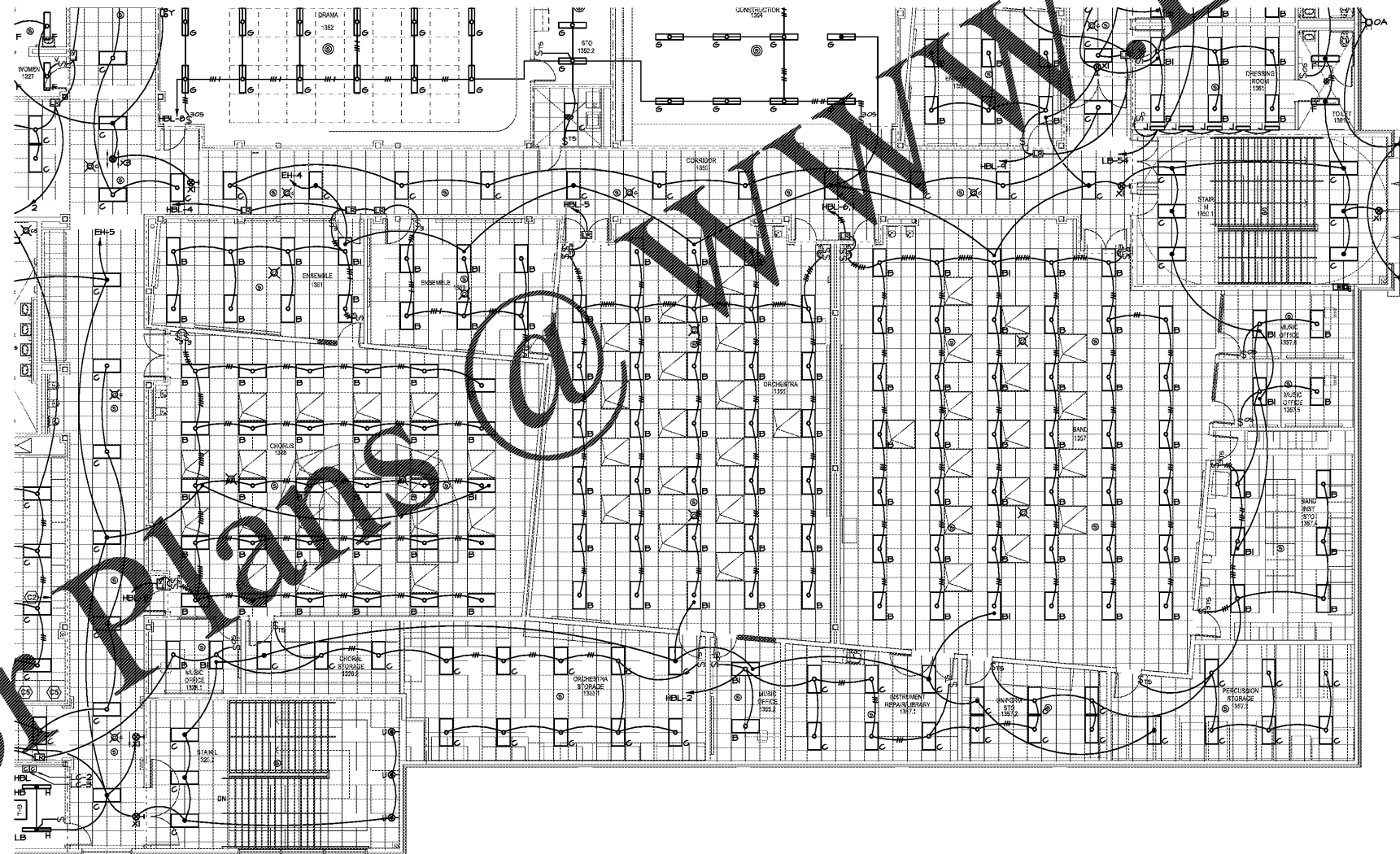

SEE SHEET E-1.11 FOR REFERENCED LIGHTING NOTES.

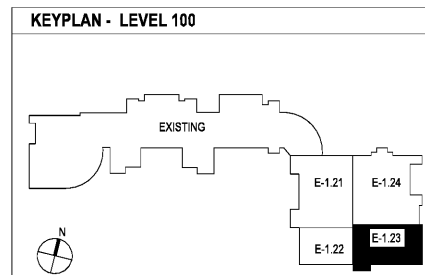

LEVEL 100 FLOOR PLAN - PART 3- LIGHTING
E-1.23 1/8"=1'-0"

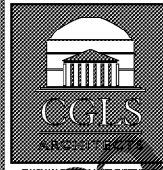

CHAPMAN GRIFFIN LANIER SUSSENBACH ARCHITECTS
INC.



2970 Clairmont Rd., Suite 420
Atlanta, GA 30329
P: 404.633.0245
F: 404.633.1756

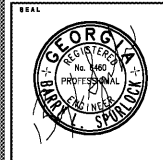

DATE	NO.	DESCRIPTION
03/27/18		ISSUE PRELIMINARY QUANTITIES
04/19/18		ISSUE PRELIMINARY DESIGN DEVELOPMENT DOCUMENTS
08/17/18		ISSUE PRELIMINARY-SC/PERMIT SET
09/17/18		FINAL ISSUE SUBMITTAL ISSUED FOR PROPOSAL

**RIVERWOOD HIGH SCHOOL-PHASE 3-8
AUDITORIUM / GYMNASIUM ADDITION**
5900 RAIDER DRIVE NW SANDY SPRINGS, GA 30328
FULTON COUNTY SCHOOLS RFP NO. 411-19

SHEET TITLE
**LEVEL 100
FLOOR PLAN-
PART 3-
LIGHTING**

PROJECT NO.
16015.02

DATE
09/17/18

DRAWN BY: G.T.R.
CHECKED BY: B.L.S.

SHEET NO.

E-1.23