

Order Plans

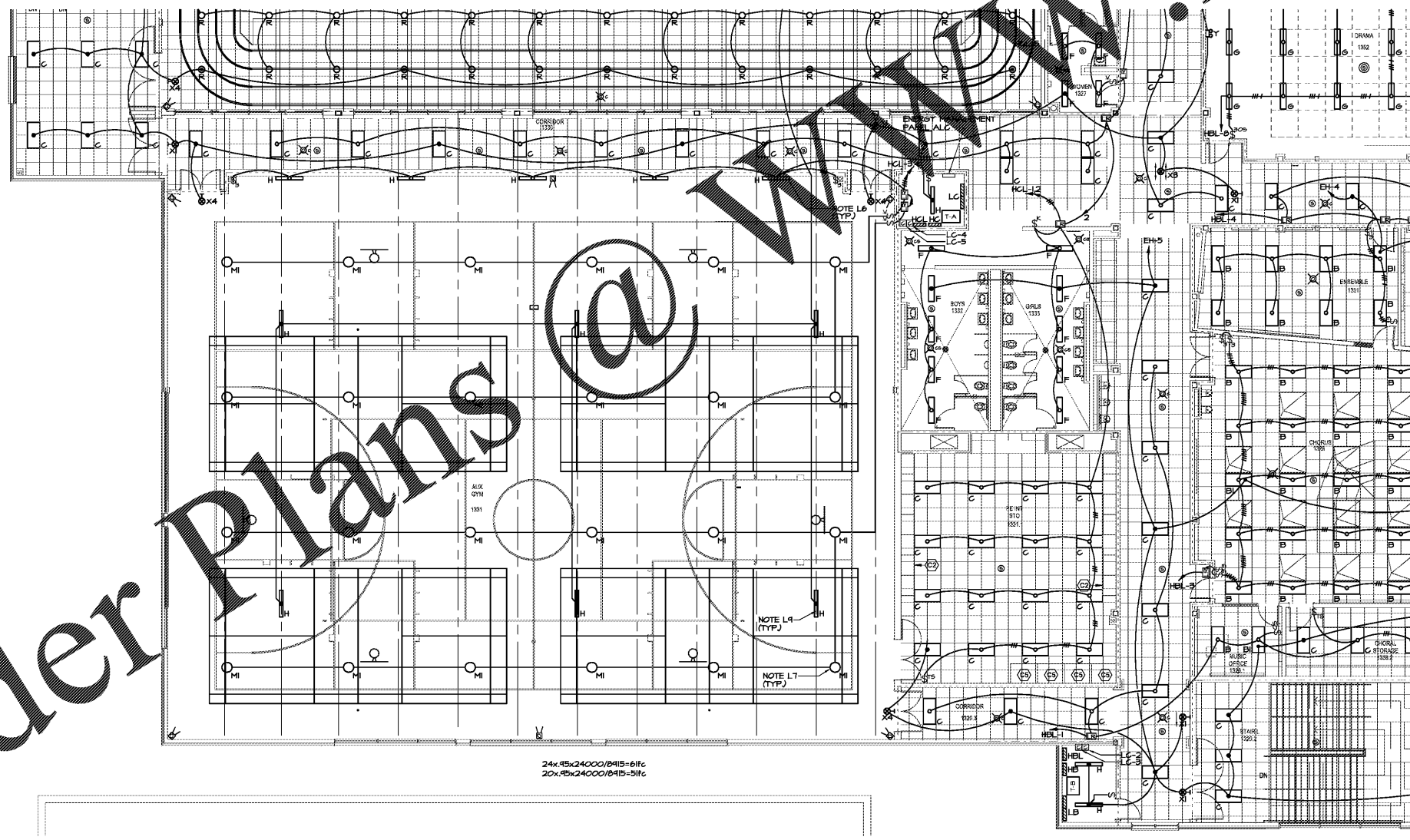

LEVEL 100 FLOOR PLAN - PART 2- LIGHTING
E-1.22 1/8"=1'-0"

SEE SHEET E-1.11 FOR REFERENCED LIGHTING NOTES.

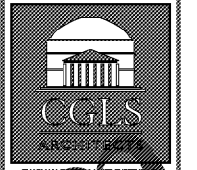
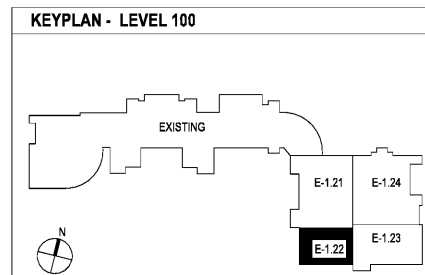

CHAPMAN GRIFFIN LANIER SUSSENBACH ARCHITECTS
INC.

REGISTERED PROFESSIONAL ARCHITECTS
FOR CONSTRUCTION

SPURLOCK ASSOCIATES, INC.

2970 Clairmont Rd., Suite 420
Atlanta, GA 30329
P: 404.633.0245
F: 404.633.1756

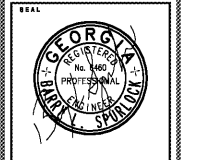

DATE	NO.	DESCRIPTION
03/27/18		ISSUE PRELIMINARY QUANTITIES
04/19/18		ISSUE PRELIMINARY DESIGN DEVELOPMENT DOCUMENTS
04/17/18		ISSUE PRELIMINARY-SC/PERMIT SET
04/19/18		FINAL ISSUE SUBMITTAL ISSUED FOR PROPOSAL
11/07/18		

DOE FACILITY CODE: 660 -3066
RIVERWOOD HIGH SCHOOL-PHASE 3-8 AUDITORIUM / GYMNASIUM ADDITION
6900 RAIDER DRIVE NW SANDY SPRINGS, GA 30328
FULTON COUNTY SCHOOLS RFP NO. 411-19

SHEET TITLE
LEVEL 100 FLOOR PLAN-PART 2- LIGHTING

PROJECT NO. 16015.02

DATE 09/17/18

DRAWN BY: G.T.R.
CHECKED BY: B.L.S.

SHEET NO.
E-1.22