

CHAPMAN GRIFFIN LANIER SUSSENBACH ARCHITECTS
ARCHITECTS
PLANNING
REGISTRATION BOARD

FOR RELEASE
OR CONSTRUCTION
REGULATORY
SPURLOCK ASSOCIATES, INC.
2970 Clairmont Rd., Suite 420
Atlanta, GA 30329
P: 404.633.0245
F: 404.633.1756

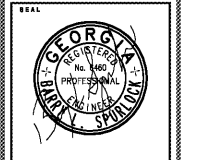

DATE	NO.	DESCRIPTION
03/27/18		ISSUE PRELIMINARY QUANTITY
04/19/18		ISSUE PRELIMINARY DESIGN DEVELOPMENT DOCUMENTS
04/17/18		ISSUE CONSTRUCTION PERMIT SET
04/19/18		FINAL ISSUE SUBMITTAL
11/02/18		ISSUED FOR PROPOSALS

DOE FACILITY CODE: 660 -3066
**RIVERWOOD HIGH SCHOOL-PHASE 3-8
 AUDITORIUM / GYMNASIUM ADDITION**
 6900 RAIDER DRIVE NW SANDY SPRINGS, GA 30328
 FULTON COUNTY SCHOOLS RFP NO. 411-19

SHEET TITLE
**LEVEL 100
 FLOOR PLAN-
 PART 1-
 LIGHTING**

PROJECT NO.
16015.02

DATE
09/17/18

DRAWN BY: G.T.R.
 CHECKED BY: B.L.S.

SHEET NO.
E-1.21

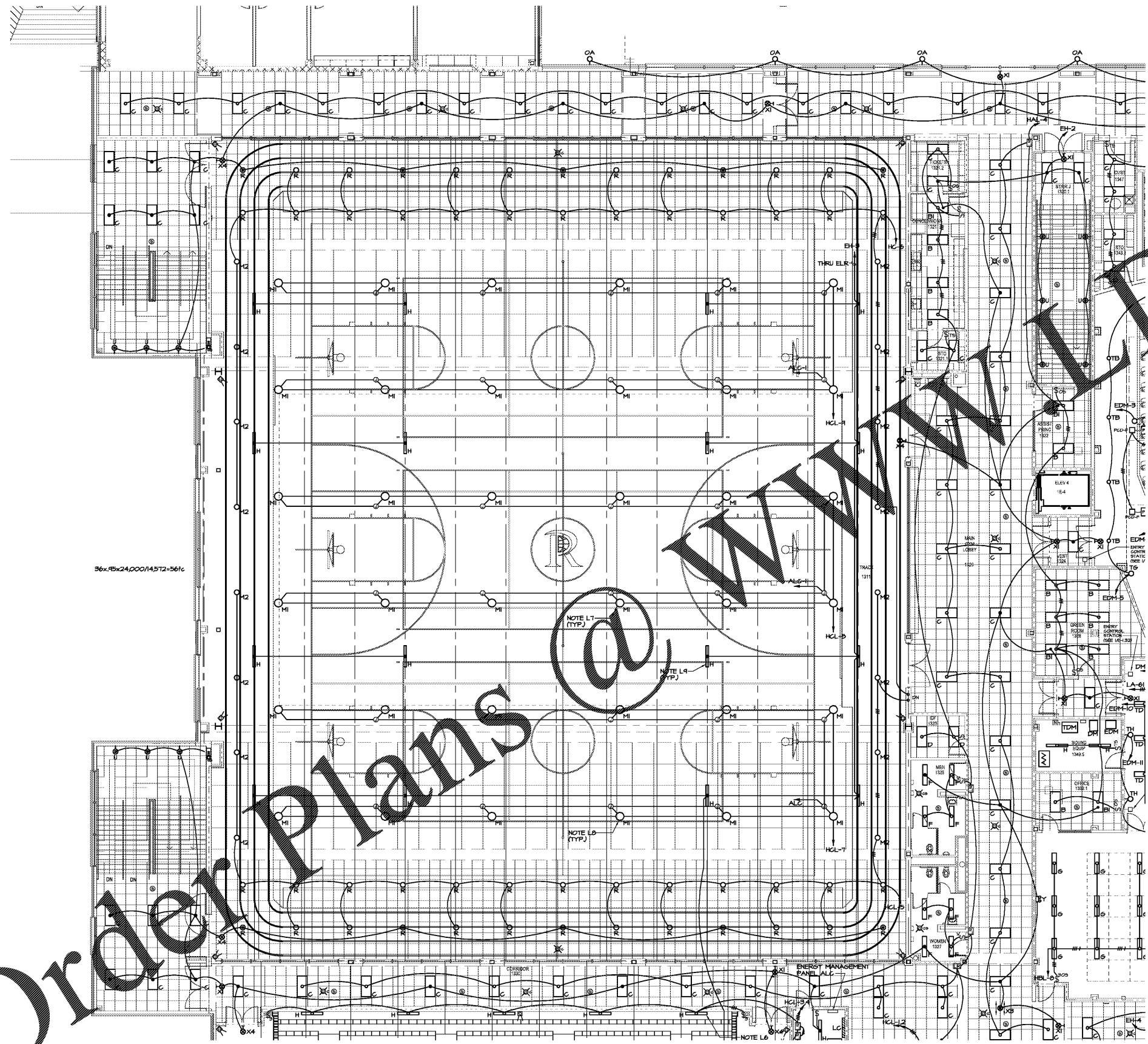

LEVEL 100 FLOOR PLAN - PART 1 - LIGHTING
 E-1.21 1/8"=1'-0"

SEE SHEET E-1.11 FOR REFERENCED LIGHTING NOTES.

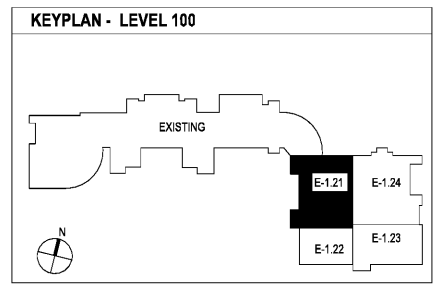

Order Plans @ www.dlLine.com