

Order Plans

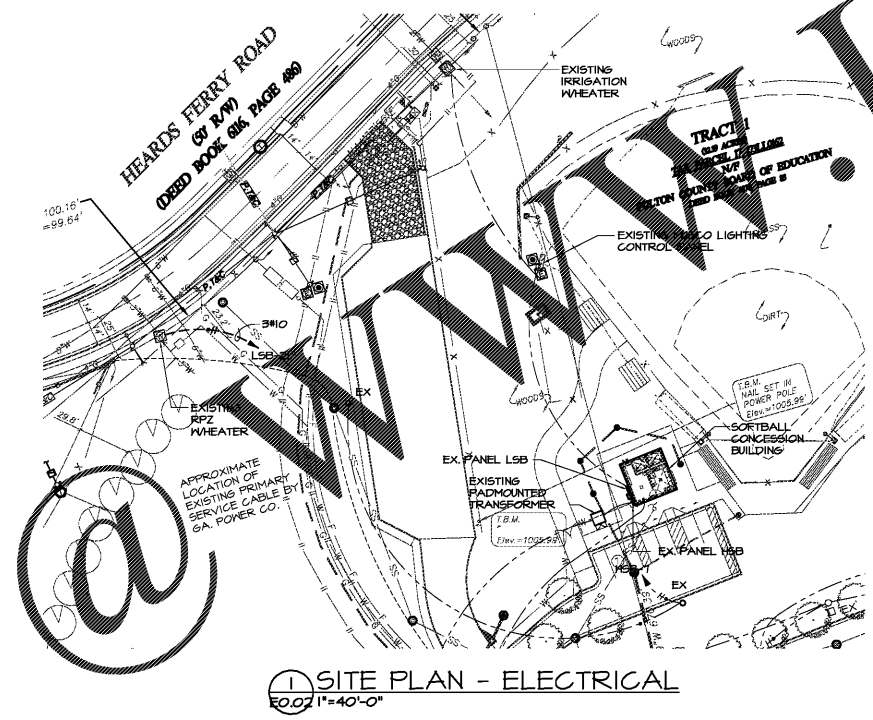

1 SITE PLAN - ELECTRICAL  
E0.02 1"=40'-0"

THE EXISTING UTILITIES SHOWN ON THIS PLAN WERE OBTAINED FROM VARIOUS UTILITY COMPANIES, MUNICIPAL GOVERNMENTS, AGENCIES AND ABOVE-GROUND INDUSTRY. THE SURVEYOR HAS NOT PROVIDED ANY WARRANTY AS TO THE COMPLETENESS OF THE INFORMATION. THE BURDEN OF VERIFYING THE ACCURACY OF THE INFORMATION IS ON THE USER. PRIOR TO BEGINNING ANY CONSTRUCTION ACTIVITIES, THE UTILITY PROTECTION SERVICE FOR THIS AREA MUST BE NOTIFIED.

IF YOU DIG DEEPER...  
CALL US FIRST!  
UTILITIES PROTECTION CENTER  
METRO ATLANTA STATE ROAD  
1 (770) 432-4334 1 (800) 282-7411  
IT'S THE LAW!

CHAPMAN GRIFFIN LANIER SUSSENBACH ARCHITECTS  
400 GARDNER PARK • SUITE 100 • ATLANTA, GEORGIA 30329 • PHONE: 404.733.5492 • FAX: 404.733.6804



CHAPMAN GRIFFIN LANIER SUSSENBACH ARCHITECTS, INC.

REGISTERED PROFESSIONAL ARCHITECTS  
STATE OF GEORGIA



SPURLOCK ASSOCIATES, INC.

2970 Clairmont Rd., Suite 420  
Atlanta, GA 30329  
P: 404.633.0245  
F: 404.633.1756



STATE OF GEORGIA  
PROFESSIONAL ENGINEER  
No. 480  
SPURLOCK

DATE	NO.	DESCRIPTION
03/27/18		ISSUE PRELIMINARY QUANTITIES
04/19/18		DESIGN DEVELOPMENT
04/17/18		ISSUE CONSTRUCTION DOCUMENTS
04/17/18		ISSUE CHECKS - SET / PERMIT SET
04/17/18		FINAL ISSUE SUBMITTAL
11/02/18		ISSUE FOR PROPOSALS

**RIVERWOOD HIGH SCHOOL-PHASE 3-8  
AUDITORIUM / GYMNASIUM ADDITION**

5900 RAIDER DRIVE NW SANDY SPRINGS, GA 30328  
FULTON COUNTY SCHOOLS RFP NO. 411-19

PROJECT TITLE  
**SITE PLAN - ELECTRICAL**

PROJECT NO. 18015.02

DATE 09/17/18

DRAWN BY: GFL/M.W.D.  
CHECKED BY: B.L.S.

**E-0.02**