

Order Plans

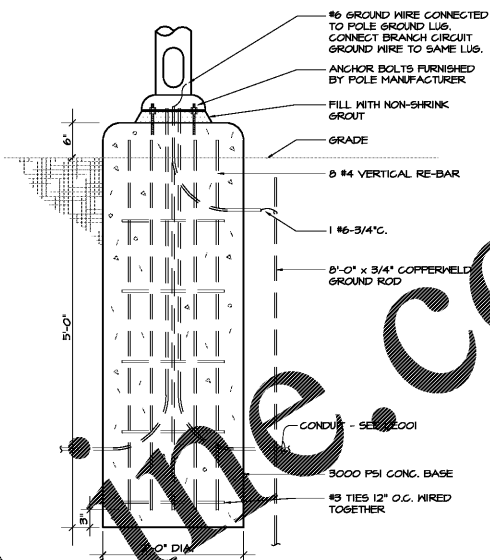
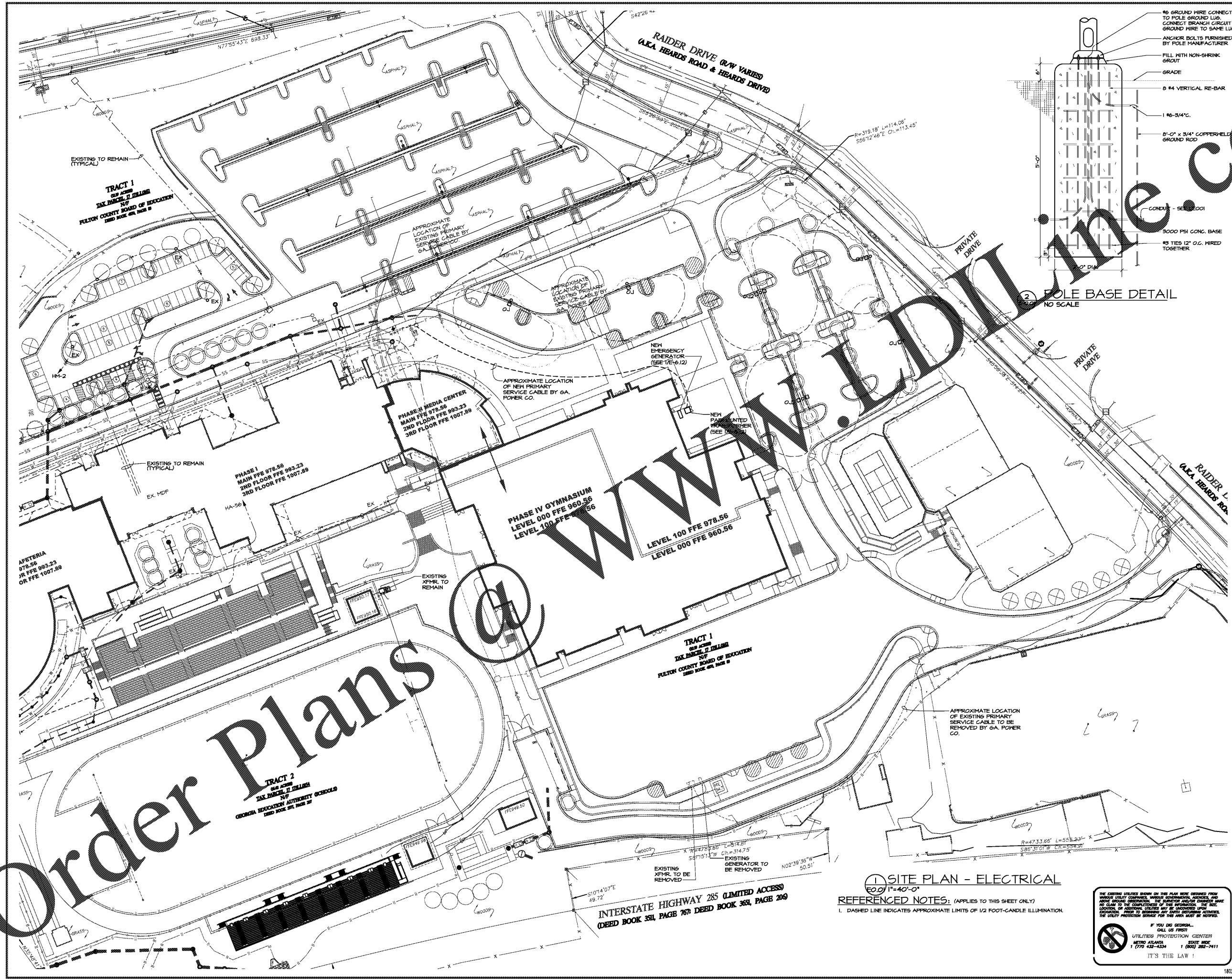

POLE BASE DETAIL
NO SCALE

1 SITE PLAN - ELECTRICAL
E.O. 12812-1
1"=40'-0"

REFERENCED NOTES: (APPLIES TO THIS SHEET ONLY)
1. DASHED LINE INDICATES APPROXIMATE LIMITS OF 1/2 FOOT-CANDLE ILLUMINATION.

THE EXISTING UTILITIES SHOWN ON THIS PLAN WERE OBTAINED FROM VARIOUS UTILITY COMPANIES, WHOSE GOVERNMENTAL AGENCIES AND AGENCIES BEARING AUTHORITY. THE SURVEYING AND ENGINEERING FIRM HAS NO CLAIM TO THE COMPLETENESS OF THIS INFORMATION. THE LOCATION OF ANY ADDITIONAL UTILITIES MAY BE DISCOVERED DURING CONSTRUCTION. PRIOR TO BEGINNING ANY WORK, CONTRACTORS SHOULD CONTACT THE UTILITY PROTECTING SERVICE FOR THE AREA MUST BE NOTIFIED.

IF YOU DIG GEORGIA...
CALL US FIRST!
UTILITIES PROTECTION CENTER
METRO ATLANTA STATE ROAD
1 (770) 432-4334 1 (800) 282-7411
IT'S THE LAW!

ARCHITECTS ENGINEERS PLANNERS FACILITATORS

CHAPMAN GRIFFIN LANIER SUSSENBACH ARCHITECTS

OR CONSTRUCTION

SPURLOCK ASSOCIATES, INC.

2970 Clairmont Rd., Suite 420
Atlanta, GA 30329
P: 404.633.0245
F: 404.633.1756

DATE	NO.	DESCRIPTION
03/27/18		ISSUE PRELIMINARY SUBMITTAL
05/18/18		DESIGN DEVELOPMENT
08/17/18		ISSUE CONSTRUCTION DOCUMENTS
10/15/18		ISSUE PERMIT SET
11/02/18		FINAL ISSUE SUBMITTAL ISSUED FOR PROPOSAL

DOE FACILITY CODE: 660 -3066

**RIVERWOOD HIGH SCHOOL-PHASE 3-8
AUDITORIUM / GYMNASIUM ADDITION**

5910 RAIDER DRIVE NW SANDY SPRINGS, GA 30328
FULTON COUNTY SCHOOLS RFP NO. 411-19

SHEET TITLE

**SITE PLAN -
ELECTRICAL**

PROJECT NO.

16015.02

DATE

09/17/18

DRAWN BY

GERM.W.D.

CHECKED BY

B.L.S.

SHEET NO.

E-0.01

CHAPMAN GRIFFIN LANIER SUSSENBACH ARCHITECTS
4000 GARDNER PARKWAY, SUITE 100 • ATLANTA, GEORGIA 30339 • PHONE: 404.733.5432 • FAX: 404.733.6804