

NEW PANEL LFB									
SERVICE: 208Y/120V, 3Ø, 4W PANEL A.I.C.: 10,000A					MAIN: 150A-3P MAIN BREAKER OPTIONS: EQUIP. GROUND BUS NEMA 3R ENCLOSURE				
SERVES	VA	CIR. BKR.	A B C	CIR. #	CIR. BKR.	VA	SERVES		
SPARE	--	20/1	1	22	20/1	--	SPARE		
SPARE	--	20/1	2	23	20/1	--	SPARE		
SPARE	--	20/1	3	24	20/1	--	SPARE		
SPARE	--	20/1	4	25	20/1	--	SPARE		
SPARE	--	20/1	5	26	20/1	--	SPARE		
SPARE	--	20/1	6	27	20/1	--	SPARE		
SPARE	--	20/1	7	28	20/1	--	SPARE		
SPARE	--	20/1	8	29	20/1	--	SPARE		
SPARE	--	20/1	9	30	20/1	--	SPARE		
SPARE	--	20/1	10	31	20/1	--	SPARE		
SPARE	--	20/1	11	32	20/1	--	SPARE		
SPARE	--	20/1	12	33	20/1	--	SPARE		
SPARE	--	20/1	13	34	20/1	--	SPARE		
SPARE	--	20/1	14	35	20/2	--	SPARE		
SPARE	--	20/1	15	36	20/2	--	SPARE		
SPARE	--	20/1	16	37	20/2	--	SPARE		
SPARE	--	20/1	17	38	20/2	--	SPARE		
SPARE	--	20/1	18	39	20/2	--	SPARE		
SPARE	--	20/1	19	40	20/2	--	SPARE		
SPARE	--	20/1	20	41	20/2	--	SPARE		
SPARE	--	20/1	21	42	20/2	--	SPARE		
TOTAL CONNECTED LOAD: VA									

NEW PANEL HFB									
SERVICE: 480Y/277V, 3Ø, 4W PANEL A.I.C.: 25,000A					MAIN: 300A-3P MAIN BREAKER OPTIONS: EQUIP. GROUND BUS NEMA 3R ENCLOSURE, S.E. LABEL				
SERVES	VA	CIR. BKR.	A B C	CIR. #	CIR. BKR.	VA	SERVES		
SPARE	--	20/1	1	16	50/3	--	FUTURE		
SPARE	--	20/1	2	17	50/3	--	LT. POLE		
SPARE	--	20/1	3	18	50/3	--	FUTURE		
SPARE	--	20/1	4	19	50/3	--	LT. POLE		
SPARE	--	20/1	5	20	50/3	--	FUTURE		
SPARE	--	20/1	6	21	50/3	--	LT. POLE		
SPARE	--	20/1	7	22	50/3	--	FUTURE		
SPARE	--	20/1	8	23	50/3	--	LT. POLE		
SPARE	--	20/1	9	24	50/3	--	FUTURE		
SPARE	--	20/1	10	25	50/3	--	LT. POLE		
SPARE	--	20/1	11	26	50/3	--	FUTURE		
SPARE	--	20/1	12	27	50/3	--	LT. POLE		
SPARE	--	20/1	13	28	50/3	--	FUTURE		
SPARE	--	20/1	14	29	50/3	--	LT. POLE		
SPARE	--	20/1	15	30	50/3	--	FUTURE		
TOTAL CONNECTED LOAD: 95,520 VA									

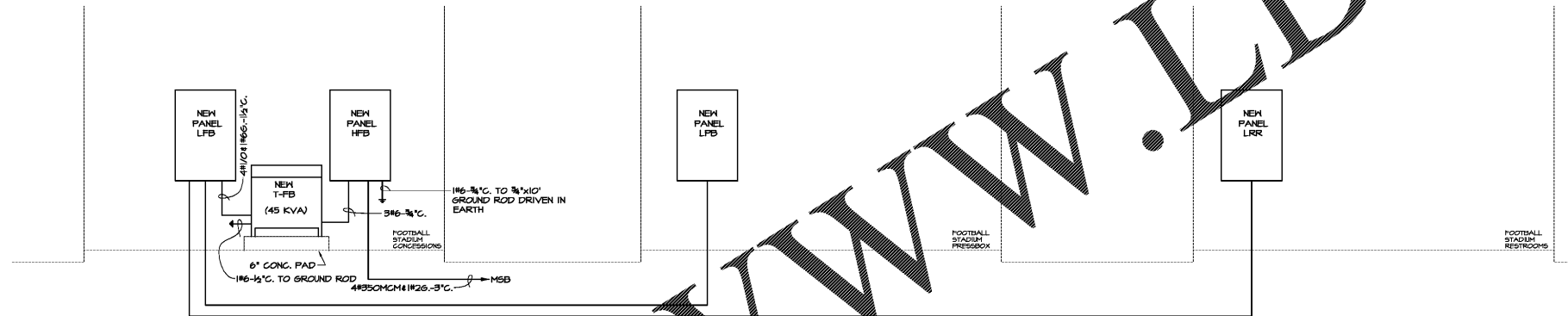

7 FOOTBALL STADIUM - POWER RISER DIAGRAM
ES1.0 NOT TO SCALE

REFERENCED NOTES: (THIS SHEET ONLY)
1. INSTALL RECEPTACLE AT 84" AFF FOR FAN AND SWITCH CIRCUIT WITH SWITCH INSTALLED AT 48" AFF.

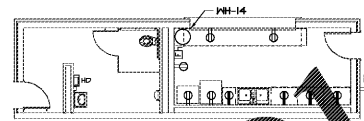

6 FOOTBALL STADIUM - CONCESSIONS - POWER
ES1.0 NOT TO SCALE

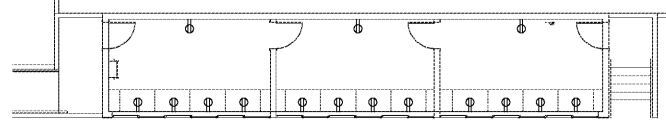

4 FOOTBALL STADIUM - PRESSBOX - POWER
ES1.0 NOT TO SCALE

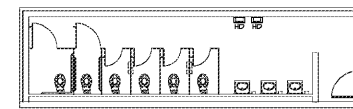

2 FOOTBALL STADIUM - RESTROOMS - POWER
ES1.0 NOT TO SCALE

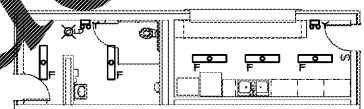

5 FOOTBALL STADIUM - CONCESSIONS - LIGHTING
ES1.0 NOT TO SCALE

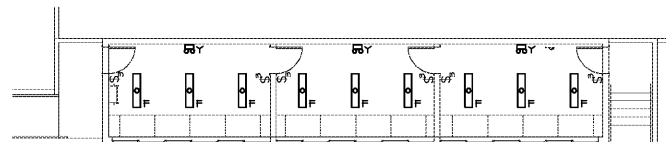

3 FOOTBALL STADIUM - PRESSBOX - LIGHTING
ES1.0 NOT TO SCALE

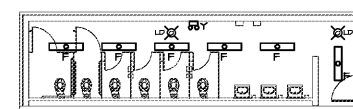

1 FOOTBALL STADIUM - RESTROOMS - LIGHTING
ES1.0 NOT TO SCALE

Order Plans @

CHAPMAN GRIFFIN LANIER SUSSENBACH ARCHITECTS

DOE FACILITY CODE: 660 -3066
**RIVERWOOD HIGH SCHOOL-PHASE 3-8
 AUDITORIUM / GYMNASIUM ADDITION**
 5900 RAIDER DRIVE NW SANDY SPRINGS, GA 30328
 FULTON COUNTY SCHOOLS RFP NO. 411-19

PROJECT NO. 18015.02
 DATE 09/17/18
 DRAWN BY: G.T.R.
 CHECKED BY: B.L.S.

ES-1.01