

Order Plans @ WWW.LDILine.com

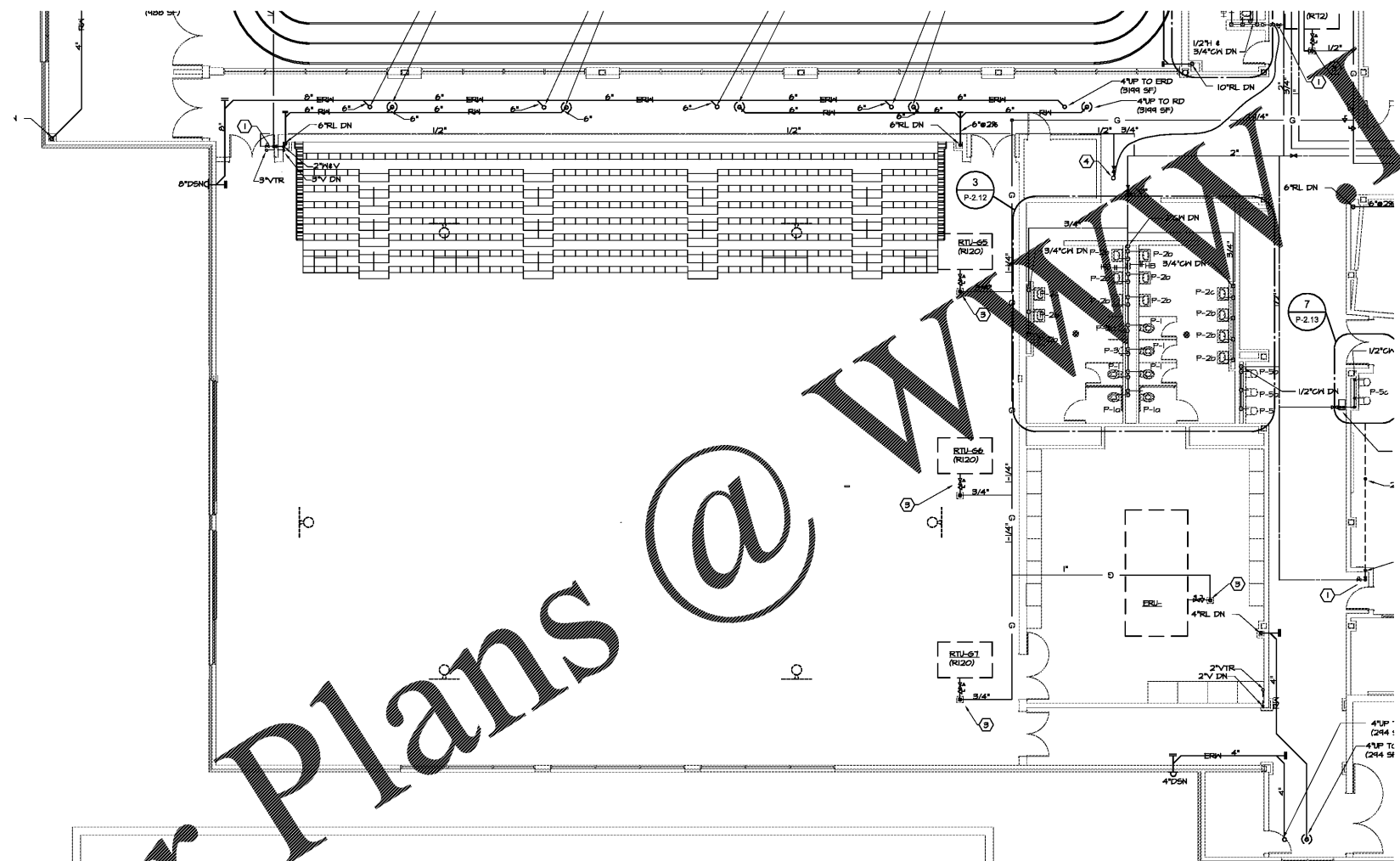

① LEVEL 100 FLOOR PLAN - PART 2- PLUMBING
P-1.22 1/8"=1'-0"

SEE SHEET P-1.II FOR GENERAL AND REFERENCE NOTES

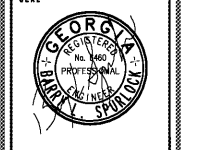
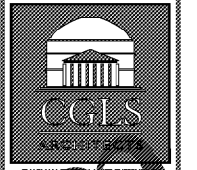
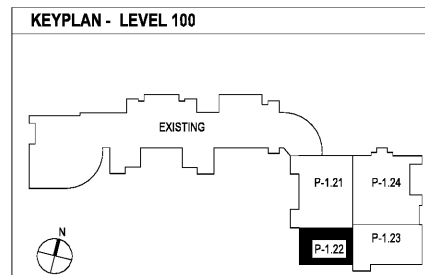

DATE	NO.	DESCRIPTION
03/27/18		ISSUE PRELIMINARY SCHEDULE
06/15/18		ISSUE PRELIMINARY DESIGN DEVELOPMENT DOCUMENTS
08/17/18		ISSUE CHECK-1-SET/ PERMIT SET
10/10/18		FINAL ISSUE SUBMITTAL READY FOR PROPOSAL
02/26/18	A	ADDENDUM NO. 3
04/27/18	A	BULLETIN NO. 1

DOE FACILITY CODE: 660 -3066
**RIVERWOOD HIGH SCHOOL-PHASE 3-8
 AUDITORIUM / GYMNASIUM ADDITION**
 6900 RAIDER DRIVE NW SANDY SPRINGS, GA 30328
 FULTON COUNTY SCHOOLS RFP NO. 411-18

SHEET TITLE	
LEVEL 100 FLOOR PLAN - PART 2- PLUMBING	
PROJECT NO.	18015.02
DATE	09/17/18
DRAWN BY	J.C.F.
CHECKED BY	B.L.S.
SHEET NO.	
P-1.22	

CHAPMAN GRIFFIN LANIER SUSSENBACH ARCHITECTS
 4000 GAMBRIEL PARKWAY, SUITE 100, ATLANTA, GEORGIA 30339 • PHONE: 404.733.5499 • FAX: 404.733.6800
 ARCHITECTS
 PLUMBING
 FACILITIES DESIGN