

CHAPMAN GRIFFIN LANIER SUSENBACH ARCHITECTS
ARCHITECTS
PLANNING
MECHANICAL
ELECTRICAL
PLUMBING

FOR RELEASE
OR CONSTRUCTION
CONSULTANT
SPURLOCK ASSOCIATES, INC.
2970 Clairmont Rd., Suite 620
Atlanta, GA 30329
P: 404.633.0245
F: 404.633.1756

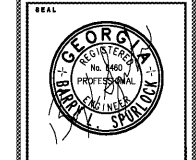

DATE	NO.	DESCRIPTION
03/27/18		ISSUE PRELIMINARY SCHEDULE & DESIGN DEVELOPMENT DOCUMENTS
06/19/18		ISSUE CONSTRUCTION DOCUMENTS
08/17/18		ISSUE CHECKLIST-SCT/PERMIT SET
10/10/18		FINAL CODE SUBMITTAL READY FOR PROPOSAL
11/07/18		

DOE FACILITY CODE: 660 -3066
RIVERWOOD HIGH SCHOOL-PHASE 3-8 AUDITORIUM / GYMNASIUM ADDITION
 6900 RAIDER DRIVE NW SANDY SPRINGS, GA 30328
 FULTON COUNTY SCHOOLS RFP NO. 411-18

SHEET TITLE	
LEVEL 000 FLOOR PLAN-PART 3-PLUMBING	
PROJECT NO.	18015.02
DATE	09/17/18
DRAWN BY	J.C.F.
CHECKED BY	B.L.S.
SHEET NO.	
P-1.13	

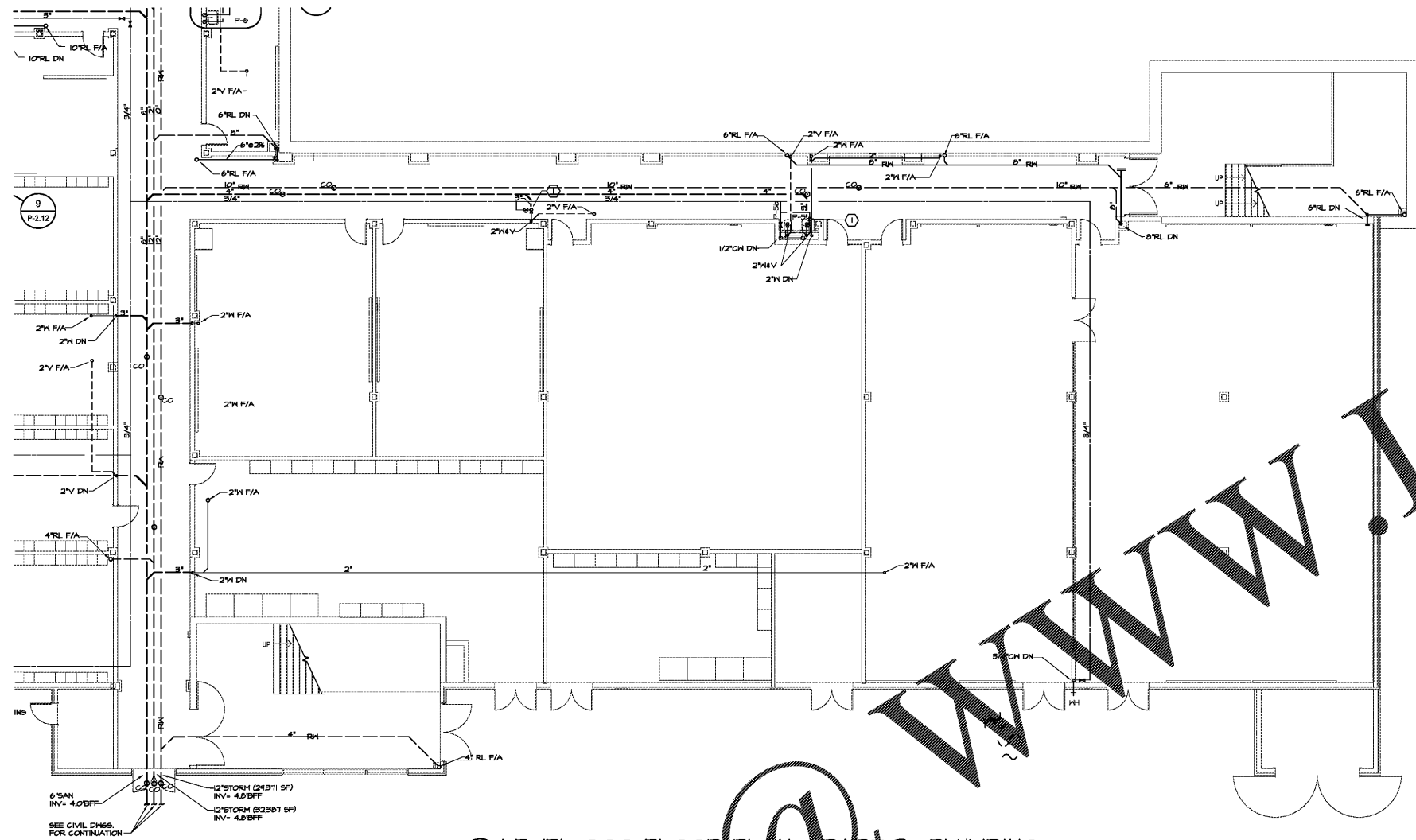

① LEVEL 000 FLOOR PLAN - PART 3- PLUMBING
 P-1.13 1/8"=1'-0"

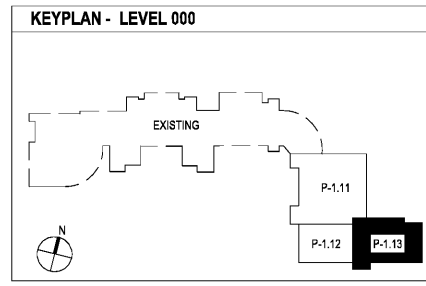

SEE SHEET P-1.11 FOR GENERAL AND REFERENCE NOTES

Order Plans @

WWW.LDILine.COM