

Order Plans @ WWW.LDILine.com

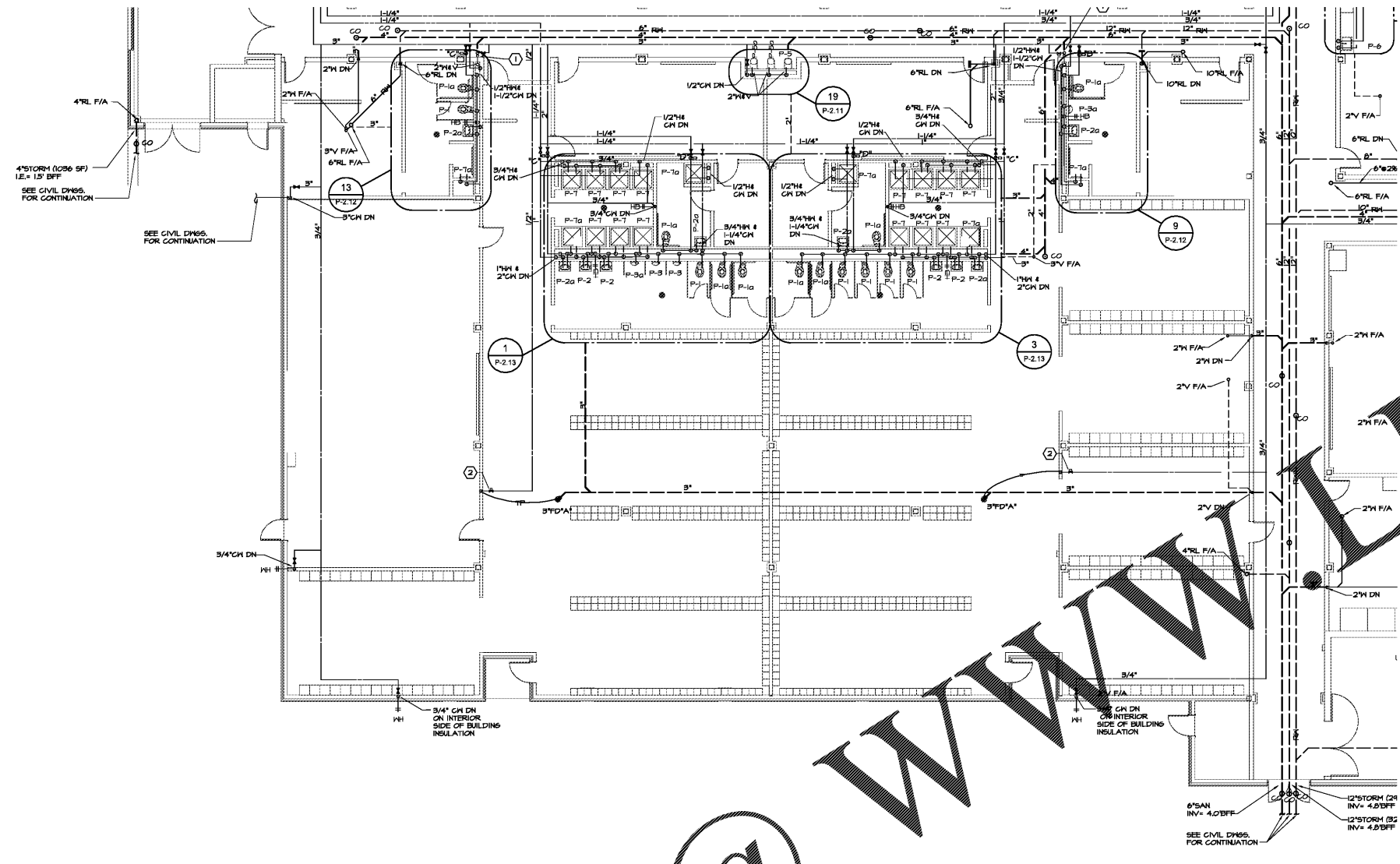

① LEVEL 000 FLOOR PLAN - PART 2- PLUMBING
P-1.12 1/8"=1'-0"

SEE SHEET P-1.11 FOR GENERAL AND REFERENCE NOTES

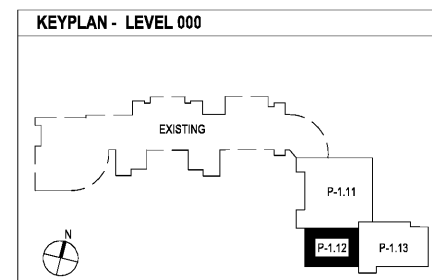

CHAPMAN GRIFFIN LANIER SUSSENBACH ARCHITECTS
 4000 GAMBRIER PARKWAY, SUITE 100 • ATLANTA, GEORGIA 30339 • PHONE: 404.733.5439 • FAX: 404.733.6804

DOE FACILITY CODE: 660 -3066
RIVERWOOD HIGH SCHOOL-PHASE 3-8
AUDITORIUM / GYMNASIUM ADDITION
 6900 RAIDER DRIVE NW SANDY SPRINGS, GA 30328
 FULTON COUNTY SCHOOLS RFP NO. 411-18

ARCHITECT: CHAPMAN GRIFFIN LANIER SUSSENBACH ARCHITECTS
 PREPARED BY: J.C.F.
 CHECKED BY: B.L.S.

RELEASED FOR CONSTRUCTION
 SPURLOCK ASSOCIATES, INC.
 2970 Clairmont Rd., Suite 620
 Atlanta, GA 30329
 P: 404.633.0245
 F: 404.633.1756

SEAL
 STATE OF GEORGIA
 PROFESSIONAL ENGINEER
 No. 460
 PLUMBING
 SPURLOCK

DATE	NO.	DESCRIPTION
03/27/18		ISSUE PRELIMINARY SCHEDULE
06/19/18		DESIGN DEVELOPMENT
08/17/18		ISSUE CONSTRUCTION DOCUMENTS
10/10/18		ISSUE CHECKLIST-SC/ PERMIT SET
11/07/18		FINAL ISSUE SUBMITTAL READY FOR PROPOSAL

SHEET TITLE
 LEVEL 000 FLOOR PLAN- PART 2- PLUMBING

PROJECT NO.
 18015.02

DATE
 09/17/18

DRAWN BY: J.C.F.
 CHECKED BY: B.L.S.

SHEET NO.
P-1.12