

Order Plans @ WWW.LDILine.com

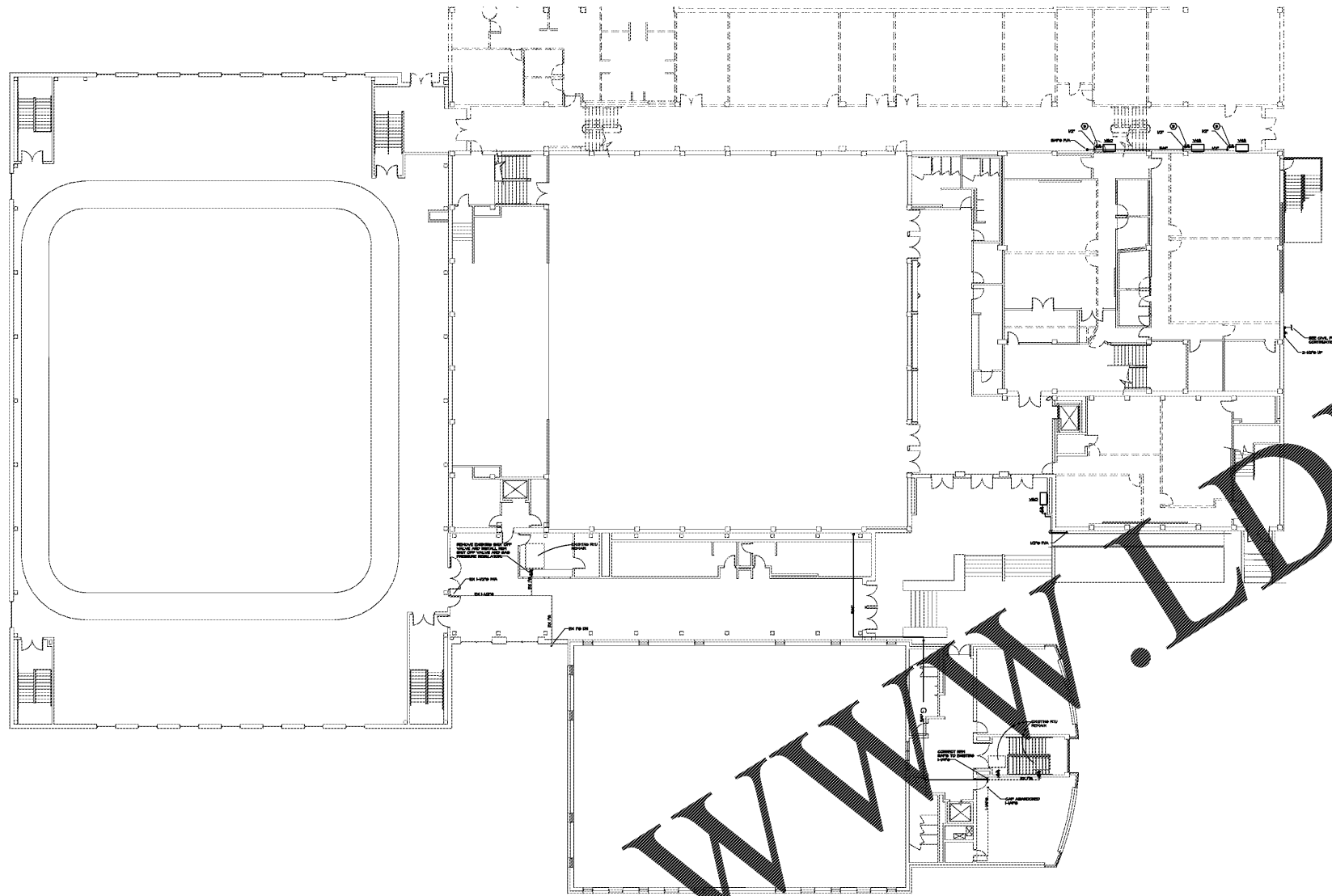

CONTRACT ALUMINUM LIGHT  
FIXTURES TO BE MAINTAINED  
OR DEMOLISHED AS SHOWN

NO.	DESCRIPTION	QTY
1	4' x 4' RECESSED	1
2	4' x 4' RECESSED	1
3	4' x 4' RECESSED	1
4	4' x 4' RECESSED	1
5	4' x 4' RECESSED	1
6	4' x 4' RECESSED	1
7	4' x 4' RECESSED	1
8	4' x 4' RECESSED	1
9	4' x 4' RECESSED	1
10	4' x 4' RECESSED	1
11	4' x 4' RECESSED	1
12	4' x 4' RECESSED	1
13	4' x 4' RECESSED	1
14	4' x 4' RECESSED	1
15	4' x 4' RECESSED	1
16	4' x 4' RECESSED	1
17	4' x 4' RECESSED	1
18	4' x 4' RECESSED	1
19	4' x 4' RECESSED	1
20	4' x 4' RECESSED	1
21	4' x 4' RECESSED	1
22	4' x 4' RECESSED	1
23	4' x 4' RECESSED	1
24	4' x 4' RECESSED	1
25	4' x 4' RECESSED	1
26	4' x 4' RECESSED	1
27	4' x 4' RECESSED	1
28	4' x 4' RECESSED	1
29	4' x 4' RECESSED	1
30	4' x 4' RECESSED	1
31	4' x 4' RECESSED	1
32	4' x 4' RECESSED	1
33	4' x 4' RECESSED	1
34	4' x 4' RECESSED	1
35	4' x 4' RECESSED	1
36	4' x 4' RECESSED	1
37	4' x 4' RECESSED	1
38	4' x 4' RECESSED	1
39	4' x 4' RECESSED	1
40	4' x 4' RECESSED	1
41	4' x 4' RECESSED	1
42	4' x 4' RECESSED	1
43	4' x 4' RECESSED	1
44	4' x 4' RECESSED	1
45	4' x 4' RECESSED	1
46	4' x 4' RECESSED	1
47	4' x 4' RECESSED	1
48	4' x 4' RECESSED	1
49	4' x 4' RECESSED	1
50	4' x 4' RECESSED	1
51	4' x 4' RECESSED	1
52	4' x 4' RECESSED	1
53	4' x 4' RECESSED	1
54	4' x 4' RECESSED	1
55	4' x 4' RECESSED	1
56	4' x 4' RECESSED	1
57	4' x 4' RECESSED	1
58	4' x 4' RECESSED	1
59	4' x 4' RECESSED	1
60	4' x 4' RECESSED	1
61	4' x 4' RECESSED	1
62	4' x 4' RECESSED	1
63	4' x 4' RECESSED	1
64	4' x 4' RECESSED	1
65	4' x 4' RECESSED	1
66	4' x 4' RECESSED	1
67	4' x 4' RECESSED	1
68	4' x 4' RECESSED	1
69	4' x 4' RECESSED	1
70	4' x 4' RECESSED	1
71	4' x 4' RECESSED	1
72	4' x 4' RECESSED	1
73	4' x 4' RECESSED	1
74	4' x 4' RECESSED	1
75	4' x 4' RECESSED	1
76	4' x 4' RECESSED	1
77	4' x 4' RECESSED	1
78	4' x 4' RECESSED	1
79	4' x 4' RECESSED	1
80	4' x 4' RECESSED	1
81	4' x 4' RECESSED	1
82	4' x 4' RECESSED	1
83	4' x 4' RECESSED	1
84	4' x 4' RECESSED	1
85	4' x 4' RECESSED	1
86	4' x 4' RECESSED	1
87	4' x 4' RECESSED	1
88	4' x 4' RECESSED	1
89	4' x 4' RECESSED	1
90	4' x 4' RECESSED	1
91	4' x 4' RECESSED	1
92	4' x 4' RECESSED	1
93	4' x 4' RECESSED	1
94	4' x 4' RECESSED	1
95	4' x 4' RECESSED	1
96	4' x 4' RECESSED	1
97	4' x 4' RECESSED	1
98	4' x 4' RECESSED	1
99	4' x 4' RECESSED	1
100	4' x 4' RECESSED	1

LEVEL 200- EXISTING FLOOR PLAN - DEMO- PLUMBING

SEE SHEET P-1.II FOR GENERAL AND REFERENCE NOTES

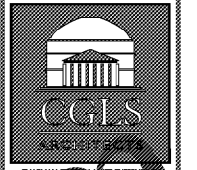

CHAPMAN GRIFFIN LANIER SUSSENBACH ARCHITECTS  
2770 Clairmont Rd., Suite 620  
Atlanta, GA 30329  
P: 404.633.0245  
F: 404.633.1756

FOR RELEASED  
OR CONSTRUCTION  
SUBMITTANT  
**SPURLOCK**  
ASSOCIATES, INC.  
2770 Clairmont Rd., Suite 620  
Atlanta, GA 30329  
P: 404.633.0245  
F: 404.633.1756

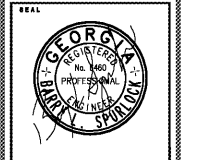

DATE	NO.	DESCRIPTION
03/27/18		ISSUE PRELIMINARY SCHEMATIC / DESIGN DEVELOPMENT
06/18/18		ISSUE CONSTRUCTION DOCUMENTS
08/17/18		ISSUE CHECK - SCHED / PERMIT SET
10/10/18		FINAL ISSUE SUBMITTAL / PERMIT FOR PROPOSAL

CHAPMAN GRIFFIN LANIER SUSSENBACH ARCHITECTS  
600 Grady Drive NW, Suite 100, Atlanta, Georgia 30329 • Phone: 404.733.4299 • Fax: 404.733.4804

DOE FACILITY CODE: 660 -3066  
**RIVERWOOD HIGH SCHOOL-PHASE 3-8  
AUDITORIUM / GYMNASIUM ADDITION**  
6900 RAIDER DRIVE NW SANDY SPRINGS, GA 30328  
FULTON COUNTY SCHOOLS RFP NO. 411-18

SHEET TITLE	LEVEL 200 EXISTING FLOOR PLAN- DEMO- PLUMBING
PROJECT NO.	18015.02
DATE	09/17/18
DESIGNED BY:	J.C.F.
CHECKED BY:	B.L.S.

SHEET NO.  
**DP-1.20**