

1 LEVEL 100 FLOOR PLAN - PART 4- HVAC
 1/8"=1'-0"

KEYPLAN - LEVEL 100

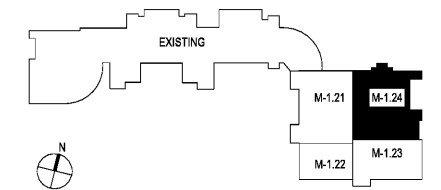

Order Plans @ www.LDILine.com



CHAPMAN GRIFFIN LANIER SUSENBACHA ARCHITECTS
 RELEASED FOR CONSTRUCTION



2970 Clairmont Rd., Suite 420
 Atlanta, GA 30329
 P: 404.633.0245
 F: 404.633.1736

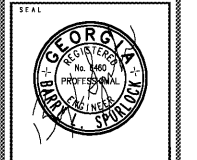

DATE	NO.	DESCRIPTION
03/27/18		ISSUE PRELIMINARY SUBMITTAL
06/14/18		ISSUE DESIGN DEVELOPMENT
08/17/18		ISSUE CONSTRUCTION DOCUMENTS
10/10/18		ISSUE CHECK-SET / PERMIT SET
11/07/18		FINAL ISSUE SUBMITTAL / READY FOR PROPOSAL

DOE FACILITY CODE: 660 -3066
**RIVERWOOD HIGH SCHOOL-PHASE 3-8
 AUDITORIUM / GYMNASIUM ADDITION**
 5900 RAIDER DRIVE NW SANDY SPRINGS, GA 30328
 FULTON COUNTY SCHOOLS RFP NO. 411-18

SHEET TITLE
**LEVEL 100
 FLOOR PLAN-
 PART 4- HVAC**

PROJECT NO.
16015.02
 DATE
09/17/18
 DRAWN BY
CPAMMWD
 CHECKED BY
BLS

SHEET NO.
M-1.24

CHAPMAN GRIFFIN LANIER SUSENBACHA ARCHITECTS
 400 GUNNERS PARKWAY, SUITE 100, ATLANTA, GEORGIA 30339