

Order Plans

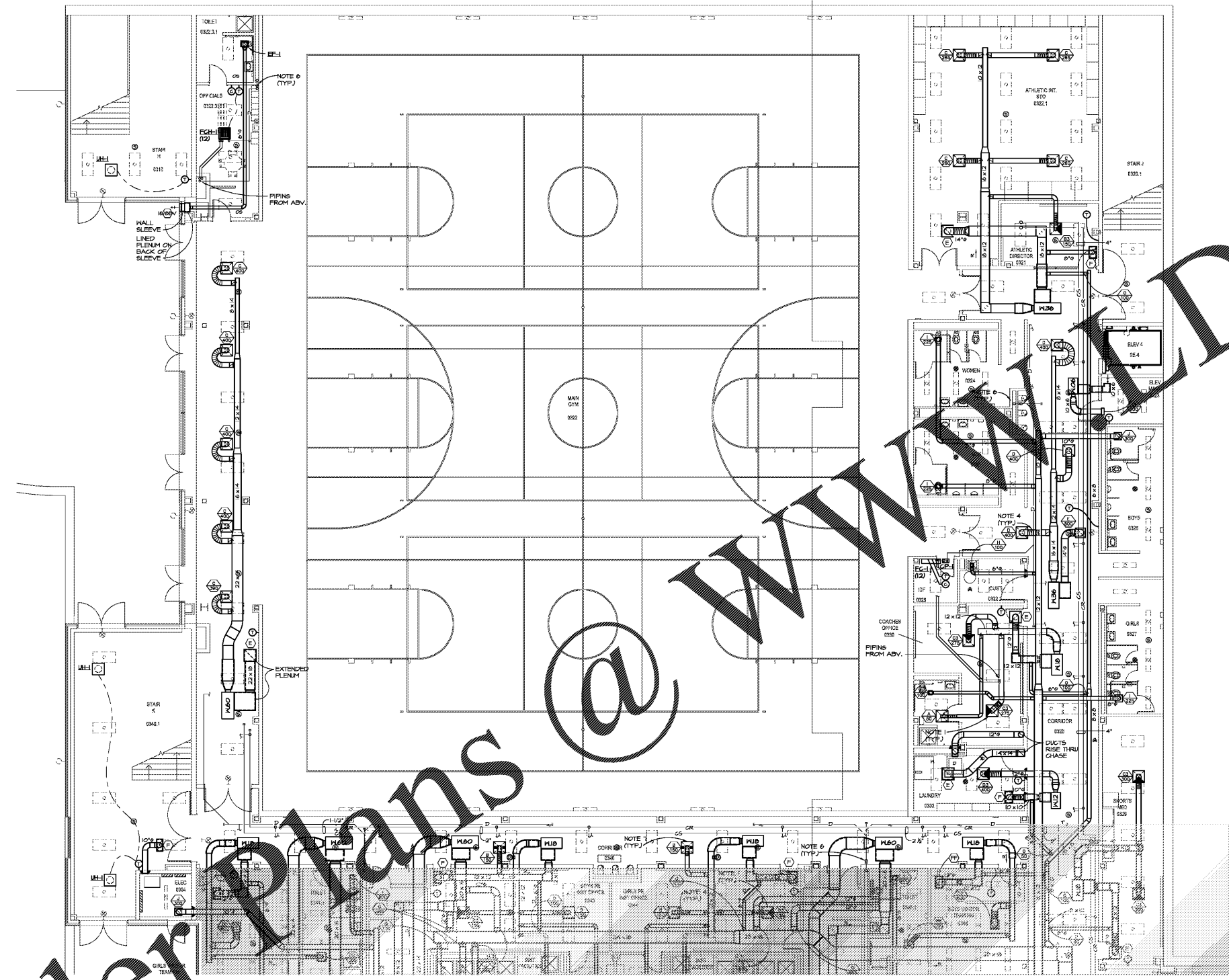

GENERAL NOTES: (ALL MECH. SHEETS)

- A. CONTRACTOR SHALL NOTIFY ENGINEER IN WRITING OF ANY DISCREPANCIES OF EXISTING CONDITIONS FROM THAT SHOWN ON PLANS OR OF ANY CONDITION PREVENTING WORK TO BE INSTALLED AS SHOWN ON PLANS BEFORE WORK IS BEGUN.
- B. ALL PENETRATIONS THROUGH FIRE RATED WALLS, CEILINGS & FLOORS SHALL BE FIRE STOPPED WITH 3M FIRE BARRIER OR EQUAL. PRODUCT MEETING UL 1478 OR ASTM E814 FIRE RATING IN ACCORDANCE WITH ARTICLE 300-21 OF THE NATIONAL ELECTRICAL CODE. SEE ARCHITECTURAL FOR DETAILS.
- C. ALL AREAS OF BUILDING HAVE RETURN AIR PLENUMS ABOVE CEILINGS. ALL MATERIALS EXPOSED WITHIN PLENUMS ARE REQUIRED TO BE NON-COMBUSTIBLE OR SHALL HAVE FLAME SPREAD INDEX OF NOT MORE THAN 25 AND A SMOKE DEVELOPED INDEX OF NOT MORE THAN 50 AS DETERMINED IN ACCORDANCE WITH ASTM E84.
- D. WHERE DUCT LINER IS INDICATED ON THE DRAWINGS THE DUCT SIZES SHOWN ON THE DRAWINGS ARE CLEAR INSIDE DIMENSIONS AFTER THE LINER IS INSTALLED. INCREASE THE SIZE OF THE METAL DUCT TO ALLOW FOR THE LINER.
- E. HVAC IS DESIGNED IN COMPLIANCE WITH 2009 INTERNATIONAL ENERGY CONSERVATION CODE.
- F. ALL EXPOSED DUCTWORK SHALL BE FREE OF DENTS AND SCRATCHES AND LEFT CLEAN FREE OF GREASE, STICKERS AND MASTIC. EXPOSED DUCT JOINTS SHALL BE CONNECTED WITH DUCTMATE OR SPIRALMATE FLANGES WITH INTEGRAL SEALS THAT DO NOT REQUIRE MASTIC.
- G. FLEX ELBOWS ON SUPPLY DIFFUSERS, EXHAUST REGISTERS AND RETURN GRILLES SHALL BE INSTALLED WITH RADIUS EQUAL TO OR GREATER THAN THE DIAMETER OF DUCT. SEE DETAIL 5/M-2.2.
- H. DUCT OPENINGS THRU SHEAR WALLS SHALL BE COMPLETED WITH GENERAL CONTRACTOR.

REFERENCED NOTES: (ALL SHEETS)

- 1. SHADDED DIFFUSER QUADRANT INDICATES 3-MAY DIFFUSER ORIENTED TO BLOW AWAY FROM SHADDED PORTION. TWO QUADRANTS SHADDED INDICATES 2-MAY BLOW. 3 QUADRANTS SHADDED INDICATES 1-MAY BLOW. SEE DETAIL 1/M-2.1.
- 2. RETURN AIR SOUND TRAP, TYPICAL ON ALL GRILLES, SEE DETAIL 2/M-2.2. DUCT TO PLENUM CONNECTION, SEE DETAIL 5/M-2.2.
- 3. INST. FLEX SUPPORT, TYPICAL ON DIFFUSERS AND GRILLES. SEE DETAIL 5/M-2.2.
- 4. INSTALL MSHR, SEE DETAILS 1-4/M-2.1.
- 5. P-TRAP ABOVE CEILING, SEE DETAIL 5/M-2.1.
- 6. INSTALL SMOKE DAMPER IN NECK OF DIFFUSER.
- 7. ELECTRONIC SOLENOID TRAP PRIMER FOR FLOOR DRAINS, SEE PLUMBING AND EHS.
- 8. FIRE DAMPER AT FLOOR, SEE DETAIL 1/M-2.2.
- 9. DROP COLLECTIVE 1" CONDENSATE DRAIN THRU CEILING (PROVIDE ESCHUTCHON PLATE) AND DISCHARGE INTO MOP BASIN ABOVE OVERFLOW LEVEL. SECURE DRAIN LINE TO HALL.
- 10. TRANSITION DUCT TO SIZE NOTED FROM FAN OPENING DOWN TO BOTTOM OF STRUCTURE AND INSTALL 1/4"x1/4" SQUARE GALVANIZED STEEL WIRE WITH ANGLE FRAMING OVER DUCT OPENING.
- 11. SHUT-OFF VALVES AND HOSE-END DRAIN VALVES TO CLEAN PIPING IN PHASES.

LEVEL 000 FLOOR PLAN - PART I- HVAC
M-1.11 1/8"=1'-0"

KEYPLAN - LEVEL 000

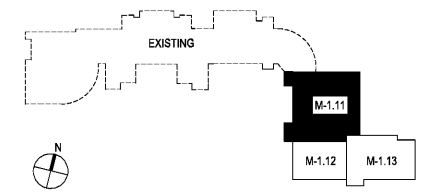

CGIS ARCHITECTS
ARCHITECTS
GRAPHIC REPRESENTATION
2018

RELEASED FOR CONSTRUCTION

SPURLOCK ASSOCIATES INC
2870 Clairmont Rd., Suite 620
Atlanta, GA 30329
P. 404.633.0245
F. 404.633.1756

DATE NO. DESCRIPTION

| | | |
|----------|-----|---|
| 03/27/18 | 002 | PRELIMINARY SUBMITTAL DESIGN DEVELOPMENT |
| 05/18/18 | 003 | CONSTRUCTION SUBMITTAL |
| 09/17/18 | 004 | CHECK-SET/PERMIT SET |
| 10/10/18 | 005 | FINAL COST SUBMITTAL ISSUED FOR PROPOSALS |

DOE FACILITY CODE: 860-3066
RIVERWOOD HIGH SCHOOL-PHASE 3-8 AUDITORIUM / GYMNASIUM ADDITION
5900 RAIDER DRIVE NW SANDY SPRINGS, GA 30328
FULTON COUNTY SCHOOLS REF NO. 411-19

C HAPMAN GRIFFIN LANIER SUSSENBACH ARCHITECTS
4500 Greenfield Pkwy., Suite 100 Atlanta, Georgia 30339 P.A.

SHEET TITLE
LEVEL 000 FLOOR PLAN-PART 1- HVAC

PROJECT NO. 16015.02
DATE 09/17/18
DRAWN BY: CPAM/RD.
CHECKED BY: B.L.S.

SHEET NO. **M-1.11**