

Order Plans @ www.LDILine.com

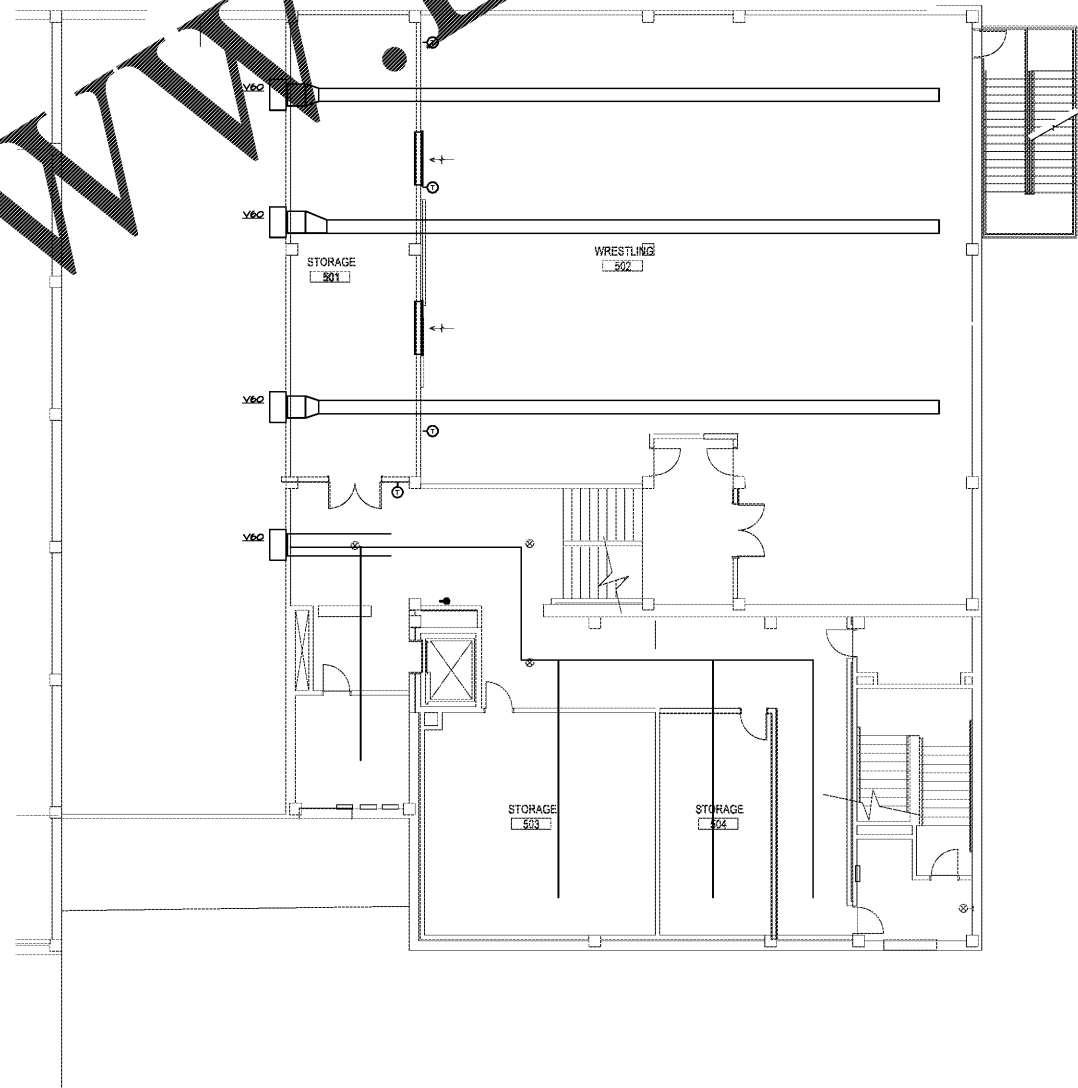

1 LEVEL 300 FLOOR PLAN - HVAC
 DM-1.30 1/8"=1'-0"

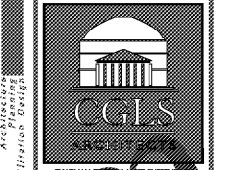

CHAPMAN GRIFFIN LANIER SUSSENBACH ARCHITECTS
 ARCHITECTS
 4000 Peachtree Dunwoody Road, Suite 100
 Atlanta, GA 30328
 P: 404.633.0245
 F: 404.633.1756

REGISTERED PROFESSIONAL ENGINEER
 OR LICENSED ARCHITECT
 FOR CONSTRUCTION

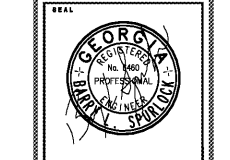

DATE	NO.	DESCRIPTION
03/27/18		ISSUE PRELIMINARY SUBMITTAL
06/19/18		ISSUE PRELIMINARY DESIGN DEVELOPMENT SUBMITTALS
08/17/18		ISSUE CONSTRUCTION DOCUMENTS
09/17/18		ISSUE CHECKLIST-SCT/PERMIT SET
10/10/18		FINAL ISSUE SUBMITTAL
11/07/18		ISSUE FOR PROPOSALS

DOE FACILITY CODE: 660 -3066
RIVERWOOD HIGH SCHOOL-PHASE 3-8 AUDITORIUM / GYMNASIUM ADDITION
 6900 RAIDER DRIVE NW SANDY SPRINGS, GA 30328
 FULTON COUNTY SCHOOLS RFP NO. 411-18

SHEET TITLE	
LEVEL 300 FLOOR PLAN - HVAC	
PROJECT NO.	18015.02
DATE	09/17/18
DRAWN BY	RLM
CHECKED BY	BLS
SHEET NO.	DM-1.30