



Architecture
Planning
Facilitation Design

CHAPMAN GRIFFIN LANIER SUSENBACH ARCHITECTS, INC.
2017

RELEASED FOR CONSTRUCTION

PES STRUCTURAL ENGINEERS
REGISTERED PROFESSIONAL ENGINEER
NO. 00002
11/01/2018

DATE NO. DESCRIPTION
06/18/18 NO. CONSTRUCTION DOCUMENTS
09/17/18 CODE CHECK - SET / PERM. SET
10/18/18 FINL. ISSUE SUBMITTAL ISSUED FOR PROPOSALS
11/01/18

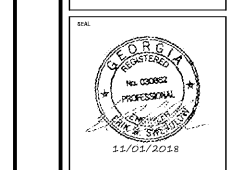

Table with 3 columns: DATE, NO., DESCRIPTION. Contains project milestones and document status.

CHAPMAN GRIFFIN LANIER SUSENBACH ARCHITECTS
DOE FACILITY CODE: 680-3086
RIVERWOOD HIGH SCHOOL - PHASE 3 - AUDITORIUM/GYMNASIUM ADDITION
5900 RAIDER DRIVE NW SANDY SPRINGS, GA 30328
FULTON COUNTY SCHOOLS RFP NO. XXX-XX

FOUNDATION SECTIONS & DETAILS

PROJECT NO. 0217302.00
DATE 09/17/18
DRAWN BY: RAS
CHECKED BY: ACB

S-3.15

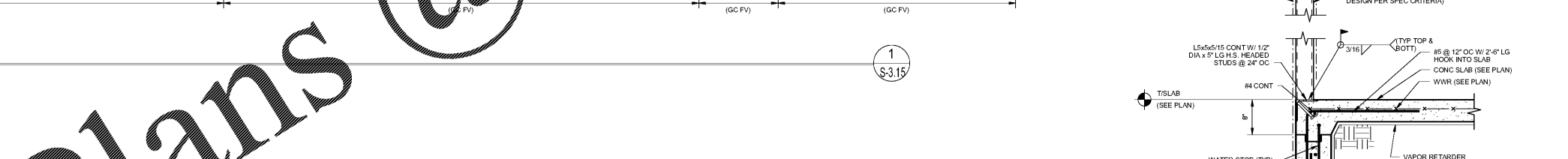
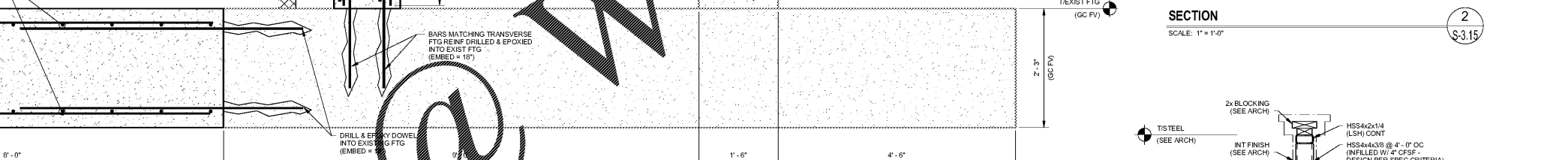
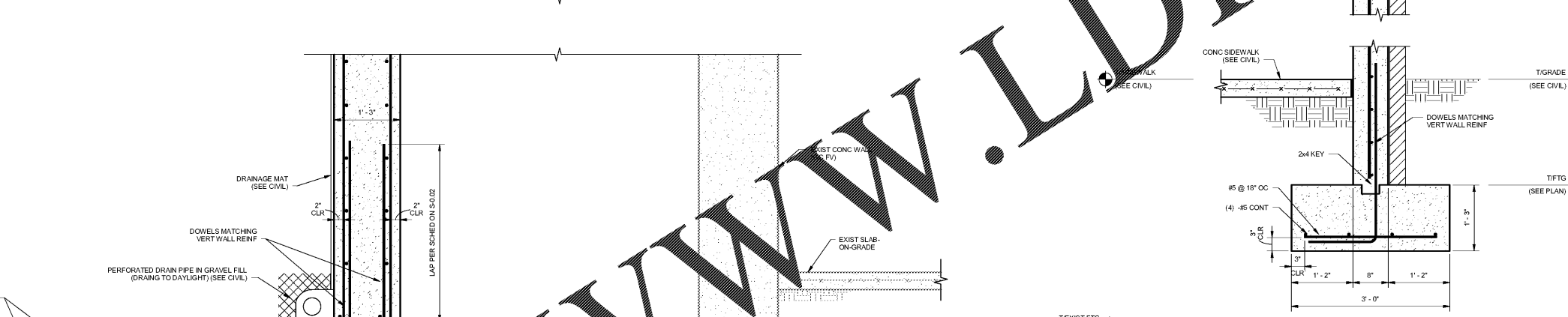
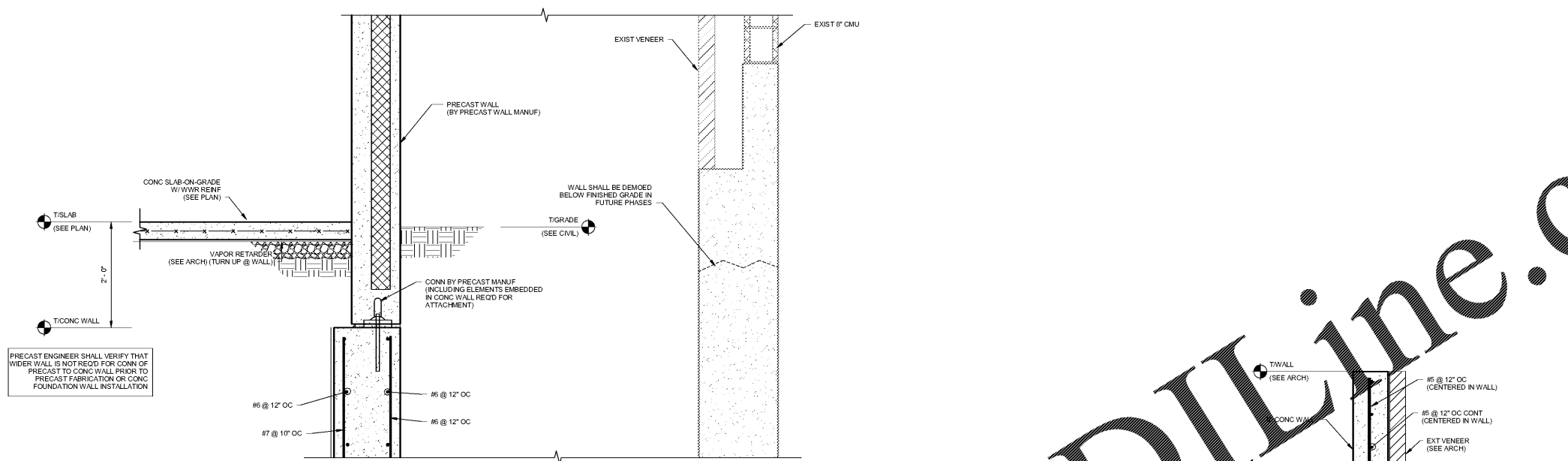

Vertical grid lines: G, F, E, D, C, B, A

Horizontal grid lines: 1, 2, 3, 4, 5, 6, 7, 8, 9

Order Plans

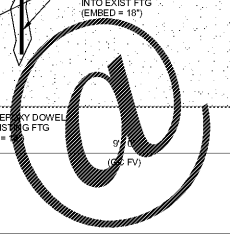

WWW.LDOnline.com