

**LEVEL 000 FOUNDATION PLAN - PART 3**  
 SCALE: 1/8" = 1'-0"

- FOUNDATION PLAN NOTES:**
1. BASE PLATE MARK (SEE 6/S-3.11)
  2. STEEL COLUMN MARK (SEE SCHEDULE ON THIS SHEET)
  3. FOUNDATION MARK (SEE SCHEDULE ON THIS SHEET)
  4. TOP OF FOOTING ELEVATION (#'-#")
  5. P# DENOTES CONCRETE PEDESTAL MARK (SEE 3/S-3.11)
  6. CJ DENOTES SLAB-TO-FOOTING CONTROL POINT (SEE 3/S-3.11). GC SHALL INSTALL CONTROL JOINT FROM ALL CORNERS AND CONTROL POINTS INCLUDING 90° CORNERS OF WALLS DOWN TO FTG. FOLLOW GUIDELINES PROVIDED UNDER 10/S-3.21 FOR SPACING. WHERE CJS TERMINATE @ INT. OF PERPENDICULAR CJ @ INT OF SLAB, INSTALL REINFORCING FEET.
  7. SEE DETAILS 2/S-3.12 AND 12/F-12 FOR STANDARD DETAILS OF TRENCHES ADJACENT TO FOOTINGS AND PIPING PASSING UNDER WALL FOOTINGS. PIPING PASSING UNDER FOOTING MUST BE PLACED AND INSTALLED BEFORE FOOTINGS ARE PREPARED.
  8. GC SHALL COORDINATE PLUMBING AND UTILITIES LOCATIONS WITH FOUNDATION AS NEEDED. ESPECIALLY GC SHALL COORDINATE FOUNDATION ELEVATIONS WITH PLUMBING AND UTILITIES. SUBMIT ANY FOUNDATION LOCATION CHANGE REQUESTS TO STRUCTURAL ENGINEER FOR REVIEW AND APPROVAL.
  9. -# DENOTES STEP IN FOUNDATION (SEE 3/S-3.12)
  10. SEE 4/S-3.12 FOR TYP CONC WALL CORNERS & INTERSECTIONS.
  11. SEE 4/S-3.12 FOR TYP CONC WALL CONTROL & CONSTRUCTION JOINTS.
  12. SEE 4/S-3.12 FOR REIN @ WALL OPENINGS.
  13. SEE 4/S-3.21 FOR ADDITIONAL REIN REQUIRED @ SLAB CORNERS.
  14. STEEL STAIRS (BY STEEL STAIR FABRICATOR/ENGINEER). CMU WALLS @ STAIRS SHALL BE GROUTED SOLID AS NEEDED FOR STEEL STAIR & CANOPY CONNECTIONS. STEEL STAIR FABRICATION SHALL COORDINATE WITH GC ARCHITECT IF STEEL STAIRS ARE TO BE USED TO SUPPORT STAIR LANDING FOR LOCK COORDINATION. SEE 10/S-3.21 FOR TYP THICKNESS SLAB TO BE SUPPORTED.
  15. #SW# DENOTES CMU SHEAR WALL (SEE S-3.31). THE FIRST # DENOTES CMU THICKNESS.
  16. // DENOTES DEPRESSED SLAB (SEE 2/S-3.21). GC TO COORDINATE EXACT LOCATIONS AND EXTENTS OF ALL SLAB DEPRESSIONS WITH ARCH DRAWINGS.
  17. AT NOISE CRITICAL SPACES, CMU WALLS SHALL BE GROUTED SOLID. SEE ARCH FOR NOISE CRITICAL CMU WALL LOCATIONS AND EXTENTS.
  18. PRECAST COL BY PRECAST MANUF. PRECAST COL CONN TO T/C CONC PIER, INCLUDING ELEMENTS EMBEDDED INTO T/PIER BY PRECAST MANUF.
  19. GC SHALL COORDINATE SLOPING OF SLAB ON GRADE WITH ARCH DRAWINGS. SLOPING SLAB ON GRADE SHALL MAINTAIN 4" SLAB THICKNESS.
  20. // DENOTES PRECAST CONC WALL BY PRECAST CONC WALL MANUF.

**STRUCTURAL FOUNDATION SCHEDULE**

MARK	LENGTH	WIDTH	THICKNESS	BOTTOM REINFORCEMENT	TOP REINFORCEMENT
F5	5'-0"	9'-0"	1'-3"	(6) - #6 EW	-
F5A	5'-0"	5'-0"	1'-3"	(6) - #6 EW	(6) - #6 EW
F5B	5'-0"	5'-0"	3'-0"	SEE 3/S-3.14 FOR REIN	SEE 3/S-3.14 FOR REIN
F6	6'-0"	6'-0"	1'-0"	(7) - #6 EW	-
F6A	6'-0"	6'-0"	1'-0"	(7) - #6 EW	(7) - #6 EW
F7	7'-0"	7'-0"	1'-0"	(8) - #6 EW	-
F7A	7'-0"	7'-0"	1'-0"	(8) - #6 EW	(8) - #6 EW
F8	8'-0"	8'-0"	1'-0"	(9) - #6 EW	-
F8A	8'-0"	8'-0"	1'-0"	(9) - #6 EW	(9) - #6 EW
F8A15A	13'-0"	8'-0"	1'-0"	(9) - #6 LW; (16) - #6 SW	(9) - #6 LW; (16) - #6 SW
F8A15A	15'-0"	8'-0"	1'-0"	(9) - #6 LW; (16) - #6 SW	(9) - #6 LW; (16) - #6 SW
F9	9'-0"	9'-0"	1'-0"	(10) - #6 EW	-
F9A	9'-0"	9'-0"	1'-0"	(10) - #6 EW	(10) - #6 EW
F10	10'-0"	10'-0"	1'-0"	(11) - #6 EW	-
F10A	10'-0"	10'-0"	1'-0"	(11) - #6 EW	(11) - #6 EW
F11	11'-0"	11'-0"	2'-0"	(12) - #6 EW	-
F11A	11'-0"	11'-0"	2'-0"	(12) - #7 EW	(12) - #7 EW
F12	12'-0"	12'-0"	2'-0"	(12) - #6 EW	-
F12A	13'-0"	13'-0"	1'-0"	(14) - #7 EW	(14) - #7 EW
F13A	13'-0"	13'-0"	2'-0"	(16) - #7	(16) - #7
F13A	15'-0"	13'-0"	1'-0"	(14) - #7 LW; (16) - #7 SW	(14) - #7 LW; (16) - #7 SW
F13A13A	15'-0"	13'-0"	1'-0"	(14) - #7 LW; (16) - #7 SW	(14) - #7 LW; (16) - #7 SW

**STRUCTURAL COLUMN SCHEDULE**

MARK	SIZE
C1	HSS8x8x1/4
C2	HSS8x8x1/6
C3	HSS8x8x3/8
C4	HSS8x8x1/2
C5	HSS8x8x3/8
C6	HSS10x8x3/8
C7	HSS12x8x3/8
C8	HSS12x10x1/2
C9	HSS10x10x3/8
C10	HSS8x8x3/8
C11	HSS14x10x3/8
C12	W14x156

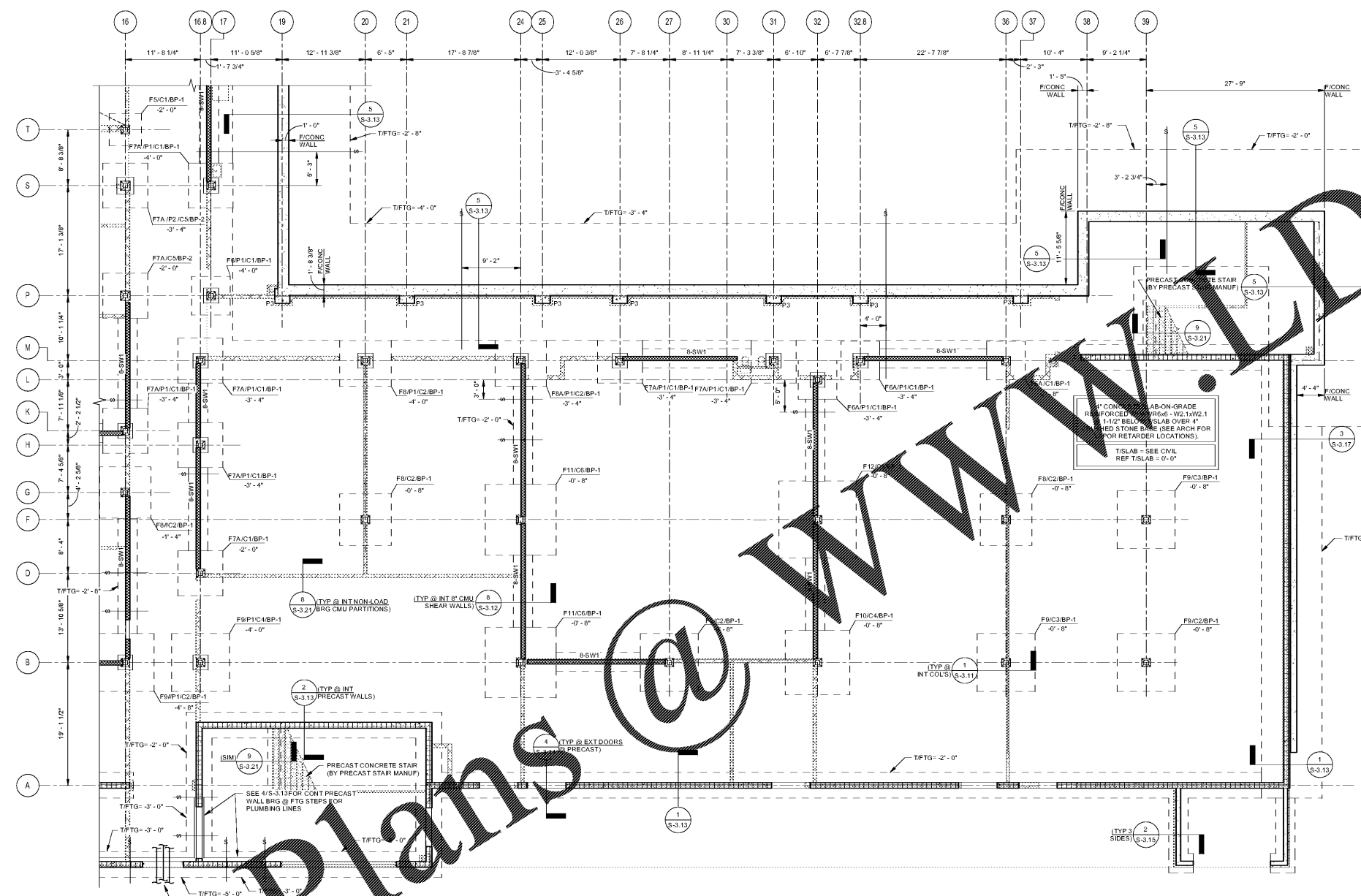

Order Plans @ [www.alldivine.com](http://www.alldivine.com)