

LEVEL 100 OVERALL FOUNDATION & FLOOR FRAMING PLAN

SCALE: 1/16" = 1'-0"

1
S-2.01

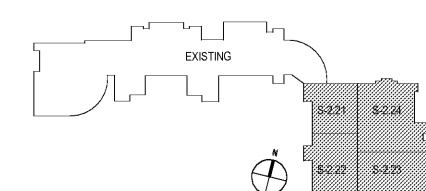

CHAPMAN GRIFFIN LANIER SUSSENBACH ARCHITECTS
2500 Cumberland Pkwy., Atlanta, Ga 30339 Phone: 404.733.5493

DOE FACILITY CODE: 680-3086
RIVERWOOD HIGH SCHOOL - PHASE 3 - AUDITORIUM/GYMNASIUM ADDITION
5900 RAIDER DRIVE NW SANDY SPRINGS, GA 30328
FULTON COUNTY SCHOOLS RFP NO. XXX-XX

LEVEL 100 OVERALL FOUNDATION & FLOOR FRAMING PLAN

PROJECT NO. 0217302.00

DATE: 09/17/18

DRAWN BY: RAS
CHECKED BY: ACS

SHEET NO. S-2.01



CHAPMAN GRIFFIN LANIER SUSSENBACH ARCHITECTS

RELEASED FOR CONSTRUCTION



REGISTERED PROFESSIONAL ENGINEER

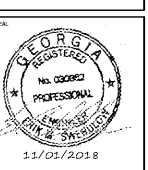

DATE	NO.	DESCRIPTION
06/18/18		SIZE CONSTRUCTION DOCUMENTS
09/17/18		DOE CHECK-SEAL PERMIT SET
10/18/18		FINAL ISSUE SUBMITTAL ISSUED FOR PROPOSALS
11/01/18		