

MATCHLINE  
1 / A-9.21

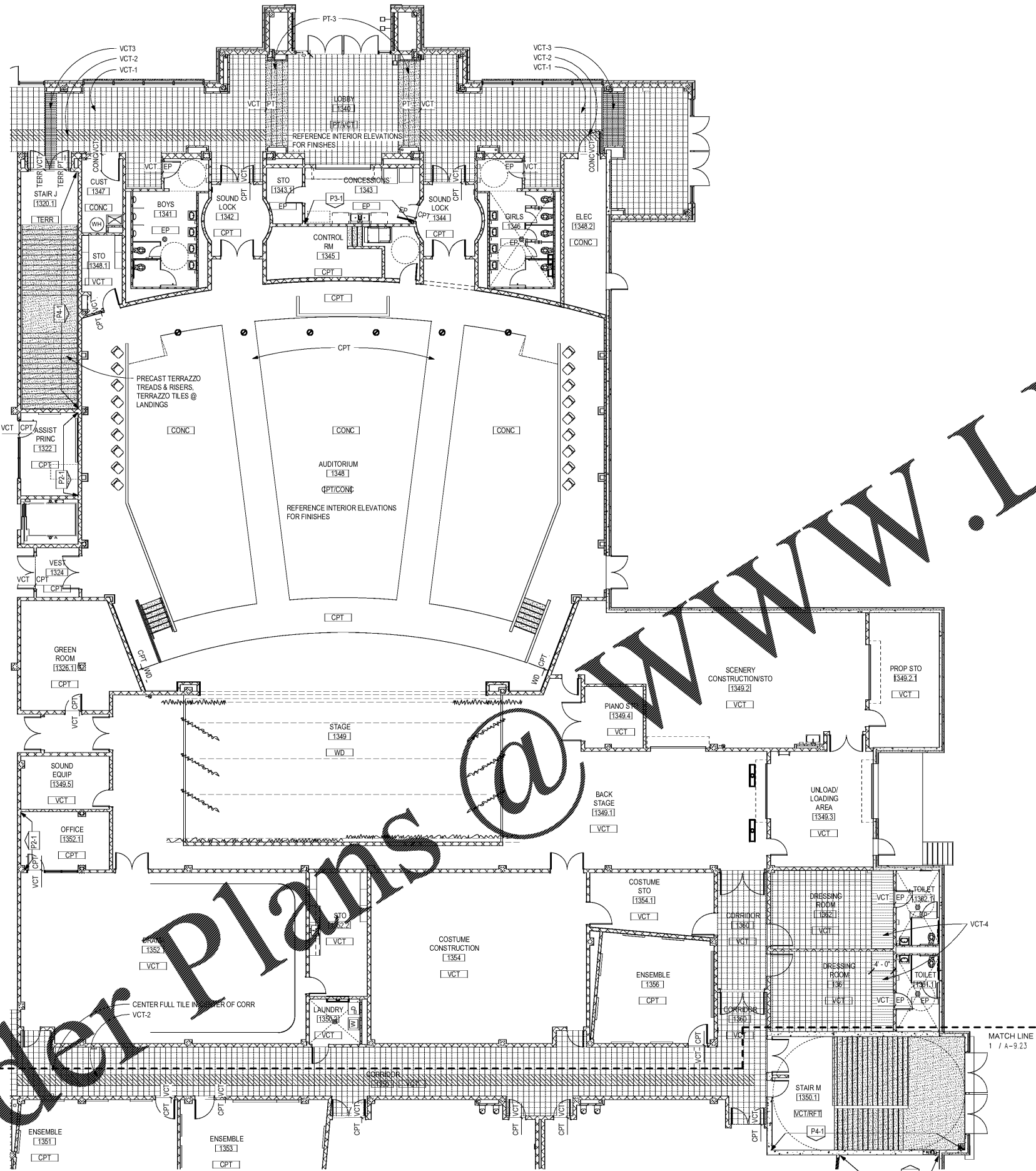

1 LEVEL 100 FINISH PLAN - PART 4  
1/8" = 1'-0"

**FINISH NOTES**

1. ALL VCT FLOORS TO BE VCT-1 UNO.
2. ALL CPT FLOOR TO BE CPT-1 UNO.
3. ALL WALLS TO BE P1-1 UNO.
4. ALL FLOOR PARTS TO BEGIN CENTER / CENTER UNO.
5. PROVIDE TRANSITIONS BETWEEN ADJACENT FLOOR FINISHES AS INDICATED IN SILL DETAILS ON SHEET A-8.30.
6. SEE FINISH SCHEDULE IN SPECIFICATION APPENDIX A FOR LOCATIONS OF EPOXY PAINT.
7. ALL CLASSROOM VCT TO ALIGN WITH VCT IN ADJOINING CORRIDOR.
8. PROVIDE METAL EDGE STRIPS AT TRANSITIONS BETWEEN EPOXY FLOORING & VCT.
9. AT DRAMA CLASSROOM, STAGE, BACK STAGE & UNLOADING/LOADING AREA - PAINT ALL WALLS & CEILING UNDERSIDE OF STRUCTURE BLACK. PROVIDE BLACK VCT @ FLOOR FINISH EXCEPT WHERE WOOD IS INDICATED.

**FLOORING NOTES**

CONC	SEALED CONCRETE	MT	MARBLE THRESHOLD
CPT	CARPET	PT	PORCELAIN TILE
ESD	ELECTRO STATIC	RFT	RUBBER FLOOR TILE
EP	DISSIPATIVE TILE	TERR	PRECAST TERRAZZO / TERRAZZO TILE
	EPOXY	VCT	VINYL COMPOSITION TILE
		RAS	RESILIENT ATHLETIC SURFACING

**WALL NOTES**

CWT	CERAMIC WALL TILE
P	PAINT

**PAINT SYSTEM LEGEND**

-1	EGGSHELL	PAINT SYSTEM PAINT COLOR (REFERENCE FINISH LIST FOR TYPE)
-2	FLAT (CEILING ONLY)	
-3	SEMI-GLOSS (STANDARD)	
-4	HIGH-GLOSS	
-5	ALKYD FOR CMU	

**KEYPLAN**

CHAPMAN GRIFFIN LANIER SUSSENBACH ARCHITECTS  
 400 Galleria Pkwy., Suite 100 Atlanta, Ga 30339 Phone: 404.733.5493

CHAPMAN GRIFFIN LANIER SUSSENBACH ARCHITECTS  
 CHAPMAN GRIFFIN LANIER SUSSENBACH ARCHITECTS INC.  
 2018

RELEASED FOR CONSTRUCTION

DATE NO. DESCRIPTION  
 01/27/18 100 PRELIMINARY SUBMITTAL DESIGN DEVELOPMENT  
 01/19/18 100 CONSTRUCTION DOCUMENTS  
 09/17/18 100 CHECK - SET / PERMIT SET  
 10/10/18 100 FINAL GDC SUBMITTAL ISSUED FOR PROPOSAL

DOE FACILITY CODE: 660-3066  
 RIVERWOOD HIGH SCHOOL PHASE 3-8 AUDITORIUM/GYMNASIUM ADDITION  
 5900 RAIDER DRIVE NW SANDY SPRINGS, GA 30328  
 FULTON COUNTY SCHOOLS RFP NO. 411-19

SHEET TITLE  
**LEVEL 100 FINISH PLAN - PART 4**

PROJECT NO. 16015.02  
 DATE 09/17/18  
 DRAWN BY: Author  
 CHECKED BY: Checker  
 SHEET NO.

**A-9.24**

Order Plans @ www.LDILine.com