

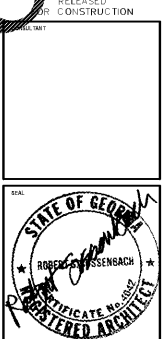

CHAPMAN GRIFIN LANIER SUSENBACH ARCHITECTS
 REGISTERED ARCHITECT



DATE	NO.	DESCRIPTION
01/27/18	1	SCHEMATIC DESIGN DEVELOPMENT
02/19/18	2	SCHEMATIC DESIGN DEVELOPMENT
02/17/18	3	SCHEMATIC DESIGN DEVELOPMENT
02/18/18	4	SCHEMATIC DESIGN DEVELOPMENT
02/18/18	5	SCHEMATIC DESIGN DEVELOPMENT

DOE FACILITY CODE: 660-3086
 RIVERWOOD HIGH SCHOOL PHASE 3-8
 AUDITORIUM/GYMNASIUM ADDITION
 5900 RAIDER DRIVE NW SANDY SPRINGS, GA 30328
 FULTON COUNTY SCHOOLS RFP NO. 411-19

ARCHITECTURAL
 SITE PLAN

PROJECT NO. 16015.02
 DATE 09/17/18
 DRAWN BY: Author
 CHECKED BY: Checker
 ARCHITECT: AS-1.00

CHAPMAN GRIFIN LANIER SUSENBACH ARCHITECTS
 400 Galleria Pkwy., Suite 100 Atlanta, Ga 30339 Phone: 404.733.5493

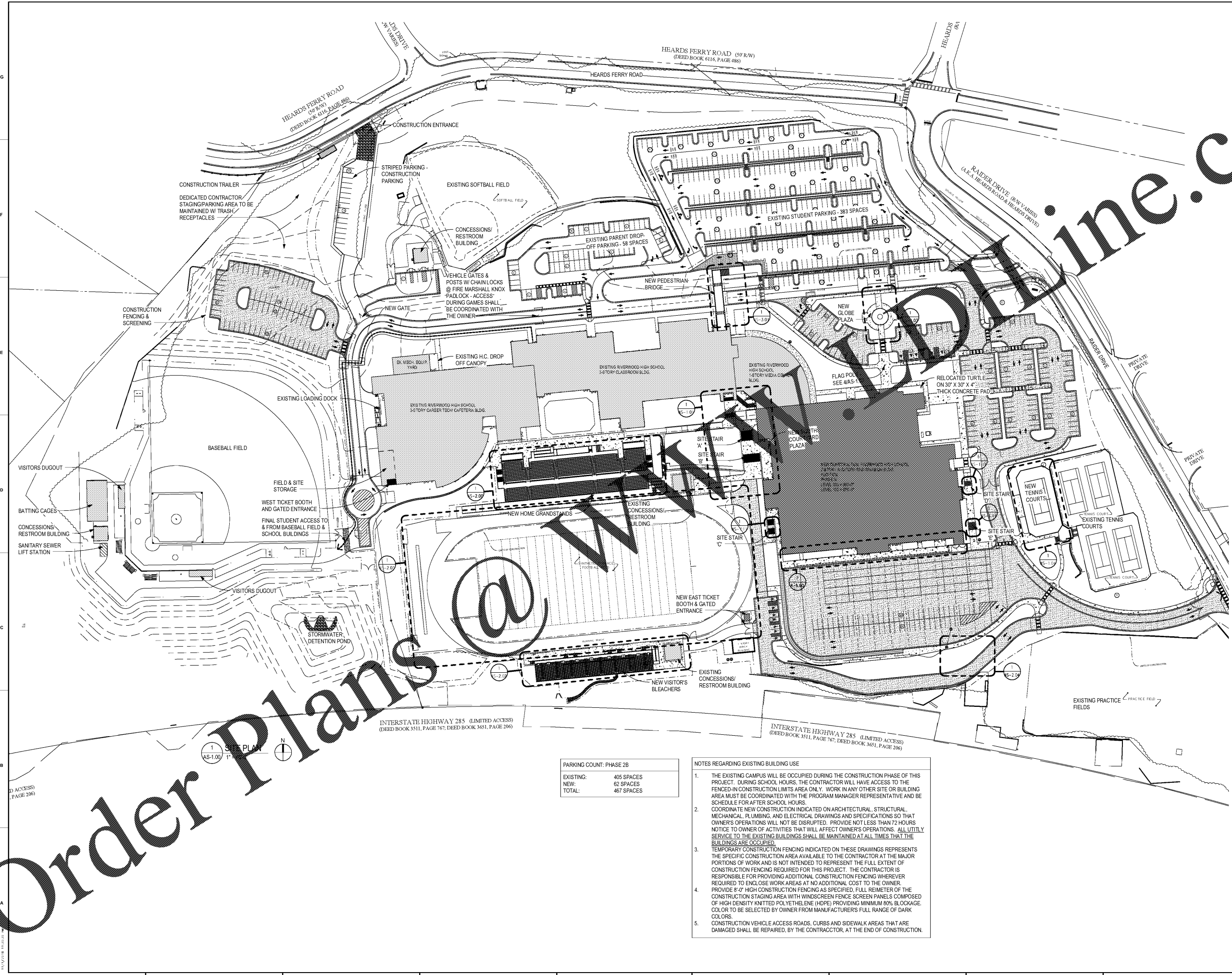

PARKING COUNT: PHASE 2B

EXISTING:	405 SPACES
NEW:	62 SPACES
TOTAL:	467 SPACES

- NOTES REGARDING EXISTING BUILDING USE
1. THE EXISTING CAMPUS WILL BE OCCUPIED DURING THE CONSTRUCTION PHASE OF THIS PROJECT. DURING SCHOOL HOURS, THE CONTRACTOR WILL HAVE ACCESS TO THE FENCED-IN CONSTRUCTION LIMITS AREA ONLY. WORK IN ANY OTHER SITE OR BUILDING AREA MUST BE COORDINATED WITH THE PROGRAM MANAGER REPRESENTATIVE AND BE SCHEDULED FOR AFTER SCHOOL HOURS.
 2. COORDINATE NEW CONSTRUCTION INDICATED ON ARCHITECTURAL, STRUCTURAL, MECHANICAL, PLUMBING, AND ELECTRICAL DRAWINGS AND SPECIFICATIONS SO THAT OWNER'S OPERATIONS WILL NOT BE DISRUPTED. PROVIDE NOT LESS THAN 72 HOURS NOTICE TO OWNER OF ACTIVITIES THAT WILL AFFECT OWNER'S OPERATIONS. ALL UTILITY SERVICE TO THE EXISTING BUILDINGS SHALL BE MAINTAINED AT ALL TIMES THAT THE BUILDINGS ARE OCCUPIED.
 3. TEMPORARY CONSTRUCTION FENCING INDICATED ON THESE DRAWINGS REPRESENTS THE SPECIFIC CONSTRUCTION AREA AVAILABLE TO THE CONTRACTOR AT THE MAJOR PORTIONS OF WORK AND IS NOT INTENDED TO REPRESENT THE FULL EXTENT OF CONSTRUCTION FENCING REQUIRED FOR THIS PROJECT. THE CONTRACTOR IS RESPONSIBLE FOR PROVIDING ADDITIONAL CONSTRUCTION FENCING WHEREVER REQUIRED TO ENCLOSE WORK AREAS AT NO ADDITIONAL COST TO THE OWNER. PROVIDE 8'-0" HIGH CONSTRUCTION FENCING AS SPECIFIED. FULL PERIMETER OF THE CONSTRUCTION STAGING AREA WITH WINDSCREEN FENCE SCREEN PANELS COMPOSED OF HIGH DENSITY KNITTED POLYETHYLENE (HDPE) PROVIDING MINIMUM 80% BLOCKAGE. COLOR TO BE SELECTED BY OWNER FROM MANUFACTURER'S FULL RANGE OF DARK COLORS.
 4. CONSTRUCTION VEHICLE ACCESS ROADS, CURBS AND SIDEWALK AREAS THAT ARE DAMAGED SHALL BE REPAIRED, BY THE CONTRACTOR, AT THE END OF CONSTRUCTION.

Order Plans @ www.pdfline.com