

Order Plans

WWW.LDILLING.COM

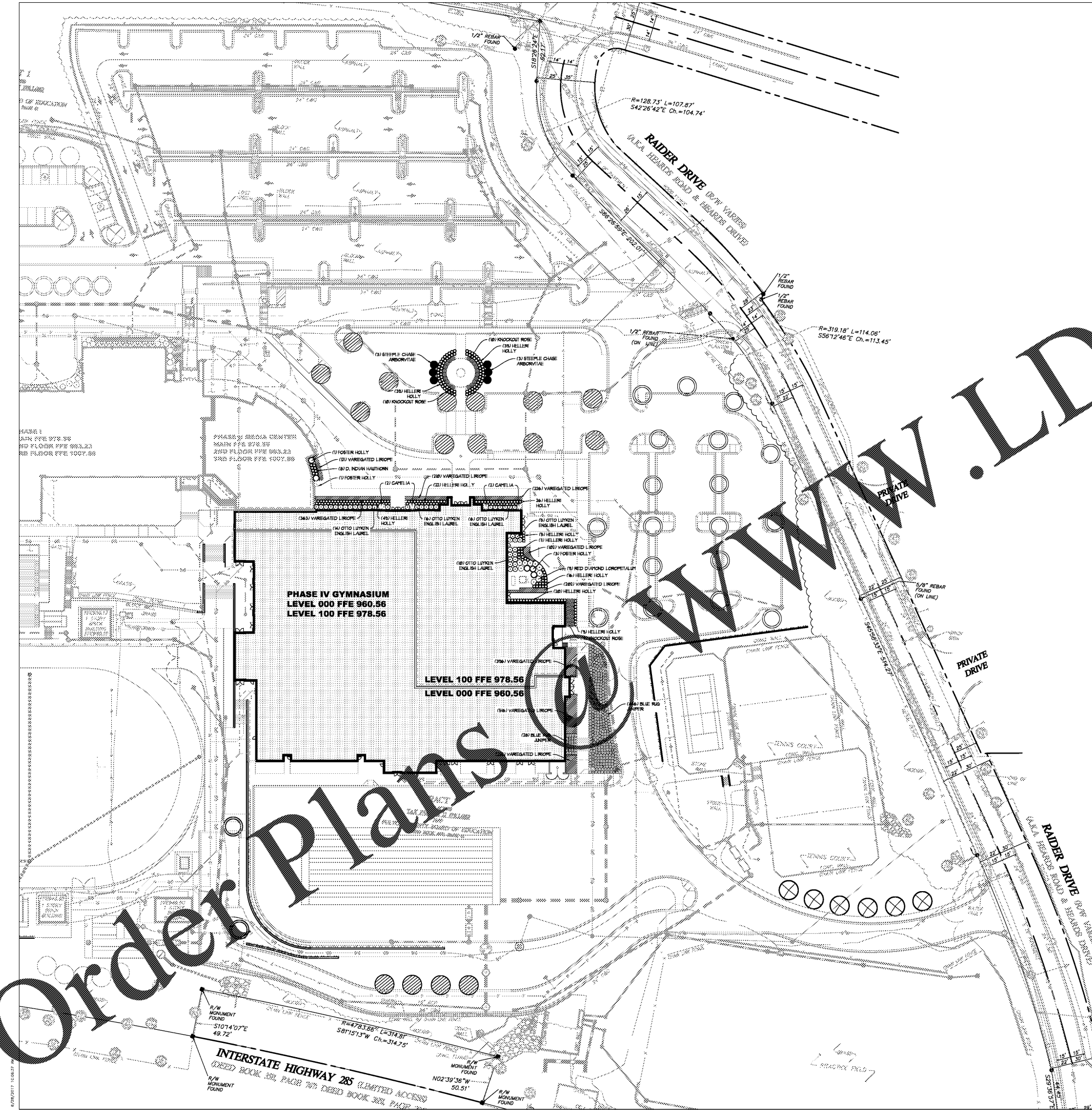

PLANT MATERIAL SCHEDULE

EVERGREEN TREES	BOTANICAL NAME	COMMON NAME	QUANTITY	SIZE	CONDITION	REMARKS
	TAXUS X STEEPLECHASE	STEEPLECHASE AMBORVITAE	8	8" TALL	B4B	REFER TO PLANS FOR SPACING
	LEX X FOSTER '9'	FOSTER HOLLY	9	8" TALL	B4B	REFER TO PLANS FOR SPACING

BRUBS	CAPPELLA SANGRIA	CAPELLA	4	1" CONT.	CONT.	REFER TO PLANS FOR SPACING
	REMPALCENS INDICA	D. INDIAN HAZEL	8	1" CONT.	CONT.	3/8" O.C.
	LEX CREMATA 'ELLER'	HELLER HOLLY	236	1" CONT.	CONT.	3/8" O.C.
	JANETUS HORIZONTALIS 'MILTON'	BLUE RAG JAFFER	414	1" CONT.	CONT.	3/8" O.C.
	ROSA X 'MAGNIFY'	KNOCK OUT ROSE	24	1" CONT.	CONT.	1/4" O.C.
	PRUNUS LAUROCERASUS 'OTTO LUYKEN'	OTTO LUYKEN LAUREL	4	1" CONT.	CONT.	1/4" O.C.
	LOREPETALUM CHINENSE 'SHANG-RED'	RED DIAMOND LOREPETALUM	9	1" CONT.	CONT.	1/4" O.C.

GROUNDCOVERS	LIROPE MUSCARE VAREGATA	VAREGATED LIROPE	2338	1/4"	CONT.	1" O.C.
--------------	-------------------------	------------------	------	------	-------	---------

PLANTING NOTES

1. PLANT MATERIALS SHALL MEET MINIMUM REQUIREMENTS AS SET FORTH IN THE LATEST EDITION OF AMERICAN STANDARD FOR NURSERY STOCK AND DISEASES.
2. PLANTS SHALL BE HEALTHY, VIGOROUS SPECIMENS FREE OF DISEASES AND DISEASES.
3. PLANTS ARE SUBJECT TO THE APPROVAL OF THE ARCHITECT OR OWNER BEFORE DURING AND AFTER INSTALLATION.
4. DO NOT ALLOW AIR POCKETS TO FORM WHEN BACKFILLING.
5. DO NOT BREAK ROOTS.
6. IMMEDIATELY WATER PLANTS WITH WATER.
7. BRACKS TREE SPECIALLY WATER PLANTING AS INDICATED IN DETAILS OR AS DIRECTED BY THE ARCHITECT.
8. CONTRACTOR SHALL BE RESPONSIBLE FOR MAINTENANCE INCLUDING WATERING, WEEDING, TRUNK PROTECTANT THROUGHOUT THE PROJECT. MAINTENANCE SHALL BE PERFORMED AS SPECIFIED ON UNITS, NOTES, AND SPECIFICATIONS.
9. THE CONTRACTOR SHALL VERIFY THE UNDERGROUND UTILITIES AND SHALL RELOCATE OR MARK BEFORE COMMENCING DIGGING OPERATIONS.
10. CONTRACTOR SHALL FULLY GUARANTEE PLANTS FOR THIS JOB FOR PERIOD OF ONE (1) YEAR BEGINNING ON THE DATE OF ACCEPTANCE.
11. CONTRACTOR SHALL BE RESPONSIBLE FOR HESHER CAN TAKEOFF QUANTITIES AND REPORT ANY DISCREPANCIES TO THE ARCHITECT.
12. CONTRACTOR SHALL FLAG LOCATION OF PLANT MATERIAL FOR APPROVAL BY ARCHITECT BEFORE INSTALLATION.
13. PLANT BEDS SHALL BE MULCHED WITH A MINIMUM OF 3" OF CLEAN FRESH PINE STRAW.
14. AREAS DESIGNATED AS FLOWER BEDS SHALL RECEIVE 2" OF FINE BARK MULCH.
15. PLANTING MIXTURE SHALL BE PER SPECIFICATIONS.

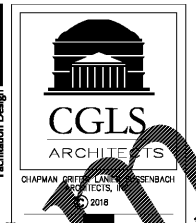

RELEASED FOR CONSTRUCTION

BREED LOVE LAND PLANNING

REGISTERED PROFESSIONAL LANDSCAPE ARCHITECT

STATE OF GEORGIA

12/02/2018

DATE	NO.	DESCRIPTION
03/28/18		CODE PRELIMINARY SUBMITTAL 7
06/18/18		DESIGN DEVELOPMENT
08/17/18		SCHEMATIC DEVELOPMENT
10/10/18		FINAL CODE SUBMITTAL
11/01/18		ISSUED FOR PROPOSALS

DOE FACILITY CODE 660-3086

RIVERWOOD HIGH SCHOOL - PHASE 3-8 AUDITORIUM/GYMNASIUM ADDITION

5900 RAIDER DRIVE NW SANDY SPRINGS, GA 30228

FULTON COUNTY SCHOOLS RFP NO. 411-19

24-HR CONTACT INFORMATION

CHAD A. WORD
FULTON COUNTY SCHOOLS
OWNER'S REPRESENTATIVE
470-254-3355

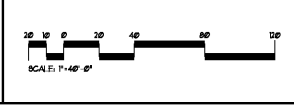

CAUTION

THE UTILITIES SHOWN ARE BASED ON THE CONTRACTOR'S CONVENIENCE ONLY. THERE MAY BE OTHER UTILITIES NOT SHOWN ON THESE PLANS. THE DESIGN PROFESSIONAL ASSUMES NO RESPONSIBILITY FOR THE LOCATION, DEPTH AND TYPE OF UTILITIES. THE CONTRACTOR SHALL VERIFY THE LOCATION OF UTILITIES WITHIN THE LIMITS OF THE WORK. DAMAGE TO EXISTING UTILITIES BY THE CONTRACTOR FROM HIS OPERATIONS SHALL BE THE SOLE RESPONSIBILITY OF THE CONTRACTOR.

CONTRACTOR SHALL BE RESPONSIBLE TO OBTAIN THE SERVICES OF A PRIVATE UTILITY LOCATOR PRIOR TO THE START OF THE PROJECT. CONTRACTOR SHALL PAY FOR ALL SERVICES. CONTRACTOR SHALL IMMEDIATELY REPAIR ALL UTILITIES DAMAGED BY CONSTRUCTION ACTIVITIES, AT NO ADDITIONAL COST TO THE OWNER.

CONTRACTOR SHALL BE RESPONSIBLE FOR CORRECTION OF BACKFILL OF ALL UTILITY TRENCHES WITHIN SITE BOUNDARIES. THIS INCLUDES TRENCHES DUG AND BACKFILLED BY LOCAL UTILITIES, SUCH AS POWER, GAS, TELEPHONE, ETC. CONTRACTOR SHALL PROVIDE ADDITIONAL BACKFILL AND CORRECTION AS NECESSARY, IF SETTLEMENT OCCURS.

CHAPMAN GRIFFIN LANIER SUSSENBACH ARCHITECTS
 400 Galleria Parkway, Suite 100, Atlanta, Ga 30339, Phone: 404.733.5493

SHEET TITLE	PROJECT NO.	DATE	DESIGN BY	CHECKED BY	SHEET NO.
PLANTING PLAN	16015.02	09.17.18	KWW	HOB	

C-610