

DATE	NO.	DESCRIPTION
03/28/18		CODE PRELIMINARY SUBMITTAL / DESIGN DEVELOPMENT
06/18/18		CODE PRELIMINARY SUBMITTAL / SITE CONSTRUCTION DOCUMENTS
08/17/18		CODE CHECK SET / PERMIT SET
10/10/18		FINAL CODE SUBMITTAL / ISSUED FOR PROPOSALS
11/01/18		

DOE FACILITY CODE 660-3086
RIVERWOOD HIGH SCHOOL - PHASE 3-8 AUDITORIUM/GYMNASIUM ADDITION
5900 RAIDER DRIVE NW SANDY SPRINGS, GA 30228
FULTON COUNTY SCHOOLS RFP NO. 411-19

CHAPMAN GRIFFIN LANIER SUSSENBACH ARCHITECTS
400 Galleria Parkway, Suite 100 Atlanta, GA 30339 Phone: 404.733.5493

Tree Conservation & Replacement Plan
PROJECT NO. 16015.02
DATE: 09.17.18
DRAWN BY: KWW
CHECKED BY: HCB

C-600

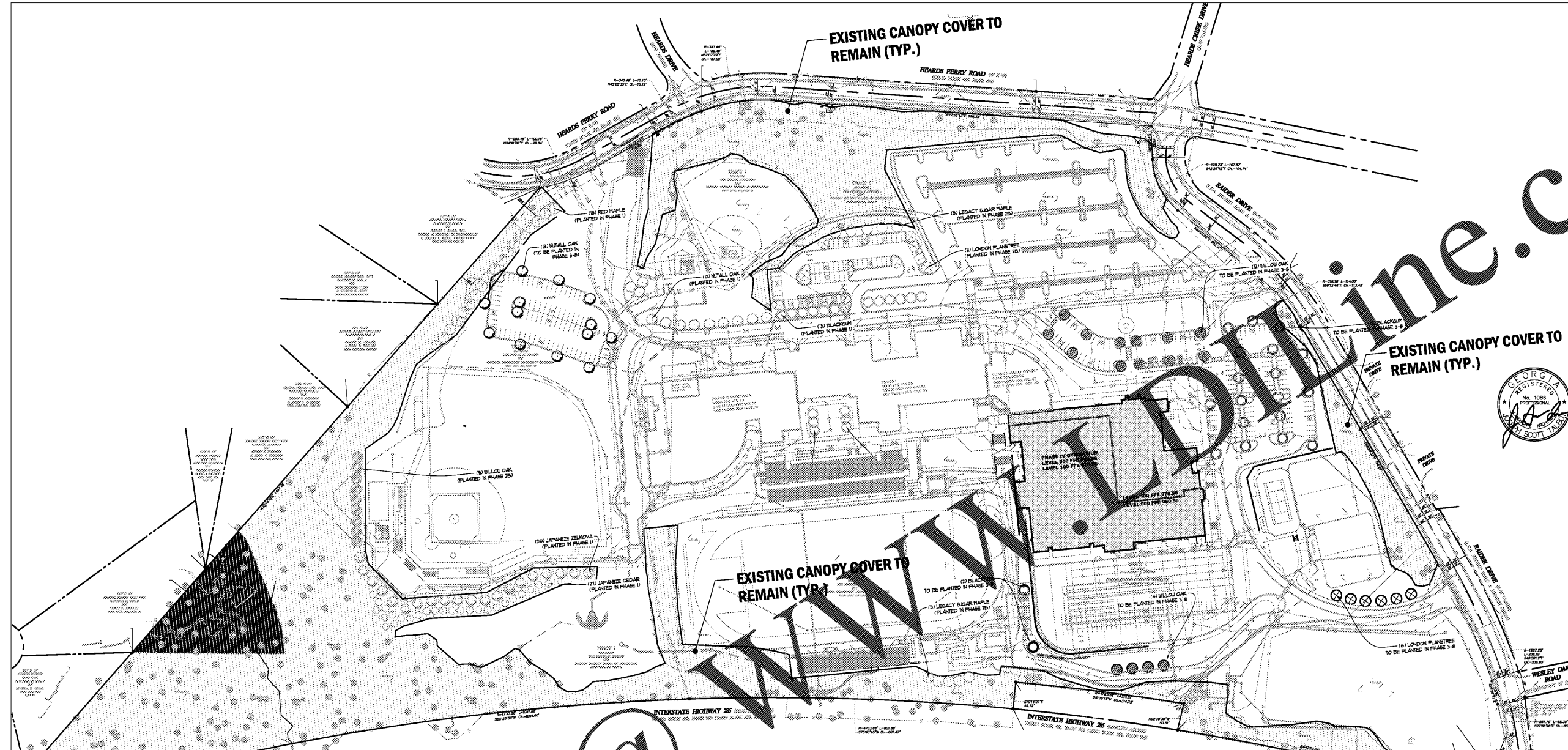

PHASE 1 TREE SCHEDULE (ALREADY PLANTED)

QUANT.	COMMON NAME	BOTANICAL NAME	SIZE	CONDITION	REMARKS
21	JAPANESE CEDAR	CRYPTOMERIA JAPONICA	3" CAL.	B4B	CANOPY TREE
20	JAPANESE ZELKOVA	ZELKOVA SERRATA	3" CAL.	B4B	CANOPY TREE (20)
12	NUTTALL OAK	QUERCUS NUTTALLII	3" CAL.	B4B	LANDMARK TREE REPLACEMENT (12) CANOPY TREE (12)
10	BLACKGUM	NYSSA SYLVATICA	3" CAL.	B4B	ADDITIONAL TREES
RED	RED TULIP	LIRIODENDRON GLORY	3" CAL.	B4B	ADDITIONAL TREES

PHASE 2B TREE SCHEDULE (ALREADY PLANTED)

QUANT.	COMMON NAME	BOTANICAL NAME	SIZE	CONDITION	REMARKS
10	LEGACY SUGAR MAPLE	ACER SACCHARUM 'LEGACY'	3" CAL.	B4B	CANOPY TREE (10)
9	WILLOW OAK	QUERCUS PHELLOS	3" CAL.	B4B	CANOPY TREE (9)
11	LONDON PLANETREE	PLATANUS X ACERIFOLIA	3" CAL.	B4B	CANOPY TREE (11) PARKING LOT TREE (11)

NOTE: QUANTITY INSIDE () COUNTS TOWARD SPECIFIED CALCULATION (IE, CANOPY REPLACEMENT, LANDMARK TREE REPLACEMENT, OR PARKING LOT TREE REQUIREMENT)

PHASE 3-8 TREE SCHEDULE

QUANT.	COMMON NAME	BOTANICAL NAME	SIZE	CONDITION	REMARKS
20	BLACKGUM	NYSSA SYLVATICA	3" CAL.	B4B	CANOPY TREE (20) PARKING LOT TREE (20)
16	WILLOW OAK	QUERCUS PHELLOS	3" CAL.	B4B	CANOPY TREE (16) PARKING LOT TREE (16)
6	LONDON PLANETREE	PLATANUS X ACERIFOLIA	3" CAL.	B4B	CANOPY TREE (6) PARKING LOT TREE (6)
13	NUTTALL OAK	QUERCUS NUTTALLII	3" CAL.	B4B	CANOPY TREE (13) PARKING LOT TREE (13)

NOTE: QUANTITY INSIDE () COUNTS TOWARD SPECIFIED CALCULATION (IE, CANOPY REPLACEMENT, LANDMARK TREE REPLACEMENT, OR PARKING LOT TREE REQUIREMENT)

Figure 1. Tree Protection Fencing

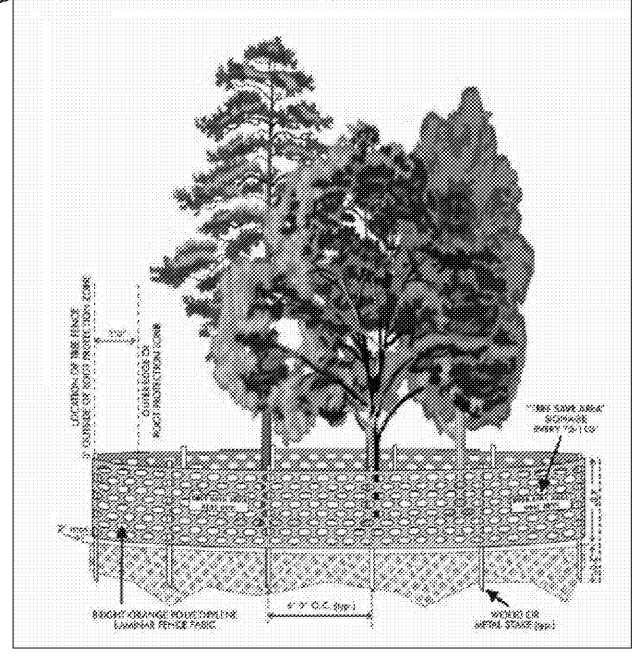

PHASE 1 CANOPY COVER CALCULATIONS

EXISTING CANOPY COVER TO REMAIN
TOTAL SITE AREA: 226,864 SF (16.88 AC)
REQUIRED 30% CANOPY COVERAGE: 68,059 SF (4.94 AC)
EXISTING CANOPY COVER TO REMAIN AFTER CONSTRUCTION: 57,800 SF (4.18 AC)
68,059 SF - 57,800 SF = 10,259 SF NEW CANOPY REQUIRED
10,259 SF FOR LARGE TREES
(10) 3" CAL. LARGE TREES PROVIDED: 99 X 1000 SF = 9,900 SF
REQUIRED LANDMARK TREES (10) 3" CAL. LARGE TREES PROVIDED: 10,259 SF (10) 3" CAL. LARGE TREES PROVIDED: 10,259 SF (10) 3" CAL. LARGE TREES PROVIDED FOR COVERAGE. REFER TO TREE SCHEDULE ON SHEET C-601

PHASE 2B CANOPY COVER CALCULATIONS

ADDITIONAL CANOPY COVER REMOVED FOR PHASE 2B CONSTRUCTION: 79,175 SF (5.76 AC)
79,175 SF NEW CANOPY REQUIRED
10,259 SF FOR LARGE TREES
(10) 3" CAL. LARGE TREES PROVIDED: 99 X 1000 SF = 9,900 SF
ADDITIONAL CANOPY COVER PROVIDED
NO ADDITIONAL LANDMARK TREES WILL BE IMPACTED FOR PHASE 2B CONSTRUCTION.

PHASE 3-8 CANOPY COVER CALCULATIONS

ADDITIONAL CANOPY COVER REMOVED FOR PHASE 3-8 CONSTRUCTION: 213,661 SF (15.46 AC)
213,661 SF NEW CANOPY REQUIRED
10,259 SF FOR LARGE TREES
(10) 3" CAL. LARGE TREES PROVIDED: 99 X 1000 SF = 9,900 SF
ADDITIONAL CANOPY COVER PROVIDED
NO ADDITIONAL LANDMARK TREES WILL BE IMPACTED FOR PHASE 3-8 CONSTRUCTION.

PLANTING NOTES

- PLANT MATERIALS SHALL MEET MINIMUM REQUIREMENTS AS SET FORTH IN THE LATEST EDITION OF AMERICAN STANDARD FOR NURSERY STOCK (ANNS 86-1)
- TOTAL SITE AREA: 226,864 SF (16.88 AC)
- REQUIRED 30% CANOPY COVERAGE: 68,059 SF (4.94 AC)
- EXISTING CANOPY COVER TO REMAIN AFTER CONSTRUCTION: 57,800 SF (4.18 AC)
- 68,059 SF - 57,800 SF = 10,259 SF NEW CANOPY REQUIRED
- 10,259 SF FOR LARGE TREES
- (10) 3" CAL. LARGE TREES PROVIDED: 99 X 1000 SF = 9,900 SF
- REQUIRED LANDMARK TREES (10) 3" CAL. LARGE TREES PROVIDED: 10,259 SF (10) 3" CAL. LARGE TREES PROVIDED FOR COVERAGE. REFER TO TREE SCHEDULE ON SHEET C-601
- PLANTS AND SUBJECT TO THE APPROVAL OF THE ARCHITECT OR OWNER BEFORE, DURING AND AFTER INSTALLATION.
- DO NOT ALLOW AIR POKETS TO FORM WHEN BACKFILLING.
- DO NOT BREAK ROOTBALL.
- IMMEDIATELY SOAK NEW PLANTINGS WITH WATER.
- STAKE TREES IMMEDIATELY AFTER PLANTING AS INDICATED IN DETAILS OR AS DIRECTED BY THE ARCHITECT.
- CONTRACTOR SHALL BE RESPONSIBLE FOR MAINTENANCE, INCLUDING WATERING, WEEDING, BATTING, PRUNING OF THIS WORK THROUGHOUT THE MAINTENANCE PERIOD AS INDICATED IN THE SPECIFICATIONS OR UNTIL SUBSTANTIAL COMPLETION (WHICHEVER IS GREATER).
- THE CONTRACTOR IS ADVISED OF THE UNDERGROUND UTILITIES AND SHALL CHECK LOCATION OF SAME BEFORE COMMENCING DIGGING OPERATIONS.
- CONTRACTOR SHALL FULLY GUARANTEE PLANTS FOR THIS JOB FOR A PERIOD OF ONE (1) YEAR BEGINNING ON THE DATE OF ACCEPTANCE.
- CONTRACTOR SHALL BE RESPONSIBLE FOR WATERING CANOPY COVERAGE AND REPORT ANY DISCREPANCIES TO THE ARCHITECT.
- CONTRACTOR SHALL FILL LOCATION OF PLANT MATERIAL FOR APPROVAL BY ARCHITECT BEFORE INSTALLATION.
- PLANT BEDS SHALL BE FILLED WITH A MINIMUM OF 3" OF CLEAN FRESH PINE STRAW.
- ALL AREAS DESIGNATED AS FLOOR BEDS SHALL RECEIVE 2" OF PINE STRAW MULCH.
- PLANTING NOTES SHALL BE PER SPECIFICATIONS.

PHASE 3-8 PARKING LOT TREE CALCULATIONS

ONE TREE REQUIRED PER BOX PARKING SPACES
20 NEW PARKING SPACES WILL BE PROVIDED IN PHASE 3-8 (20) 8' x 16' BOX
56 NEW PARKING LOT TREES PROVIDED IN PHASE 3-8

24-HR CONTACT INFORMATION
DOUGLAS P. CAREY
FULTON COUNTY SCHOOLS
OWNER'S REPRESENTATIVE
470-254-2170

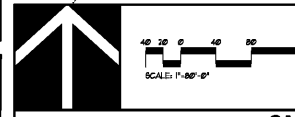

DO NOT DUPLICATE DRAWINGS WITHOUT WRITTEN PERMISSION

CAUTION
THE UTILITIES SHOWN ARE SHOWN FOR THE CONTRACTOR'S CONVENIENCE ONLY. THERE MAY BE OTHER UTILITIES NOT SHOWN ON THESE PLANS. THE DESIGN PROFESSIONAL ASSUMES NO RESPONSIBILITY FOR THE LOCATION, DEPTH AND TYPE OF UTILITIES. IT IS THE CONTRACTOR'S RESPONSIBILITY TO VERIFY THE LOCATION OF UTILITIES WITHIN THE LIMITS OF THE WORK. DAMAGE TO EXISTING UTILITIES BY THE CONTRACTOR FROM HIS/HER OPERATIONS SHALL BE THE SOLE RESPONSIBILITY OF THE CONTRACTOR.

CONTRACTOR SHALL BE RESPONSIBLE TO OBTAIN THE SERVICES OF A PRIVATE UTILITY LOCATOR (PUL) DURING THE ENTIRE COURSE OF CONSTRUCTION. CONTRACTOR SHALL PAY FOR BAD SERVICES. CONTRACTOR SHALL IMMEDIATELY REPAIR ALL UTILITIES DAMAGED BY CONSTRUCTION ACTIVITIES AT NO ADDITIONAL COST TO THE OWNER.

CONTRACTOR SHALL BE RESPONSIBLE FOR PROTECTION OF BACKFILL OF ALL UTILITY TRENCHES WITHIN SITE WORK LIMITS. THIS INCLUDES TRENCHES DIGG AND BACKFILLED BY LOCAL UTILITIES, SUCH AS POWER AND TELEPHONE, ETC. CONTRACTOR SHALL PROVIDE ADDITIONAL BACKFILL AND PROTECTION AS NECESSARY IF SETTLEMENT OCCURS.

811 Know what's below. Call before you dig. Dial 811 or Call 800-282-7411

Order Plans @

WWW.LANIERLINE.COM