

### GENERAL EROSION NOTES

1. NOTIFY CITY/COUNTY INSPECTORS 24 HOURS BEFORE BEGINNING OF EVERY CONSTRUCTION PHASE.
2. ALL DISTURBED AREAS SHALL BE CLEARLY IDENTIFIED BY FLAGGING AND/OR FENCING PRIOR TO COMMENCEMENT OF ANY LAND DISTURBANCE.
3. THE INSTALLATION OF EROSION AND SEDIMENTATION CONTROL MEASURES AND PRACTICES SHALL BE COMPLETED PRIOR TO CONSTRUCTION OF ANY LAND DISTURBANCE AND MAINTAINED UNTIL PERMANENT GROUND COVER IS ESTABLISHED.
4. ALL SEDIMENT BARRIERS SHALL BE INSTALLED PRIOR TO ANY GRADING.
5. SEDIMENT BARRIER DEVICES SHALL BE INSPECTED AND REPAIRED OR REPLACED DAILY. ANY ACCUMULATED SEDIMENT SHALL BE REMOVED AND SPREAD ON SITE.
6. ALL DISTURBED AREAS SHALL BE GRAZED AS SOON AS CONSTRUCTION PHASE PERMITS.
7. EROSION AND SEDIMENTATION CONTROL MEASURES SHALL BE MAINTAINED AT ALL TIMES. ADDITIONAL EROSION AND SEDIMENTATION CONTROL MEASURES SHALL BE INSTALLED IF DEEMED NECESSARY BY ON-SITE INSPECTION REQUIRED BY COUNTY.
8. MAINTENANCE OF ALL SOIL EROSION AND SEDIMENTATION CONTROL MEASURES AND PRACTICES, WHETHER TEMPORARY OR PERMANENT, SHALL BE THE RESPONSIBILITY OF THE CONTRACTOR.
9. ANY DISCREPANCY BETWEEN THIS SHEET AND OTHERS IN THIS SET SHALL BE REFERRED TO THE ARCHITECT BY THE CONTRACTOR FOR CLARIFICATION BEFORE PROCEEDING WITH THE WORK.
10. SEDIMENT STORAGE LEVELS SHALL BE MAINTAINED IN SEDIMENT STORAGE STRUCTURES, INCLUDING THE TOTAL VOLUME.
11. MAXIMUM GROUND BLOW SPEEDS SHALL BE LIMITED TO 7 MPH.
12. CONTRACTOR SHALL PROVIDE TEMPORARY DOAM MATS ON FILL SLOPES TO PREVENT EROSION AND SEDIMENT FROM DETENTION BASIN.
13. CONTRACTOR SHALL PROVIDE ACCESS TO ALL DISTURBED AREAS HAVE BEEN FULLY STABILIZED.

### SWCC REQUIRED NOTES

- THE DESIGN PROFESSIONAL WHO PREPARED THE EROSION CONTROL PLAN IS TO INSPECT THE INSTALLATION OF THE INITIAL SEDIMENT STORAGE REQUIREMENTS AND PERFORMER CONTROL, 90 DAYS AFTER INSTALLATION.
- NON-EXEMPT ACTIVITIES SHALL NOT BE CONDUCTED WITHIN THE 25 OR 50-FOOT UNDISTURBED STRIP BUFFERS AS MEASURED FROM THE POINT OF UNDISTURBED VEGETATION OR WITHIN 25 FEET OF THE COASTAL MARSH AND BUFFER AS MEASURED FROM THE JURISDICTIONAL DETERMINATION LINE WITHOUT FIRST ACQUIRING THE NECESSARY VARIANCES AND PERMITS.
- AMENDMENTS / REVISIONS TO THE EROSION CONTROL PLAN WHICH HAVE A SIGNIFICANT EFFECT ON EROSION CONTROL MEASURES SHALL BE CERTIFIED BY THE DESIGN PROFESSIONAL.
- WASTE MATERIALS SHALL NOT BE DISCHARGED TO WATERS OF THE STATE, EXCEPT AS AUTHORIZED BY A SECTION 404 PERMIT.
- THE ESCAPE OF SEDIMENT FROM THE SITE SHALL BE PREVENTED BY THE INSTALLATION OF EROSION AND SEDIMENT CONTROL MEASURES AND PRACTICES PRIOR TO LAND DISTURBANCE ACTIVITIES.
- EROSION CONTROL MEASURES WILL BE MAINTAINED AT ALL TIMES. IF FILL APPLICATION OR USE OF APPROVED PLAN DOES NOT PROVIDE FOR EFFECTIVE EROSION CONTROL, ADDITIONAL EROSION AND SEDIMENT CONTROL MEASURES SHALL BE INSTALLED TO CONTROL EROSION AND SEDIMENT SOURCE.
- ANY DISTURBED AREA LEFT EXPOSED FOR A PERIOD GREATER THAN 14 DAYS SHALL BE STABILIZED WITH MULCH OR TEMPORARY BEEDING.

### GSWCC LEVEL 2 CERTIFICATIONS

- I CERTIFY UNDER PENALTY OF LAW THAT THIS PLAN WAS PREPARED AFTER A SITE VISIT TO THE LOCATION DESCRIBED HEREIN BY MYSELF OR MY AUTHORIZED AGENT UNDER MY SUPERVISION.
- I CERTIFY THAT THE PERMITTED EROSION, SEDIMENTATION AND POLLUTION CONTROL PLAN PROVIDES FOR AN APPROPRIATE AND COMPREHENSIVE SYSTEM OF BEST MANAGEMENT PRACTICES REQUIRED BY THE GEORGIA WATER QUALITY CONTROL ACT AND THE CURRENT MANUAL FOR EROSION AND SEDIMENT CONTROL IN GEORGIA (MANUAL) PUBLISHED BY THE STATE SOIL AND WATER CONSERVATION SERVICE AS OF JANUARY OF THE YEAR IN WHICH THE LAND-DISTURBING ACTIVITY WAS PERMITTED, PROVIDED FOR THE SAMPLING OF THE RECEIVING WATERS UNDER THE SAME AS SET FORTH IN THE MANUAL AND THAT THE DESIGNED SYSTEM OF BEST MANAGEMENT PRACTICES AND SAMPLING METHODS IS EXPECTED TO MEET THE REQUIREMENTS CONTAINED IN THE GENERAL PERMITS PERTAINING TO THE ACTIVITY.
- DATE: 1-28-2025
- SIGNED: *Kyle Webb*
- CERTIFYING DESIGN PROFESSIONAL: KYLE WEBB  
GSWCC CERTIFICATION NO. LEVEL 2: 2486808781  
EXPIRATION DATE: 3-3-2028  
COMPANY: BREEDELOVE LAND PLANNING, INC.

### FINAL STABILIZATION & N.O.T.

- SHEET C401 SHOWS LIMITS OF ADDITIONAL HYDRO-SEEDING AND OTHER STABILIZATION REQUIRED BY THIS CONTRACT. ALL AREAS DISTURBED BY CONSTRUCTION ACTIVITY, INCLUDING THOSE NOT EXPLICITLY SHOWN IN THE CONSTRUCTION CHANGES SHALL BE STABILIZED WITH BERMUDA GRASS VIA HYDRO-SEEDING UNLESS OTHERWISE NOTED. CONTRACTOR SHALL ACHIEVE 95% COVERAGE OF ALL LAWN AREAS WITH BARE SPOTS NO LARGER THAN ONE (1) SQUARE FOOT. CONTRACTOR SHALL BE RESPONSIBLE TO ACHIEVE THE MINIMUM COVERAGES FOR FINAL STABILIZATION REQUIRED BY THE GEORGIA NPDES PERMIT PRIOR TO FILING OF THE NPDES NOTICE OF TERMINATION (NOT).
- WHEN THE FACILITY/CONSTRUCTION SITE HAS UNDERGONE FINAL STABILIZATION AND ALL STORM WATER DISCHARGES FROM CONSTRUCTION ACTIVITIES THAT ARE AUTHORIZED BY THE NPDES GENERAL PERMITS HAVE CEASED OR UNDER THE OWNER AND/OR OPERATOR OF THE SITE CHANGES, THE PERMITTEE OF THE FACILITY/CONSTRUCTION SITE SHALL NOTIFY THE FACILITY/CONSTRUCTION SITE.
- FINAL STABILIZATION MEANS THAT ALL SOIL DISTURBING ACTIVITIES AT THE SITE HAVE BEEN COMPLETED AND THAT FOR UNPAVED AREAS AND AREAS NOT COVERED BY PERMANENT STRUCTURES AND AREAS NOT COVERED BY THE BARE SOIL, THE LIMITS OF A LANDFILL CELL THAT HAS BEEN CERTIFIED BY EPD FOR WASTE DISPOSAL, 100% OF THE SOIL SURFACE IS SURFACE COVERED IN PERMANENT VEGETATION WITH A DENSITY OF 100% OR GREATER. PERMANENT VEGETATION SHALL BE PLANTED IN AREAS (SUCH AS THE USE OF RIP RAP, GARDENS, PERMANENT FIELDS OR GEO-TEXTILES) HAVE BEEN COVERED WITH PERMANENT VEGETATION. PERMANENT VEGETATION SHALL BE PLANTED IN AREAS (SUCH AS THE USE OF RIP RAP, GARDENS, PERMANENT FIELDS OR GEO-TEXTILES) HAVE BEEN COVERED WITH PERMANENT VEGETATION. PERMANENT VEGETATION SHALL BE PLANTED IN AREAS (SUCH AS THE USE OF RIP RAP, GARDENS, PERMANENT FIELDS OR GEO-TEXTILES) HAVE BEEN COVERED WITH PERMANENT VEGETATION.

REFER TO SHEET C401 FOR UNIFORM CODING SYSTEM  
REFER TO SHEET C400/C401 FOR EROSION CONTROL GENERAL NOTES  
REFER TO C100 FOR NPDES SAMPLING LOCATIONS

### 24-HR CONTACT INFORMATION

**CHAD A. WORD**  
FULTON COUNTY SCHOOLS  
OWNER'S REPRESENTATIVE  
470-254-3355

DO NOT DUPLICATE DRAWINGS WITHOUT WRITTEN PERMISSION.

DATE: 09.17.18

DESIGNED BY: KWW  
CHECKED BY: HOS

### CAUTION

THE UTILITIES SHOWN ARE SHOWN FOR THE CONTRACTOR'S CONVENIENCE ONLY. THERE MAY BE OTHER UTILITIES NOT SHOWN ON THESE PLANS. DESIGN PROFESSIONAL ASSUMES NO RESPONSIBILITY FOR THE LOCATIONS SHOWN AND IT SHALL BE THE CONTRACTOR'S RESPONSIBILITY TO VERIFY THE LOCATIONS OF UTILITIES WITHIN THE LIMITS OF THE WORK. DAMAGE TO EXISTING UTILITIES BY THE CONTRACTOR FROM HIS OWN OPERATIONS SHALL BE THE SOLE RESPONSIBILITY OF THE CONTRACTOR.

CONTRACTOR SHALL BE RESPONSIBLE TO SECURE THE SERVICES OF A UTILITY LOCATOR TO VERIFY THE LOCATION OF UTILITIES. THIS INCLUDES CONTRACTOR SHALL PAY FOR BAI SERVICES. CONTRACTOR SHALL IMMEDIATELY REPAIR ALL UTILITIES DAMAGED BY CONSTRUCTION ACTIVITIES AT NO ADDITIONAL COST TO THE OWNER.

CONTRACTOR SHALL BE RESPONSIBLE FOR CORRECTION OF BACKFILL OF ALL UTILITY TRENCHES WITHIN WORK LIMITS. THIS INCLUDES REINFORCED DRAINAGE AND BACKFILL BY LOCAL UTILITIES SUCH AS POWER, GAS, TELEPHONE, ETC. CONTRACTOR SHALL PROVIDE ADDITIONAL BACKFILL AND CORRECTION AS NECESSARY, IF SETTLEMENT OCCURS.

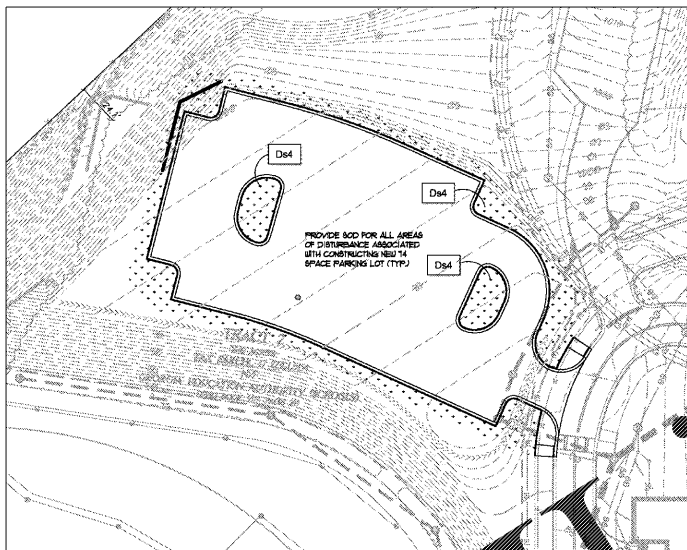

PARKING LOT @ BASEBALL SCALE 1/40

MONTH	TEMPORARY	PERMANENT	RATE / ACRE	PERMANENT	RATE / ACRE	PERMANENT	PERMANENT
JANUARY	RYE GRASS	UNPAVED BERMUDA	40 LBS/A	UNPAVED BERMUDA	40 LBS/A	UNPAVED BERMUDA	40 LBS/A
FEBRUARY	RYE GRASS	UNPAVED BERMUDA	40 LBS/A	UNPAVED BERMUDA	40 LBS/A	UNPAVED BERMUDA	40 LBS/A
MARCH	RYE GRASS	UNPAVED BERMUDA	40 LBS/A	UNPAVED BERMUDA	40 LBS/A	UNPAVED BERMUDA	40 LBS/A
APRIL	ANNUAL LEVEE/DEER (2)	UNPAVED BERMUDA	40 LBS/A	UNPAVED BERMUDA	40 LBS/A	UNPAVED BERMUDA	40 LBS/A
MAY	RYE GRASS	UNPAVED BERMUDA	40 LBS/A	UNPAVED BERMUDA	40 LBS/A	UNPAVED BERMUDA	40 LBS/A
JUNE	RYE GRASS	UNPAVED BERMUDA	40 LBS/A	UNPAVED BERMUDA	40 LBS/A	UNPAVED BERMUDA	40 LBS/A
JULY	RYE GRASS	UNPAVED BERMUDA	40 LBS/A	UNPAVED BERMUDA	40 LBS/A	UNPAVED BERMUDA	40 LBS/A
AUGUST	RYE GRASS	UNPAVED BERMUDA	40 LBS/A	UNPAVED BERMUDA	40 LBS/A	UNPAVED BERMUDA	40 LBS/A
SEPTEMBER	RYE GRASS	UNPAVED BERMUDA	40 LBS/A	UNPAVED BERMUDA	40 LBS/A	UNPAVED BERMUDA	40 LBS/A
OCTOBER	RYE GRASS	UNPAVED BERMUDA	40 LBS/A	UNPAVED BERMUDA	40 LBS/A	UNPAVED BERMUDA	40 LBS/A
NOVEMBER	RYE GRASS	UNPAVED BERMUDA	40 LBS/A	UNPAVED BERMUDA	40 LBS/A	UNPAVED BERMUDA	40 LBS/A
DECEMBER	RYE GRASS	UNPAVED BERMUDA	40 LBS/A	UNPAVED BERMUDA	40 LBS/A	UNPAVED BERMUDA	40 LBS/A

### EROSION CONTROL NARRATIVE

THE TOTAL PROJECT AREA IS 48.88 ACRES.

PHASE 1 DEPICTS FINAL STABILIZATION MEASURES FOR ALL AREAS EXCLUDING PHASE 2 (SEE C401 FOR PHASE 2 FINAL STABILIZATION). PHASE 2 IS BEING BOD AS AN ALTERNATE PHASE AND MAY BE REMOVED FROM THE PROJECT SCOPE. PHASE 3 IS BEING BOD AS AN ALTERNATE PHASE AND MAY BE REMOVED FROM THE PROJECT SCOPE. PHASE 4 IS BEING BOD AS AN ALTERNATE PHASE AND MAY BE REMOVED FROM THE PROJECT SCOPE. PHASE 5 IS BEING BOD AS AN ALTERNATE PHASE AND MAY BE REMOVED FROM THE PROJECT SCOPE. PHASE 6 IS BEING BOD AS AN ALTERNATE PHASE AND MAY BE REMOVED FROM THE PROJECT SCOPE. PHASE 7 IS BEING BOD AS AN ALTERNATE PHASE AND MAY BE REMOVED FROM THE PROJECT SCOPE. PHASE 8 IS BEING BOD AS AN ALTERNATE PHASE AND MAY BE REMOVED FROM THE PROJECT SCOPE. PHASE 9 IS BEING BOD AS AN ALTERNATE PHASE AND MAY BE REMOVED FROM THE PROJECT SCOPE. PHASE 10 IS BEING BOD AS AN ALTERNATE PHASE AND MAY BE REMOVED FROM THE PROJECT SCOPE. PHASE 11 IS BEING BOD AS AN ALTERNATE PHASE AND MAY BE REMOVED FROM THE PROJECT SCOPE. PHASE 12 IS BEING BOD AS AN ALTERNATE PHASE AND MAY BE REMOVED FROM THE PROJECT SCOPE. PHASE 13 IS BEING BOD AS AN ALTERNATE PHASE AND MAY BE REMOVED FROM THE PROJECT SCOPE. PHASE 14 IS BEING BOD AS AN ALTERNATE PHASE AND MAY BE REMOVED FROM THE PROJECT SCOPE. PHASE 15 IS BEING BOD AS AN ALTERNATE PHASE AND MAY BE REMOVED FROM THE PROJECT SCOPE. PHASE 16 IS BEING BOD AS AN ALTERNATE PHASE AND MAY BE REMOVED FROM THE PROJECT SCOPE. PHASE 17 IS BEING BOD AS AN ALTERNATE PHASE AND MAY BE REMOVED FROM THE PROJECT SCOPE. PHASE 18 IS BEING BOD AS AN ALTERNATE PHASE AND MAY BE REMOVED FROM THE PROJECT SCOPE. PHASE 19 IS BEING BOD AS AN ALTERNATE PHASE AND MAY BE REMOVED FROM THE PROJECT SCOPE. PHASE 20 IS BEING BOD AS AN ALTERNATE PHASE AND MAY BE REMOVED FROM THE PROJECT SCOPE. PHASE 21 IS BEING BOD AS AN ALTERNATE PHASE AND MAY BE REMOVED FROM THE PROJECT SCOPE. PHASE 22 IS BEING BOD AS AN ALTERNATE PHASE AND MAY BE REMOVED FROM THE PROJECT SCOPE. PHASE 23 IS BEING BOD AS AN ALTERNATE PHASE AND MAY BE REMOVED FROM THE PROJECT SCOPE. PHASE 24 IS BEING BOD AS AN ALTERNATE PHASE AND MAY BE REMOVED FROM THE PROJECT SCOPE. PHASE 25 IS BEING BOD AS AN ALTERNATE PHASE AND MAY BE REMOVED FROM THE PROJECT SCOPE. PHASE 26 IS BEING BOD AS AN ALTERNATE PHASE AND MAY BE REMOVED FROM THE PROJECT SCOPE. PHASE 27 IS BEING BOD AS AN ALTERNATE PHASE AND MAY BE REMOVED FROM THE PROJECT SCOPE. PHASE 28 IS BEING BOD AS AN ALTERNATE PHASE AND MAY BE REMOVED FROM THE PROJECT SCOPE. PHASE 29 IS BEING BOD AS AN ALTERNATE PHASE AND MAY BE REMOVED FROM THE PROJECT SCOPE. PHASE 30 IS BEING BOD AS AN ALTERNATE PHASE AND MAY BE REMOVED FROM THE PROJECT SCOPE. PHASE 31 IS BEING BOD AS AN ALTERNATE PHASE AND MAY BE REMOVED FROM THE PROJECT SCOPE. PHASE 32 IS BEING BOD AS AN ALTERNATE PHASE AND MAY BE REMOVED FROM THE PROJECT SCOPE. PHASE 33 IS BEING BOD AS AN ALTERNATE PHASE AND MAY BE REMOVED FROM THE PROJECT SCOPE. PHASE 34 IS BEING BOD AS AN ALTERNATE PHASE AND MAY BE REMOVED FROM THE PROJECT SCOPE. PHASE 35 IS BEING BOD AS AN ALTERNATE PHASE AND MAY BE REMOVED FROM THE PROJECT SCOPE. PHASE 36 IS BEING BOD AS AN ALTERNATE PHASE AND MAY BE REMOVED FROM THE PROJECT SCOPE. PHASE 37 IS BEING BOD AS AN ALTERNATE PHASE AND MAY BE REMOVED FROM THE PROJECT SCOPE. PHASE 38 IS BEING BOD AS AN ALTERNATE PHASE AND MAY BE REMOVED FROM THE PROJECT SCOPE. PHASE 39 IS BEING BOD AS AN ALTERNATE PHASE AND MAY BE REMOVED FROM THE PROJECT SCOPE. PHASE 40 IS BEING BOD AS AN ALTERNATE PHASE AND MAY BE REMOVED FROM THE PROJECT SCOPE. PHASE 41 IS BEING BOD AS AN ALTERNATE PHASE AND MAY BE REMOVED FROM THE PROJECT SCOPE. PHASE 42 IS BEING BOD AS AN ALTERNATE PHASE AND MAY BE REMOVED FROM THE PROJECT SCOPE. PHASE 43 IS BEING BOD AS AN ALTERNATE PHASE AND MAY BE REMOVED FROM THE PROJECT SCOPE. PHASE 44 IS BEING BOD AS AN ALTERNATE PHASE AND MAY BE REMOVED FROM THE PROJECT SCOPE. PHASE 45 IS BEING BOD AS AN ALTERNATE PHASE AND MAY BE REMOVED FROM THE PROJECT SCOPE. PHASE 46 IS BEING BOD AS AN ALTERNATE PHASE AND MAY BE REMOVED FROM THE PROJECT SCOPE. PHASE 47 IS BEING BOD AS AN ALTERNATE PHASE AND MAY BE REMOVED FROM THE PROJECT SCOPE. PHASE 48 IS BEING BOD AS AN ALTERNATE PHASE AND MAY BE REMOVED FROM THE PROJECT SCOPE. PHASE 49 IS BEING BOD AS AN ALTERNATE PHASE AND MAY BE REMOVED FROM THE PROJECT SCOPE. PHASE 50 IS BEING BOD AS AN ALTERNATE PHASE AND MAY BE REMOVED FROM THE PROJECT SCOPE. PHASE 51 IS BEING BOD AS AN ALTERNATE PHASE AND MAY BE REMOVED FROM THE PROJECT SCOPE. PHASE 52 IS BEING BOD AS AN ALTERNATE PHASE AND MAY BE REMOVED FROM THE PROJECT SCOPE. PHASE 53 IS BEING BOD AS AN ALTERNATE PHASE AND MAY BE REMOVED FROM THE PROJECT SCOPE. PHASE 54 IS BEING BOD AS AN ALTERNATE PHASE AND MAY BE REMOVED FROM THE PROJECT SCOPE. PHASE 55 IS BEING BOD AS AN ALTERNATE PHASE AND MAY BE REMOVED FROM THE PROJECT SCOPE. PHASE 56 IS BEING BOD AS AN ALTERNATE PHASE AND MAY BE REMOVED FROM THE PROJECT SCOPE. PHASE 57 IS BEING BOD AS AN ALTERNATE PHASE AND MAY BE REMOVED FROM THE PROJECT SCOPE. PHASE 58 IS BEING BOD AS AN ALTERNATE PHASE AND MAY BE REMOVED FROM THE PROJECT SCOPE. PHASE 59 IS BEING BOD AS AN ALTERNATE PHASE AND MAY BE REMOVED FROM THE PROJECT SCOPE. PHASE 60 IS BEING BOD AS AN ALTERNATE PHASE AND MAY BE REMOVED FROM THE PROJECT SCOPE. PHASE 61 IS BEING BOD AS AN ALTERNATE PHASE AND MAY BE REMOVED FROM THE PROJECT SCOPE. PHASE 62 IS BEING BOD AS AN ALTERNATE PHASE AND MAY BE REMOVED FROM THE PROJECT SCOPE. PHASE 63 IS BEING BOD AS AN ALTERNATE PHASE AND MAY BE REMOVED FROM THE PROJECT SCOPE. PHASE 64 IS BEING BOD AS AN ALTERNATE PHASE AND MAY BE REMOVED FROM THE PROJECT SCOPE. PHASE 65 IS BEING BOD AS AN ALTERNATE PHASE AND MAY BE REMOVED FROM THE PROJECT SCOPE. PHASE 66 IS BEING BOD AS AN ALTERNATE PHASE AND MAY BE REMOVED FROM THE PROJECT SCOPE. PHASE 67 IS BEING BOD AS AN ALTERNATE PHASE AND MAY BE REMOVED FROM THE PROJECT SCOPE. PHASE 68 IS BEING BOD AS AN ALTERNATE PHASE AND MAY BE REMOVED FROM THE PROJECT SCOPE. PHASE 69 IS BEING BOD AS AN ALTERNATE PHASE AND MAY BE REMOVED FROM THE PROJECT SCOPE. PHASE 70 IS BEING BOD AS AN ALTERNATE PHASE AND MAY BE REMOVED FROM THE PROJECT SCOPE. PHASE 71 IS BEING BOD AS AN ALTERNATE PHASE AND MAY BE REMOVED FROM THE PROJECT SCOPE. PHASE 72 IS BEING BOD AS AN ALTERNATE PHASE AND MAY BE REMOVED FROM THE PROJECT SCOPE. PHASE 73 IS BEING BOD AS AN ALTERNATE PHASE AND MAY BE REMOVED FROM THE PROJECT SCOPE. PHASE 74 IS BEING BOD AS AN ALTERNATE PHASE AND MAY BE REMOVED FROM THE PROJECT SCOPE. PHASE 75 IS BEING BOD AS AN ALTERNATE PHASE AND MAY BE REMOVED FROM THE PROJECT SCOPE. PHASE 76 IS BEING BOD AS AN ALTERNATE PHASE AND MAY BE REMOVED FROM THE PROJECT SCOPE. PHASE 77 IS BEING BOD AS AN ALTERNATE PHASE AND MAY BE REMOVED FROM THE PROJECT SCOPE. PHASE 78 IS BEING BOD AS AN ALTERNATE PHASE AND MAY BE REMOVED FROM THE PROJECT SCOPE. PHASE 79 IS BEING BOD AS AN ALTERNATE PHASE AND MAY BE REMOVED FROM THE PROJECT SCOPE. PHASE 80 IS BEING BOD AS AN ALTERNATE PHASE AND MAY BE REMOVED FROM THE PROJECT SCOPE. PHASE 81 IS BEING BOD AS AN ALTERNATE PHASE AND MAY BE REMOVED FROM THE PROJECT SCOPE. PHASE 82 IS BEING BOD AS AN ALTERNATE PHASE AND MAY BE REMOVED FROM THE PROJECT SCOPE. PHASE 83 IS BEING BOD AS AN ALTERNATE PHASE AND MAY BE REMOVED FROM THE PROJECT SCOPE. PHASE 84 IS BEING BOD AS AN ALTERNATE PHASE AND MAY BE REMOVED FROM THE PROJECT SCOPE. PHASE 85 IS BEING BOD AS AN ALTERNATE PHASE AND MAY BE REMOVED FROM THE PROJECT SCOPE. PHASE 86 IS BEING BOD AS AN ALTERNATE PHASE AND MAY BE REMOVED FROM THE PROJECT SCOPE. PHASE 87 IS BEING BOD AS AN ALTERNATE PHASE AND MAY BE REMOVED FROM THE PROJECT SCOPE. PHASE 88 IS BEING BOD AS AN ALTERNATE PHASE AND MAY BE REMOVED FROM THE PROJECT SCOPE. PHASE 89 IS BEING BOD AS AN ALTERNATE PHASE AND MAY BE REMOVED FROM THE PROJECT SCOPE. PHASE 90 IS BEING BOD AS AN ALTERNATE PHASE AND MAY BE REMOVED FROM THE PROJECT SCOPE. PHASE 91 IS BEING BOD AS AN ALTERNATE PHASE AND MAY BE REMOVED FROM THE PROJECT SCOPE. PHASE 92 IS BEING BOD AS AN ALTERNATE PHASE AND MAY BE REMOVED FROM THE PROJECT SCOPE. PHASE 93 IS BEING BOD AS AN ALTERNATE PHASE AND MAY BE REMOVED FROM THE PROJECT SCOPE. PHASE 94 IS BEING BOD AS AN ALTERNATE PHASE AND MAY BE REMOVED FROM THE PROJECT SCOPE. PHASE 95 IS BEING BOD AS AN ALTERNATE PHASE AND MAY BE REMOVED FROM THE PROJECT SCOPE. PHASE 96 IS BEING BOD AS AN ALTERNATE PHASE AND MAY BE REMOVED FROM THE PROJECT SCOPE. PHASE 97 IS BEING BOD AS AN ALTERNATE PHASE AND MAY BE REMOVED FROM THE PROJECT SCOPE. PHASE 98 IS BEING BOD AS AN ALTERNATE PHASE AND MAY BE REMOVED FROM THE PROJECT SCOPE. PHASE 99 IS BEING BOD AS AN ALTERNATE PHASE AND MAY BE REMOVED FROM THE PROJECT SCOPE. PHASE 100 IS BEING BOD AS AN ALTERNATE PHASE AND MAY BE REMOVED FROM THE PROJECT SCOPE.

### STABILIZATION LEGEND

- PLANTING BED: Ds1
- PERMANENT BERMUDA GRASS FROM SEED VIA HYDROSEEDING: Ds3
- TEMP'RY 40% BERMUDA BOD: Ds4
- GRAVEL WITH FILTER FABRIC (BELOW BLEACHERS, SEE STORMY PLAN): Ds5

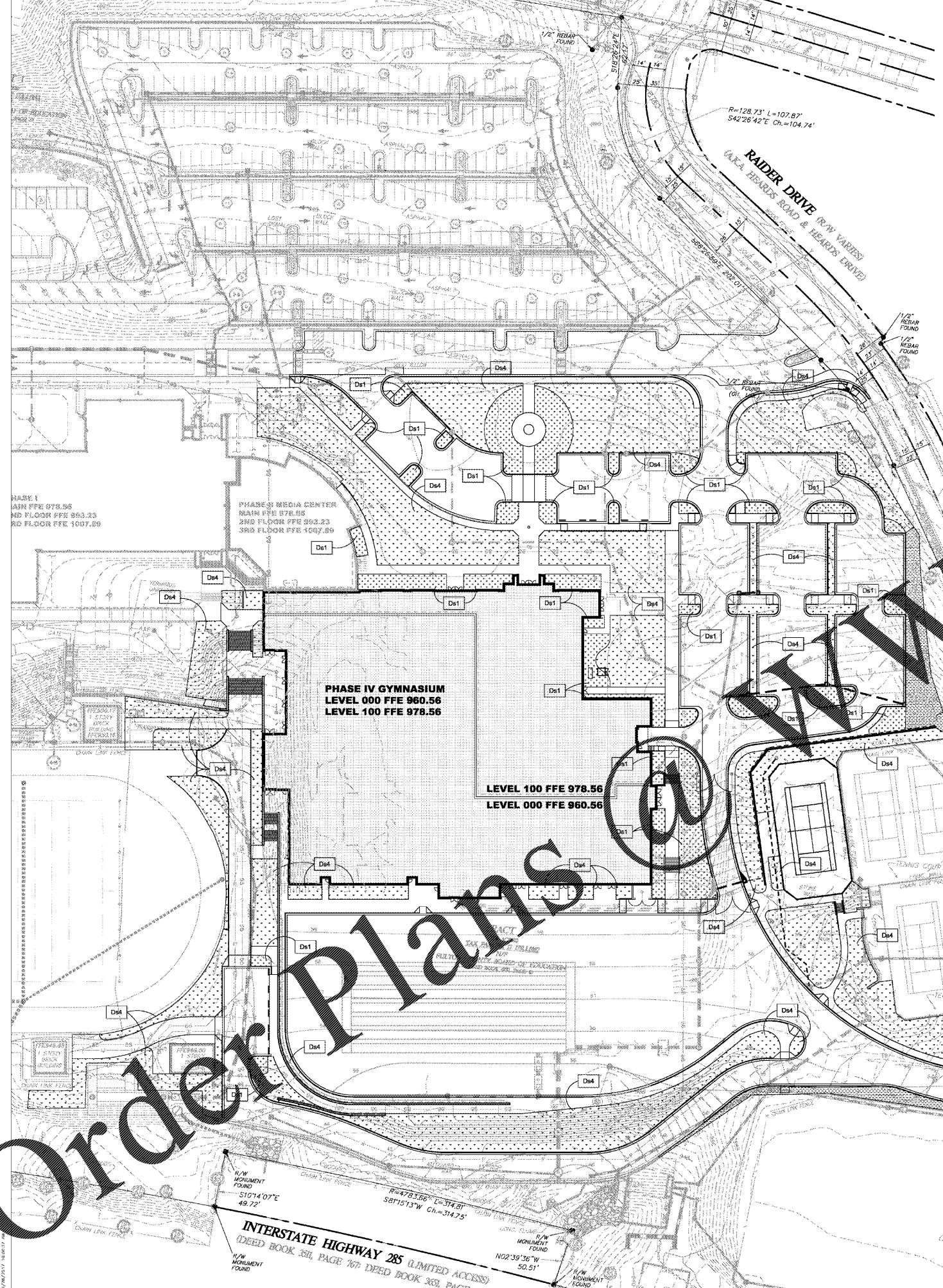

Architectural  
Facilitation  
Design

CHAPMAN GRIFFIN LANIER SUSSENBACH ARCHITECTS  
2018

RELEASED FOR CONSTRUCTION

BREDELOVE LAND PLANNING

12/20/2018

DATE NO. DESCRIPTION

DATE	NO.	DESCRIPTION
03/28/18		GOOD PRACTICE
06/18/18		SOIL CONSTRUCTION
07/17/18		CONTRACTOR
10/12/18		PERMIT SET
11/21/18		ISSUED FOR PROGRESS

DOE FACILITY CODE 660-3086

RIVERWOOD HIGH SCHOOL - PHASE 3-8 AUDITORIUM/GYMNASIUM ADDITION

5900 RAIDER DRIVE NW SANDY SPRINGS, GA 30028

FULTON COUNTY SCHOOLS REF NO. 411-19

CHAPMAN GRIFFIN LANIER SUSSENBACH ARCHITECTS  
400 Galleria Pkwy., Suite 100 Atlanta, Ga 30339 Phone: 404.733.5493

ES&PC PHASE 7 - FINAL PHASE

PROJECT NO. 16015.02

DATE: 09.17.18

811 Know what's below. Call before you dig. Dial 811 Or Call 800.282.7411

C-470