

Order Plans @ www.dline.com

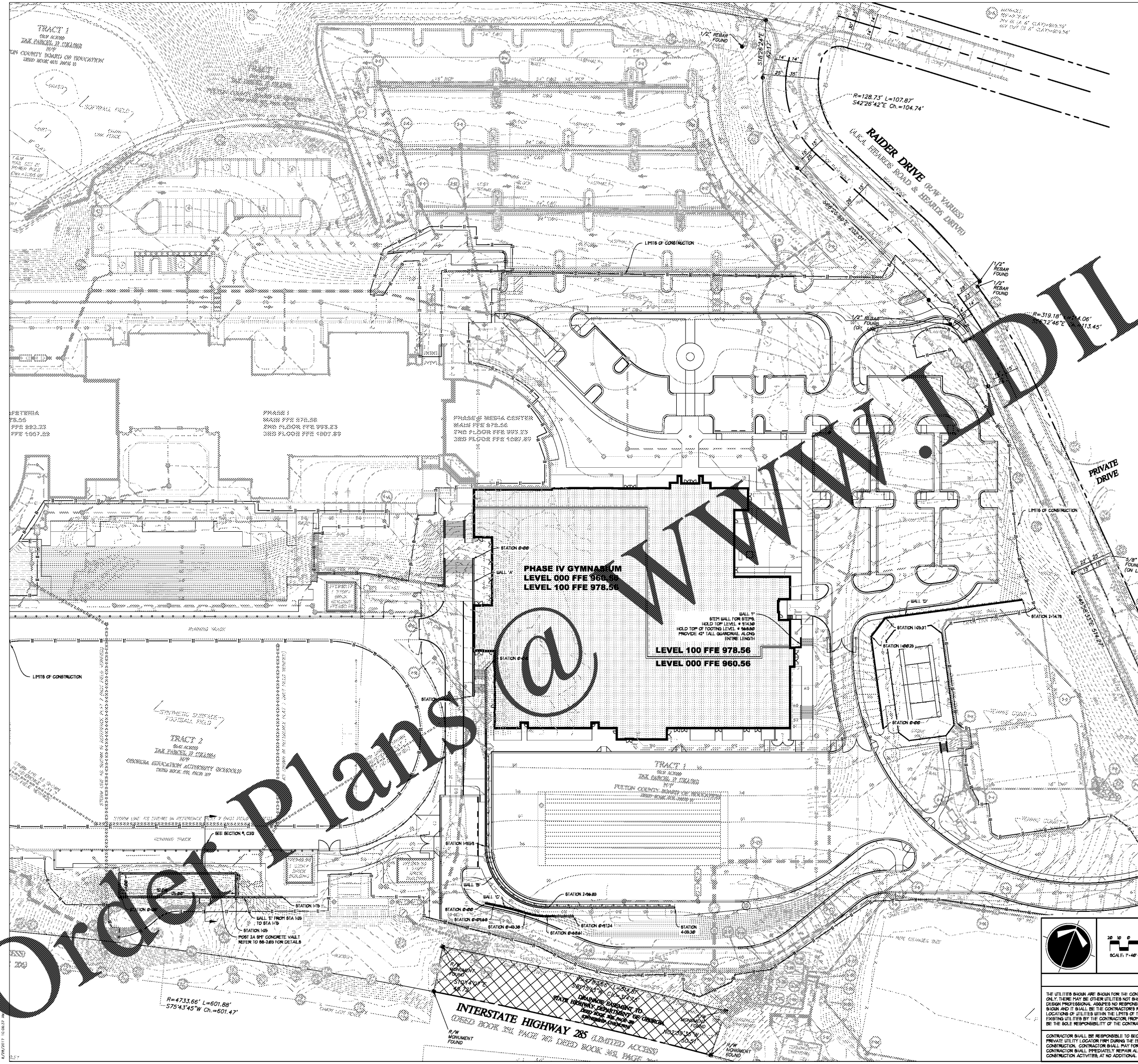

REFER TO STRUCTURAL DRAWINGS FOR RETAINING WALL DETAILS.

SEE 1/SS-2.03 FOR TYPICAL SITE WALL SECTION.

SEE 2/SS-2.03 FOR SITE WALL 'A'.

SEE 4/S-3.17 FOR PORTION OF WALL 'B' ALONG LENGTH OF BUILDING.

SEE 3/SS-2.03 FOR DETAILS OF WALL DEMOLITION & RECONSTRUCTION AT 'A' STORM SYSTEM OUTFALL.

SEE 3/SS-2.02 FOR DETAILS OF DETENTION VAULT BENEATH VISITOR BLEACHERS.

REFER TO ARCHITECTURAL DETAILS FOR RAILING ALONG TOPS OF WALLS

24-HR CONTACT INFORMATION

CHAD A. WORD
FULTON COUNTY SCHOOLS
OWNER'S REPRESENTATIVE
470-254-3355

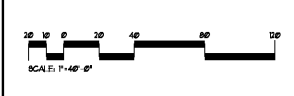

DO NOT DUPLICATE DRAWINGS WITHOUT WRITTEN PERMISSION

CAUTION

THE UTILITIES SHOWN ARE SHOWN FOR THE CONTRACTOR'S CONVENIENCE ONLY. THERE MAY BE OTHER UTILITIES NOT SHOWN ON THESE PLANS. THE DESIGN PROFESSIONAL ASSUMES NO RESPONSIBILITY FOR THE LOCATIONS SHOWN AND IT SHALL BE THE CONTRACTOR'S RESPONSIBILITY TO VERIFY THE LOCATIONS OF UTILITIES WITHIN THE LIMITS OF THE WORK. DAMAGE TO EXISTING UTILITIES BY THE CONTRACTOR FROM HIS/HER OPERATIONS SHALL BE THE SOLE RESPONSIBILITY OF THE CONTRACTOR.

811 Know what's below.
 Call before you dig.
 Dial 811
 Or Call 800-282-7411

CONTRACTOR SHALL BE RESPONSIBLE TO SECURE THE SERVICES OF A PRIVATE UTILITY LOCATION FIRM DURING THE ENTIRE COURSE OF CONSTRUCTION. CONTRACTOR SHALL PAY FOR SAID SERVICES. CONTRACTOR SHALL IMMEDIATELY REPAIR ALL UTILITIES DAMAGED BY CONSTRUCTION ACTIVITIES, AT NO ADDITIONAL COST TO THE OWNER.

CONTRACTOR SHALL BE RESPONSIBLE FOR COMPACTION OF BACKFILL OF ALL UTILITY TRENCHES WITHIN HIS/HER LIMITS. THIS INCLUDES TRENCHES DUG AND BACKFILLED BY LOCAL UTILITIES, SUCH AS POWER, GAS, TELEPHONE, ETC. CONTRACTOR SHALL PROVIDE ADDITIONAL BACKFILL AND COMPACTION AS NECESSARY, IF SETTLEMENT OCCURS.

Architectural
 Facilitation
 Design

CGLS ARCHITECTS
 CHAPMAN GRIFFIN LANIER SUSSENBACH ARCHITECTS
 400 GALLERIA PLAZA, SUITE 100 • ATLANTA, GA 30339 • PHONE: 404.733.5493
 2018

RELEASED FOR CONSTRUCTION

BREEDLOVE LAND PLANNING
 1111 W. BROAD ST. SUITE 200
 ATLANTA, GA 30306

CHAD A. WORD
 REGISTERED PROFESSIONAL ENGINEER
 STATE OF GEORGIA
 LICENSE NO. 11402

DATE	NO.	DESCRIPTION
03/28/18		CODE PRELIMINARY SUBMITTAL / DESIGN DEVELOPMENT
06/19/18		SITE CONSTRUCTION DOCUMENTS
08/17/18		CODE CHECK SET / PERMITS SET
10/10/18		FINAL CODE SUBMITTAL
11/01/18		ISSUED FOR PROPOSALS

RIVERWOOD HIGH SCHOOL - PHASE 3-8
AUDITORIUM/GYMNASIUM ADDITION

DOE FACILITY CODE 660-3086
 5800 RAIDER DRIVE NW SANDY SPRINGS, GA 30228
 FULTON COUNTY SCHOOLS RFP NO. 411-19

WALL PLAN

PROJECT NO. 16015.02

DATE: 09.17.18
 DRAWN BY: KWW
 CHECKED BY: HOB

C-310

CHAPMAN GRIFFIN LANIER SUSSENBACH ARCHITECTS
 400 Galleria Plwy • Suite 100 • Atlanta, Ga 30339 • Phone: 404.733.5493