

**NOTE: THIS SHEET ILLUSTRATES THE MAIN REQUIREMENTS OF THIS PHASE.**  
 - REFER TO CONSTRUCTION DOCUMENTS FOR MORE INFORMATION REGARDING CONSTRUCTION REQUIREMENTS.  
 - REFER TO SHEETS DAS-1.00 AND DAS-1.01 FOR ADDITIONAL PHASING INFORMATION.

**NOTE: CONTRACTOR SHALL BE RESPONSIBLE FOR MAINTAINING ALL EXISTING UTILITY SERVICES TO THE EXISTING HIGH SCHOOL BUILDING AND ALL OTHER STRUCTURES TO REMAIN FOR THE ENTIRE COURSE OF CONSTRUCTION UNLESS OTHERWISE DISCUSSED, COORDINATED, AND AGREED UPON WITH THE OWNER.**

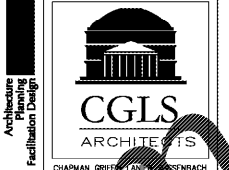

CHAPMAN GRIFFIN LANIER SUSSENBACH ARCHITECTS  
 400 Galleria Pkwy, Suite 100, Atlanta, GA 30339  
 Phone: 404.733.5493

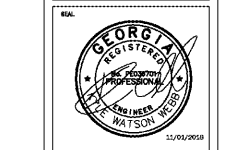

DATE	NO.	DESCRIPTION
05/29/18	001	ISSUE FOR PERMIT
06/11/18	002	ISSUE FOR PERMIT
06/17/18	003	ISSUE FOR PERMIT
10/10/18	004	ISSUE FOR PERMIT
11/01/18	005	ISSUE FOR PERMIT

DATE	NO.	DESCRIPTION
05/29/18	001	ISSUE FOR PERMIT
06/11/18	002	ISSUE FOR PERMIT
06/17/18	003	ISSUE FOR PERMIT
10/10/18	004	ISSUE FOR PERMIT
11/01/18	005	ISSUE FOR PERMIT

DOE FACILITY CODE 680-3086  
 RIVERWOOD HIGH SCHOOL - PHASE 3-B  
 AUDITORIUM/GYMNASIUM ADDITION  
 5900 RAIDER DRIVE NW SANDY SPRINGS, GA 30328  
 FULTON COUNTY SCHOOLS RFP NO. 411-19

CHAPMAN GRIFFIN LANIER SUSSENBACH ARCHITECTS  
 400 Galleria Pkwy, Suite 100, Atlanta, Ga 30339  
 Phone: 404.733.5493

**SITE PHASING PLAN (PHASE 5)**  
 PROJECT NO. 16015.02  
 DATE: 09.17.18  
 DRAWN BY: KWW  
 CHECKED BY: HOB

**24-HR CONTACT INFORMATION**  
 CHAD A. WORD  
 FULTON COUNTY SCHOOLS  
 OWNER'S REPRESENTATIVE  
 470-254-3355

**CAUTION**  
 THE UTILITIES SHOWN ARE SHOWN FOR THE CONTRACTOR'S CONVENIENCE ONLY. THERE MAY BE UTILITIES NOT SHOWN ON THESE PLANS. THE DESIGN PROFESSIONAL ASSUMES NO RESPONSIBILITY FOR THE LOCATIONS OF UTILITIES WITHIN THE LIMITS OF THE WORK. DAMAGE TO EXISTING UTILITIES BY THE CONTRACTOR FROM HIS HER OPERATIONS, SHALL BE THE SOLE RESPONSIBILITY OF THE CONTRACTOR.

**811** Know what's below. Call before you dig. Dial 811 Or Call 800-282-7411

**C-140**

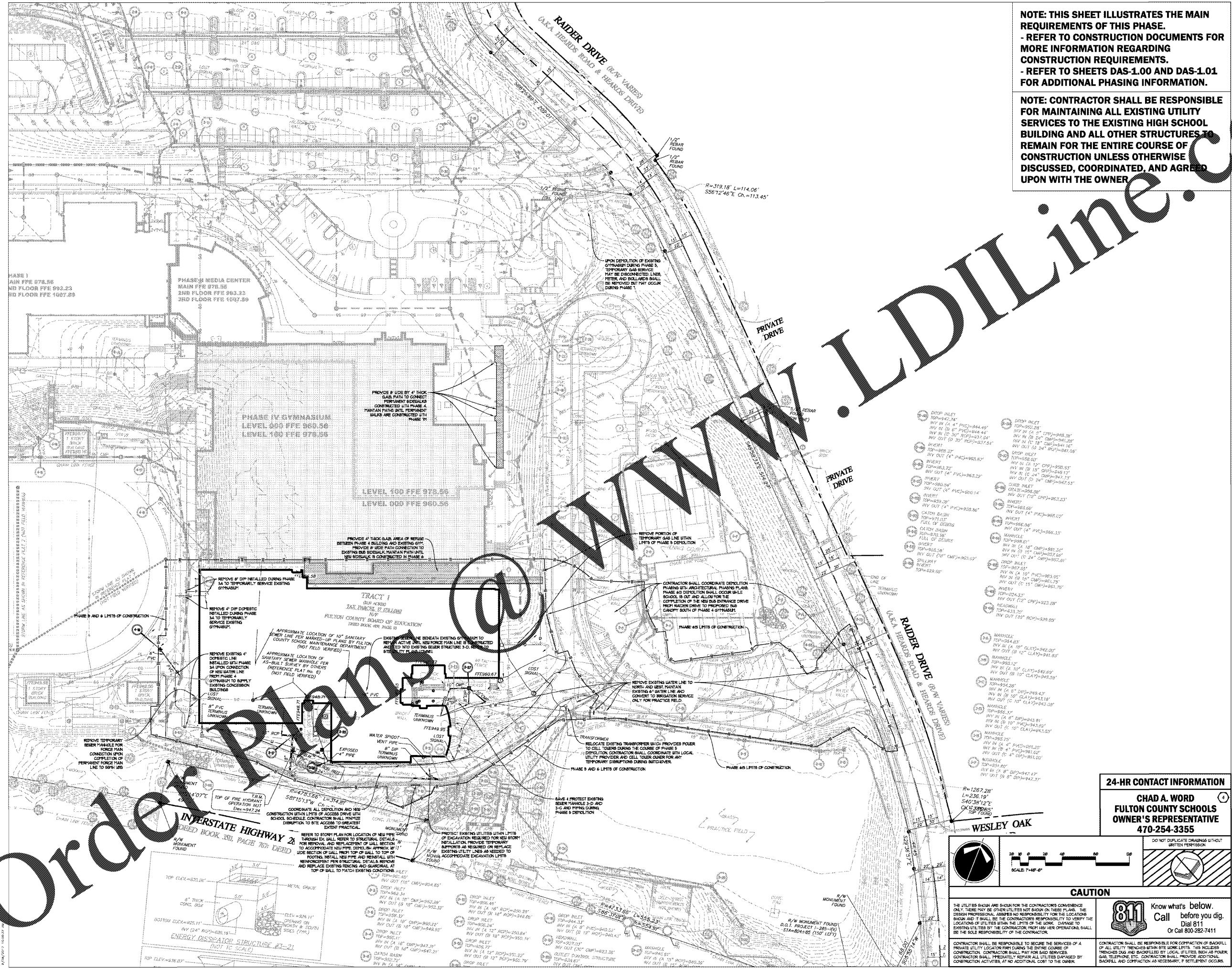

**Order Plans @**

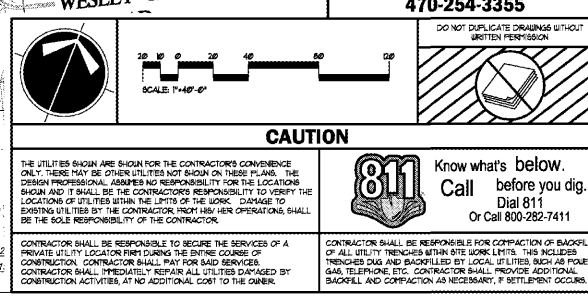
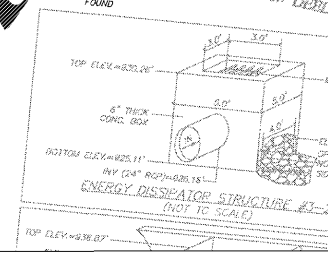

**CAUTION**  
 THE UTILITIES SHOWN ARE SHOWN FOR THE CONTRACTOR'S CONVENIENCE ONLY. THERE MAY BE UTILITIES NOT SHOWN ON THESE PLANS. THE DESIGN PROFESSIONAL ASSUMES NO RESPONSIBILITY FOR THE LOCATIONS OF UTILITIES WITHIN THE LIMITS OF THE WORK. DAMAGE TO EXISTING UTILITIES BY THE CONTRACTOR FROM HIS HER OPERATIONS, SHALL BE THE SOLE RESPONSIBILITY OF THE CONTRACTOR.

**811** Know what's below. Call before you dig. Dial 811 Or Call 800-282-7411

**C-140**