

NOTE: THIS SHEET ILLUSTRATES THE MAIN REQUIREMENTS OF THIS PHASE.
 - REFER TO CONSTRUCTION DOCUMENTS FOR MORE INFORMATION REGARDING CONSTRUCTION REQUIREMENTS.
 - REFER TO SHEETS DAS-1.00 AND DAS-1.01 FOR ADDITIONAL PHASING INFORMATION.

NOTE: CONTRACTOR SHALL BE RESPONSIBLE FOR MAINTAINING ALL EXISTING UTILITY SERVICES TO THE EXISTING HIGH SCHOOL BUILDING AND ALL OTHER STRUCTURES TO REMAIN FOR THE ENTIRE COURSE OF CONSTRUCTION UNLESS OTHERWISE DISCUSSED, COORDINATED, AND AGREED UPON WITH THE OWNER.

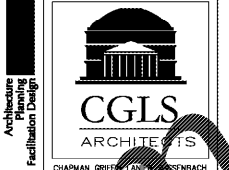

DATE	NO.	DESCRIPTION
05/29/18	001	ISSUE FOR PERMIT
06/11/18	002	ISSUE FOR PERMIT
06/17/18	003	ISSUE FOR PERMIT
10/10/18	004	ISSUE FOR PERMIT
11/01/18	005	ISSUE FOR PERMIT

DATE	NO.	DESCRIPTION
05/29/18	001	ISSUE FOR PERMIT
06/11/18	002	ISSUE FOR PERMIT
06/17/18	003	ISSUE FOR PERMIT
10/10/18	004	ISSUE FOR PERMIT
11/01/18	005	ISSUE FOR PERMIT

24-HR CONTACT INFORMATION
CHAD A. WORD
FULTON COUNTY SCHOOLS
OWNER'S REPRESENTATIVE
470-254-3355

SITE PHASING PLAN (PHASE 4)
 PROJECT NO. 16015.02
 DATE: 09.17.18
 DRAWN BY: KWW
 CHECKED BY: HOB

CAUTION
 Know what's below. Call before you dig. Dial 811 Or Call 800-282-7411

C-130

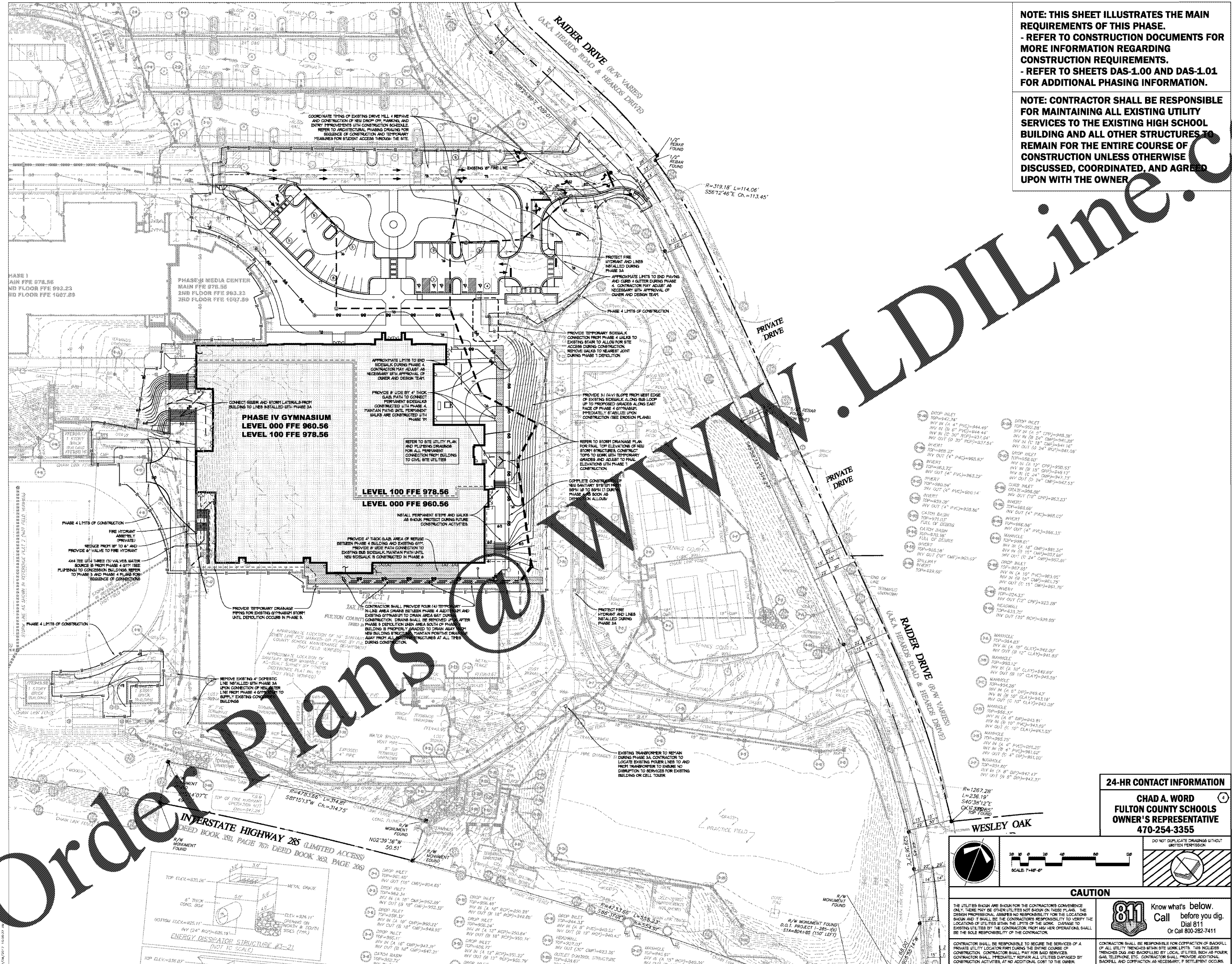

Order Plans @

CHAPMAN GRIFFIN LANIER SUSSENBACH ARCHITECTS
 400 Galleria Pkwy., Suite 100 • Atlanta, Ga 30339 • Phone: 404.733.5493