

NOTE: THIS SHEET ILLUSTRATES THE MAIN REQUIREMENTS OF THIS PHASE.
 - REFER TO CONSTRUCTION DOCUMENTS FOR MORE INFORMATION REGARDING CONSTRUCTION REQUIREMENTS.
 - REFER TO SHEETS DAS-1.00 AND DAS-1.01 FOR ADDITIONAL PHASING INFORMATION.

NOTE: CONTRACTOR SHALL BE RESPONSIBLE FOR MAINTAINING ALL EXISTING UTILITY SERVICES TO THE EXISTING HIGH SCHOOL BUILDING AND ALL OTHER STRUCTURES TO REMAIN FOR THE ENTIRE COURSE OF CONSTRUCTION UNLESS OTHERWISE DISCUSSED, COORDINATED, AND AGREED UPON WITH THE OWNER.

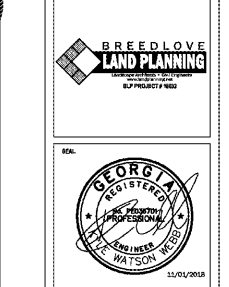

DATE	NO.	DESCRIPTION
03/28/18	001	ISSUE FOR PERMIT
06/18/18	002	ISSUE FOR PERMIT
07/17/18	003	ISSUE FOR PERMIT
10/02/18	004	ISSUE FOR PERMIT
11/02/18	005	ISSUE FOR PERMIT

DOE FACILITY CODE 680-3086
RIVERWOOD HIGH SCHOOL - PHASE 3-B
AUDITORIUM/GYMNASIUM ADDITION
 5900 RAIDER DRIVE NW SANDY SPRINGS, GA 30228
 FULTON COUNTY SCHOOLS REF NO. 411-19

24-HR CONTACT INFORMATION
CHAD A. WORD
FULTON COUNTY SCHOOLS
OWNER'S REPRESENTATIVE
470-254-3355

SITE PHASING PLAN (PHASE 3A ENABLING)
 PROJECT NO. 16015.02
 DATE: 09.17.18
 DRAWN BY: KWW
 CHECKED BY: HGS

CAUTION
 Know what's below. Call before you dig. Dial 811 or Call 800-282-7411
C-110

CHAPMAN GRIFFIN LANIER SUSSENBACH ARCHITECTS
 400 Galleria Pkwy., Suite 100 Atlanta, GA 30339 Phone: 404.733.5493

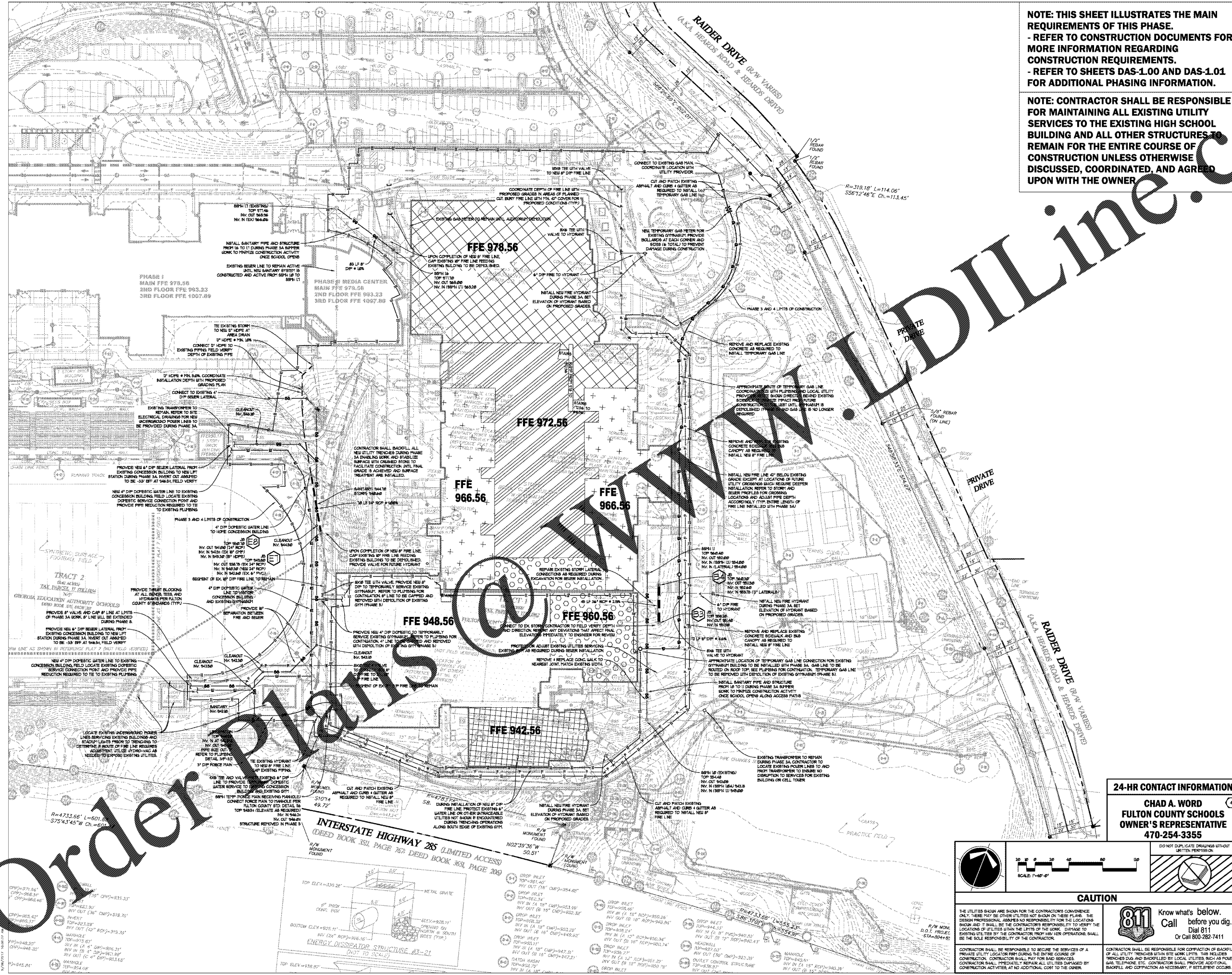

Order Plans @ www.dline.com

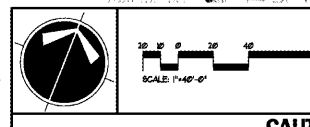

DO NOT DUPLICATE DRAWINGS WITHOUT WRITTEN PERMISSION.
 THE UTILITIES SHOWN ARE SHOWN FOR THE CONTRACTOR'S CONVENIENCE ONLY. THERE MAY BE OTHER UTILITIES NOT SHOWN ON THESE PLANS. THE DESIGN PROFESSIONAL ASSUMES NO RESPONSIBILITY FOR THE LOCATIONS OF UTILITIES WITHIN THE LIMITS OF THE WORK. DAMAGE TO EXISTING UTILITIES BY THE CONTRACTOR FROM HIS OPERATIONS, SHALL BE THE SOLE RESPONSIBILITY OF THE CONTRACTOR.

CONTRACTOR SHALL BE RESPONSIBLE TO SECURE THE SERVICES OF A PRIVATE UTILITY LOCATOR PRIOR TO THE BEGINNING OF CONSTRUCTION. CONTRACTOR SHALL PAY FOR SAID SERVICES. CONTRACTOR SHALL IMMEDIATELY REPAIR ALL UTILITIES DAMAGED BY CONSTRUCTION ACTIVITIES AT NO ADDITIONAL COST TO THE OWNER.

