

Order Plans @ www.LDLine.com

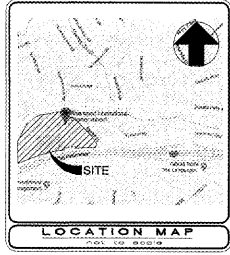
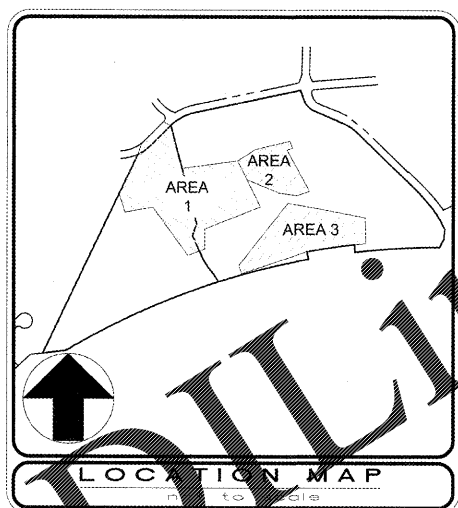
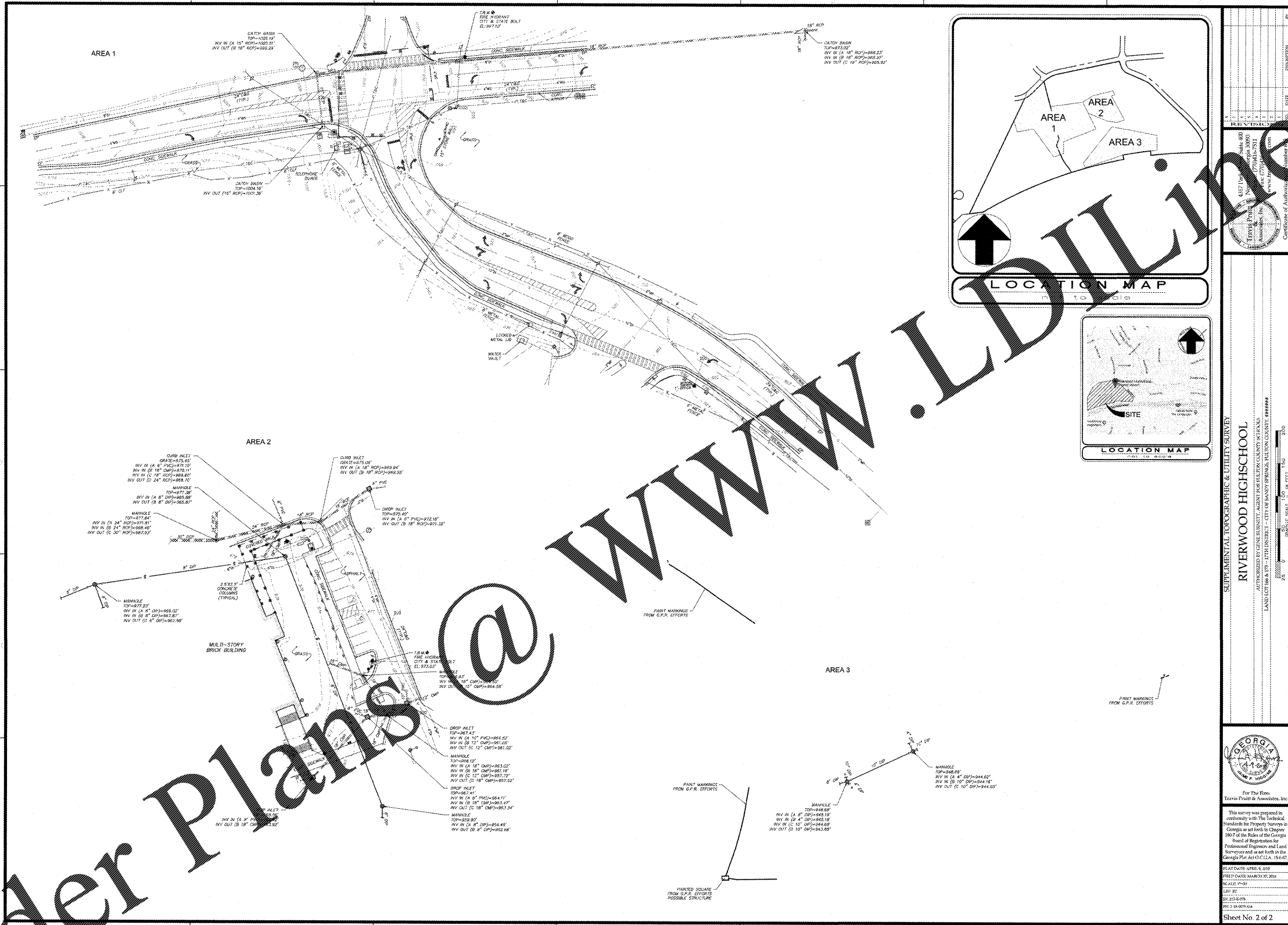

Supplemental Topographic & Utility Survey  
**RIVERWOOD HIGH SCHOOL**  
 AUTHORIZED BY GENE BERNHART, AGENT FOR FULTON COUNTY SCHOOLS  
 LAND ACCT 886 & 87 - 27th DISTRICT - CITY OF SANDY SPRINGS, FULTON COUNTY, GEORGIA

DATE	NO.	DESCRIPTION
03/29/16		DOE FACILITY CODE 880-3086
06/24/16		DOE FACILITY CODE 880-3086
09/27/16		DOE FACILITY CODE 880-3086
10/23/16		DOE FACILITY CODE 880-3086
11/21/16		DOE FACILITY CODE 880-3086

For The Firm  
 TerraPratt & Associates, Inc.  
 This survey was prepared in accordance with the technical standards for Professional Engineers and Land Surveyors and as set forth in the Georgia Professional Code, Official Code of Georgia Annotated, Title 47, Chapter 1807 of the Rules of the Georgia Board of Registration for Professional Engineers and Land Surveyors.

DATE: APR 9, 2018  
 PREP DATE: MARCH 02, 2018  
 SCALE: 1"=30'  
 SHEET NO. 2 OF 2

Architectural Facilitation Design

**CGLS ARCHITECTS**  
 CHAPMAN GRIFFIN LANIER SUSSENBACH ARCHITECTS  
 400 Galleria Pkwy, Suite 100, Atlanta, GA 30339 • Phone: 404.733.5493

RELEASED FOR CONSTRUCTION

**BREEDLOVE LAND PLANNING**  
 1000 W. Peachtree St. N.E., Atlanta, GA 30309 • Phone: 404.525.1100

REGISTERED PROFESSIONAL LAND SURVEYOR  
 GEORGIA  
 WATSON  
 12/02/2008

DATE NO. DESCRIPTION

DOE FACILITY CODE 880-3086  
 RIVERWOOD HIGH SCHOOL - PHASE 3-8  
 AUDITORIUM/GYMNASIUM ADDITION  
 5900 RAIDER DRIVE NW SANDY SPRINGS, GA 30228  
 FULTON COUNTY SCHOOLS RFP NO. 411-19

**CHAPMAN GRIFFIN LANIER SUSSENBACH ARCHITECTS**

SHEET TITLE  
**SUPPLEMENTAL TOPOGRAPHIC & UTILITY SURVEY (2018)**

PLOT NO. 16015.02  
 DATE 09.17.18  
 DRAWN BY: KWW  
 CHECKED BY: HCB

SHEET NO. **C-016**

NOTE: SURVEY AS SHOWN IS FOR REFERENCE ONLY AND HAS BEEN SCALED FROM ITS ORIGINAL FORM AT 30"x42"