

LEGEND

CLF	CHAIN LINK FENCE
WF	WOODEN FENCE
SC	SOILS COLOR
DS	DOWN SLOPE
GE	GROUND ELEVATION
HP	HANDICAP PARKING
SD	SIDE
TM	TEMPORARY BENCHMARK
CB	CURB AND GUTTER
ASPH	ASPHALT
RI	RIGHT OF WAY MONUMENT (NO)
TC	TOP OF CURB
BC	BOTTOM OF CURB
EP	EDGE OF PAVEMENT
2"6"	MEDIUM PRESSURE PLASTIC PIPE
3"6"	DUCTILE IRON PIPE
4"10"	MEDIUM PRESSURE STEEL PIPE
FE	POWERED FEED ELEVATION
PF	POWER POLE HEIGHT
LS	LIGHT STAND
EB	ELECTRIC BOX
OW	OUT WIRE
PP	POWER POLE
PL	PLACING LIGHT POLE
OT	OVERHEAD TRAFFIC LIGHT
TS	TRAFFIC SIGNAL BOX
LL	LANDSCAPE LIGHT
IP	DUCTILE IRON PIPE
PC	POLYETHYLENE GLASS FIBER PIPE
HP	HEADPRESSURE CORRUGATED PIPE
CM	CONDENSATED METAL PIPE
SM	SWASTART SEWER MANHOLE
CO	CLEAN OUT
CB	CATCH BASIN
DI	DROP INLET
JB	JUNCTION BOX
HD	HEADLAMP
TD	TELEPHONE BOX
TM	TELEPHONE MANHOLE
TM	TELEPHONE MONUMENT
GM	GAS METER
GM	GAS MARKER
SM	GAS VALVE
IC	IRRIGATION CONTROL VALVE
IC	POST INDICATOR VALVE
WM	WATER METER
WC	WIRE JOINTMENT CONNECTION
WC	WIRE JOINTMENT
WC	WATER VALVE
MS	MISC. UTILITY STRUCTURE
UL	UNDERGROUND WATER LINE
UL	UNDERGROUND POWER LINE
UL	UNDERGROUND GAS LINE
UL	UNDERGROUND COMMUNICATIONS LINE
UL	SEPARATED POWER CABLE & TELEPHONE LINE
UL	SANITARY SEWER LINE
UL	STORM DRAIN LINE

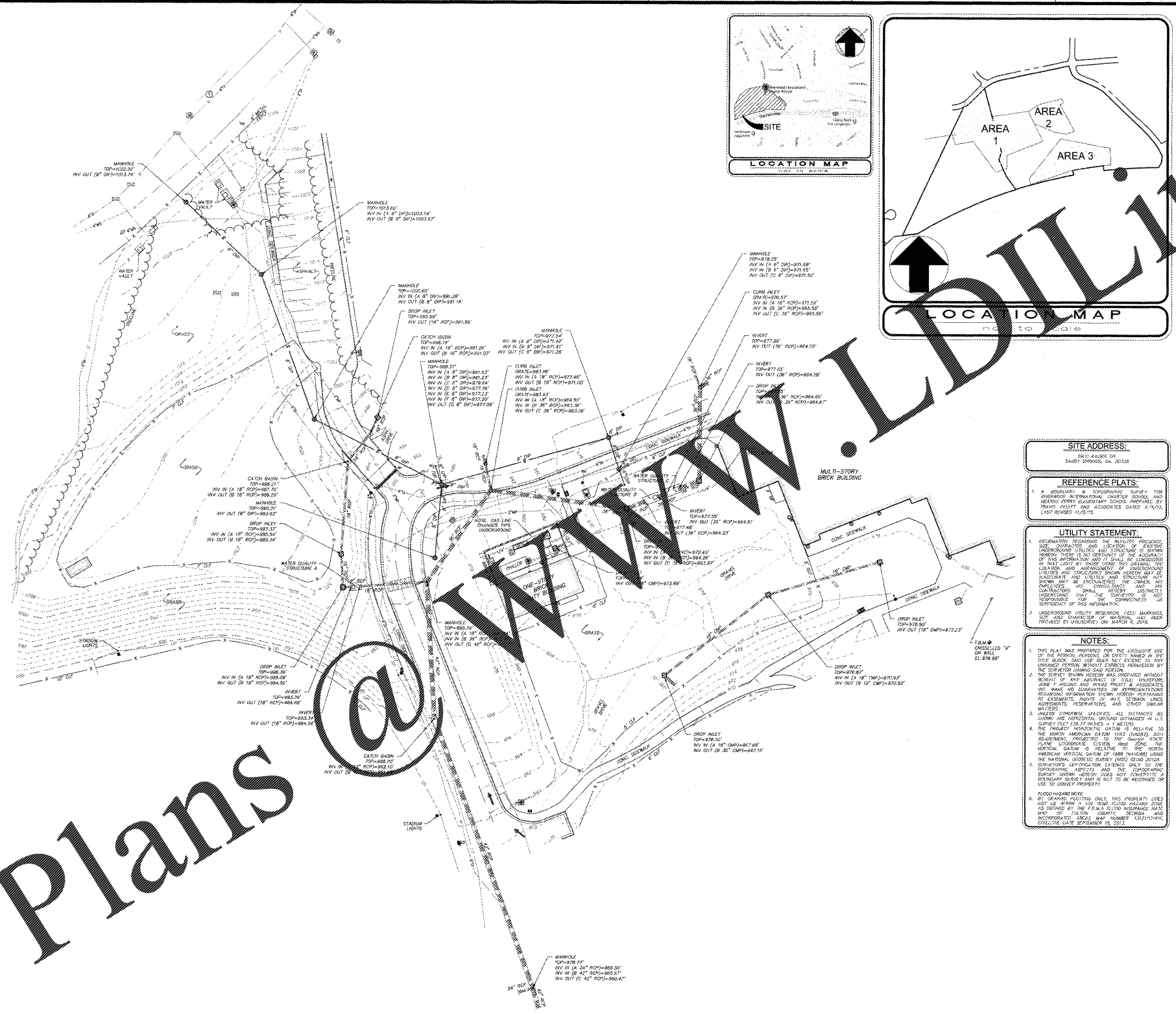

SUPPLEMENTAL TOPOGRAPHIC & UTILITY SURVEY
RIVERWOOD HIGH SCHOOL
 AUTHORIZED BY GEORGETOWN COUNTY, GEORGIA
 LAND LOT 56-2375 - 17TH DISTRICT - CITY OF SANDY SPRING, FULTON COUNTY, GEORGIA

DATE 09/17/18
NO. 16015.02
DESCRIPTION: RIVERWOOD HIGH SCHOOL - PHASE 3-8 AUDITORIUM/GYMNASIUM ADDITION

FOR THE FIRM:
 TARTI FRANK & ASSOCIATES, LLC
 400 Galleria Parkway, Suite 100, Atlanta, GA 30329

FOR THE CLIENT:
 RIVERWOOD HIGH SCHOOL
 6900 RAIDER DRIVE NW, SANDY SPRING, GA 30328
 FULTON COUNTY SCHOOLS, REF NO. 411-19

PROJECT NO. 16015.02
DATE 09.17.18
DRAWN BY: KJW
CHECKED BY: HCB

SHEET NO. 1 OF 2

SITE ADDRESS:
 6900 RAIDER DR
 SANDY SPRING, GA 30328

REFERENCE PLATS:
 1. A BOUNDARY & TOPOGRAPHIC SURVEY FOR UNDERGROUND UTILITIES AND STRUCTURE OF RIVERWOOD HIGH SCHOOL, CHARTER SCHOOL, AND SANDY SPRING ALTERNATIVE SCHOOL, PREPARED BY TARTI FRANK & ASSOCIATES, INC. (DATE 6/14/15). LAST REVISED 11/20/15.

UTILITY STATEMENT:
 1. INFORMATION REGARDING THE RELATED PROCEEDINGS, SIZE, LOCATION AND LOCATION OF EXISTING UNDERGROUND UTILITIES AND STRUCTURE OF RIVERWOOD HIGH SCHOOL, CHARTER SCHOOL, AND SANDY SPRING ALTERNATIVE SCHOOL, PREPARED BY TARTI FRANK & ASSOCIATES, INC. (DATE 6/14/15). LAST REVISED 11/20/15.
 2. UNDERGROUND UTILITY RESEARCH, FIELD MARKING, AND CHANGING OF MATERIALS, HAS BEEN PROVIDED BY UTILITIES ON MAPS 6, 7, 8, 9, 10, 11, 12, 13, 14, 15, 16, 17, 18, 19, 20, 21, 22, 23, 24, 25, 26, 27, 28, 29, 30, 31, 32, 33, 34, 35, 36, 37, 38, 39, 40, 41, 42, 43, 44, 45, 46, 47, 48, 49, 50, 51, 52, 53, 54, 55, 56, 57, 58, 59, 60, 61, 62, 63, 64, 65, 66, 67, 68, 69, 70, 71, 72, 73, 74, 75, 76, 77, 78, 79, 80, 81, 82, 83, 84, 85, 86, 87, 88, 89, 90, 91, 92, 93, 94, 95, 96, 97, 98, 99, 100.

NOTES:
 1. THIS PLAN WAS PREPARED FOR THE EXCLUSIVE USE OF THE PERSONS, FIRMS OR PARTIES NAMED IN THE TITLE BLOCK AND DOES NOT EXTEND TO ANY UNDESIGNED PERSONS, FIRMS OR PARTIES.
 2. THE SURVEYOR HAS CONDUCTED A VISUAL INSPECTION OF THE SITE AND HAS OBSERVED THE EXISTING UTILITIES AND STRUCTURE OF RIVERWOOD HIGH SCHOOL, CHARTER SCHOOL, AND SANDY SPRING ALTERNATIVE SCHOOL, PREPARED BY TARTI FRANK & ASSOCIATES, INC. (DATE 6/14/15). LAST REVISED 11/20/15.
 3. UNDERGROUND UTILITIES RESEARCH, FIELD MARKING, AND CHANGING OF MATERIALS, HAS BEEN PROVIDED BY UTILITIES ON MAPS 6, 7, 8, 9, 10, 11, 12, 13, 14, 15, 16, 17, 18, 19, 20, 21, 22, 23, 24, 25, 26, 27, 28, 29, 30, 31, 32, 33, 34, 35, 36, 37, 38, 39, 40, 41, 42, 43, 44, 45, 46, 47, 48, 49, 50, 51, 52, 53, 54, 55, 56, 57, 58, 59, 60, 61, 62, 63, 64, 65, 66, 67, 68, 69, 70, 71, 72, 73, 74, 75, 76, 77, 78, 79, 80, 81, 82, 83, 84, 85, 86, 87, 88, 89, 90, 91, 92, 93, 94, 95, 96, 97, 98, 99, 100.
 4. AS SHOWN ON THIS PLAN, THIS PROPERTY DOES NOT ADJACENT TO A US NEAR FLOOD HAZARD ZONE AS DETERMINED BY THE FEMA FLOOD INSURANCE RATE MAP OF THE COUNTY, GEORGIA, AND ACCORDINGLY, THESE MAP NUMBER TARTI000404 EFFECTIVE DATE SEPTEMBER 16, 2013.

Order Plans

NOTE: SURVEY AS SHOWN IS FOR REFERENCE ONLY AND HAS BEEN SCALED FROM ITS ORIGINAL FORM AT 30"x42"

CHAPMAN GRIFFIN LANIER SUSSENBACH ARCHITECTS
 400 Galleria Parkway, Suite 100, Atlanta, GA 30329 Phone: 404.733.5493

CGLS ARCHITECTS
 CHAPMAN GRIFFIN LANIER SUSSENBACH ARCHITECTS, INC. MEMBER
 2018
 RELEASED FOR CONSTRUCTION

BREED LOVE LAND PLANNING
 807 PINEY HILL
 SANDY SPRING, GA 30328

GEORGIA REGISTERED PROFESSIONAL LAND SURVEYOR
 TARTI FRANK & ASSOCIATES, LLC
 11/21/2018

DATE 09.17.18
NO. 16015.02
DESCRIPTION: RIVERWOOD HIGH SCHOOL - PHASE 3-8 AUDITORIUM/GYMNASIUM ADDITION

FOR THE FIRM:
 TARTI FRANK & ASSOCIATES, LLC
 400 Galleria Parkway, Suite 100, Atlanta, GA 30329

FOR THE CLIENT:
 RIVERWOOD HIGH SCHOOL
 6900 RAIDER DRIVE NW, SANDY SPRING, GA 30328
 FULTON COUNTY SCHOOLS, REF NO. 411-19

SUPPLEMENTAL TOPOGRAPHIC & UTILITY SURVEY (2018)

PROJECT NO. 16015.02
DATE 09.17.18
DRAWN BY: KJW
CHECKED BY: HCB

C-015