

DRAWING ISSUE RECORD		
DATE	REVISIONS	NO.
10/30/18	BID SET	

HVAC REPLACEMENT FOR
 NORTH OCONEE HIGH SCHOOL
 EG: 108-010-010
 FOR THE
 OCONEE COUNTY BOARD OF EDUCATION
 WATKINSVILLE, GEORGIA

JOB NO. 18-010-010
 DATE: 10/30/18
 SHEET: 4, 2018
 INC. BY: G.T.R.
 G.L.K.

- GENERAL NOTES:** (APPLIES TO ALL SHEETS)
- EXISTING CIRCUITING AND DEVICE LOCATIONS SHOWN ARE TAKEN FROM EXISTING BUILDING PLANS. VERIFY LOCATIONS IN FIELD BEFORE STARTING WORK AND NOTIFY ENGINEER OF ANY DISCREPANCIES THAT WOULD HINDER COMPLETION OF WORK BEFORE WORK BEGINS.
 - ALL EXISTING LIGHTING FIXTURES, CONDUIT AND DEVICES SHALL REMAIN IN AREAS WHERE NO WORK IS SHOWN.
 - WHERE MATERIAL OR OBJECTS ARE REMOVED, RELOCATED OR MODIFIED, CONTRACTOR SHALL PATCH AND REPAIR DAMAGED SURFACE FROM WHICH THE ITEM WAS REMOVED OR MODIFIED TO MATCH THE ADJACENT MATERIAL OR FINISH.
 - THE CONTRACTOR SHALL REMOVE EXISTING CEILING TILES, GRID AND/OR LIGHTS AS NECESSARY TO INSTALL WORK SHOWN ON THE DRAWINGS AND REPAIR THEM WHEN THE WORK IS COMPLETE. ANY ITEMS BROKEN BY THE CONTRACTOR SHALL BE REPLACED WITH NEW ITEMS THAT MATCH EXISTING. IF NEW TILES DO NOT MATCH EXISTING THE CONTRACTOR SHALL INSTALL ALL TILES IN ONE OR MORE ROOMS AND USE THE OLD TILES FOR REPLACEMENT THROUGHOUT THE BUILDING.
 - ALL PENETRATIONS THROUGH FIRE WALLS AND RATED FLOOR SLABS SHALL BE REPAIR WITH OR ASTM E84 FIRE RATING IN ACCORDANCE WITH ARTICLE 900-21 OF THE NATIONAL ELECTRICAL CODE.
 - WHERE AREAS OF BUILDINGS HAVE RETURN AIR FLEUMS ABOVE CEILING, ALL MATERIALS WITHIN FLEUMS ARE REQUIRED TO BE NONCOMBUSTIBLE OR SHALL HAVE A FLAME SPREAD INDEX OF NOT MORE THAN 25 AND A SMOKE DEVELOP INDEX OF NOT MORE THAN 50 AS DETERMINED IN ACCORDANCE WITH ASTM E84.
 - WHERE DEVICES ARE SHOWN TO BE INSTALLED IN EXISTING WALLS, RUN FLEXIBLE METAL CONDUIT DOWN IN WALL FROM ABOVE CEILING TO NEW DEVICE. IF WALL IS INACCESSIBLE RUN RIMMOLD SURFACE METAL RACEWAY DOWN WALL FROM ABOVE CEILING TO DEVICE MOUNTED IN RIMMOLD SURFACE MOUNTED OUTLET BOX.
 - PAINT ALL EXPOSED CONDUIT INSTALLED IN THIS CONTRACT TO MATCH ADJACENT FINISH.

- REFERENCED ELECTRICAL NOTES:**
(APPLIES TO SHEETS E11 THRU E13)
- DISCONNECT EXISTING ROOF TOP UNIT TO BE REPLACED. REMOVE EXISTING DISCONNECT SWITCH ALONG WITH CONDUIT AND CONDUCTORS TO BELOW THE ROOF. INSTALL A NEW JUNCTION BOX ABOVE THE CEILING AND EXTEND EXISTING CIRCUITING UP THROUGH ROOF TO NEW DISCONNECT SWITCH MOUNTED ON NEW ROOF TOP UNIT AND RECONNECT. SEE MECHANICAL EQUIPMENT LEGEND ON SHEET E21 FOR SWITCH AND CONDUCTOR SIZES. SEE MECHANICAL FOR EQUIPMENT TO BE REPLACED.
 - DISCONNECT EXISTING FAN POWERED MIXING BOX TO BE REPLACED. REMOVE EXISTING FLEXIBLE CONDUIT AND CONDUCTORS BACK TO EXISTING JUNCTION BOX TO REMAIN. PROVIDE NEW FLEXIBLE CONDUIT AND CONDUCTORS TO NEW FAN POWERED MIXING BOX AND RECONNECT. SEE MECHANICAL EQUIPMENT LEGEND ON SHEET E21 FOR SWITCH AND CONDUCTOR SIZES. SEE MECHANICAL FOR EQUIPMENT TO BE REPLACED.
 - DISCONNECT EXISTING EQUIPMENT TO BE REMOVED. REMOVE DISCONNECTS, CONDUCTORS AND ACCESSIBLE CONDUIT BACK TO PANELS. SEE MECHANICAL FOR EQUIPMENT TO BE REMOVED.
 - CONNECT NEW FIXTURE TO EXISTING BRANCH LIGHTING CIRCUIT AT EXISTING FIXTURE.
 - DISCONNECT EXISTING ENERGY RECOVERY UNIT TO BE REPLACED. REMOVE EXISTING DISCONNECT SWITCH ALONG WITH CONDUIT AND CONDUCTORS TO BELOW THE ROOF. INSTALL A NEW JUNCTION BOX ABOVE THE CEILING AND EXTEND EXISTING CIRCUITING UP THROUGH ROOF TO NEW DISCONNECT SWITCH MOUNTED ON NEW ENERGY RECOVERY UNIT AND RECONNECT. SEE MECHANICAL EQUIPMENT LEGEND ON SHEET E21 FOR SWITCH AND CONDUCTOR SIZES. SEE MECHANICAL FOR EQUIPMENT TO BE REPLACED.

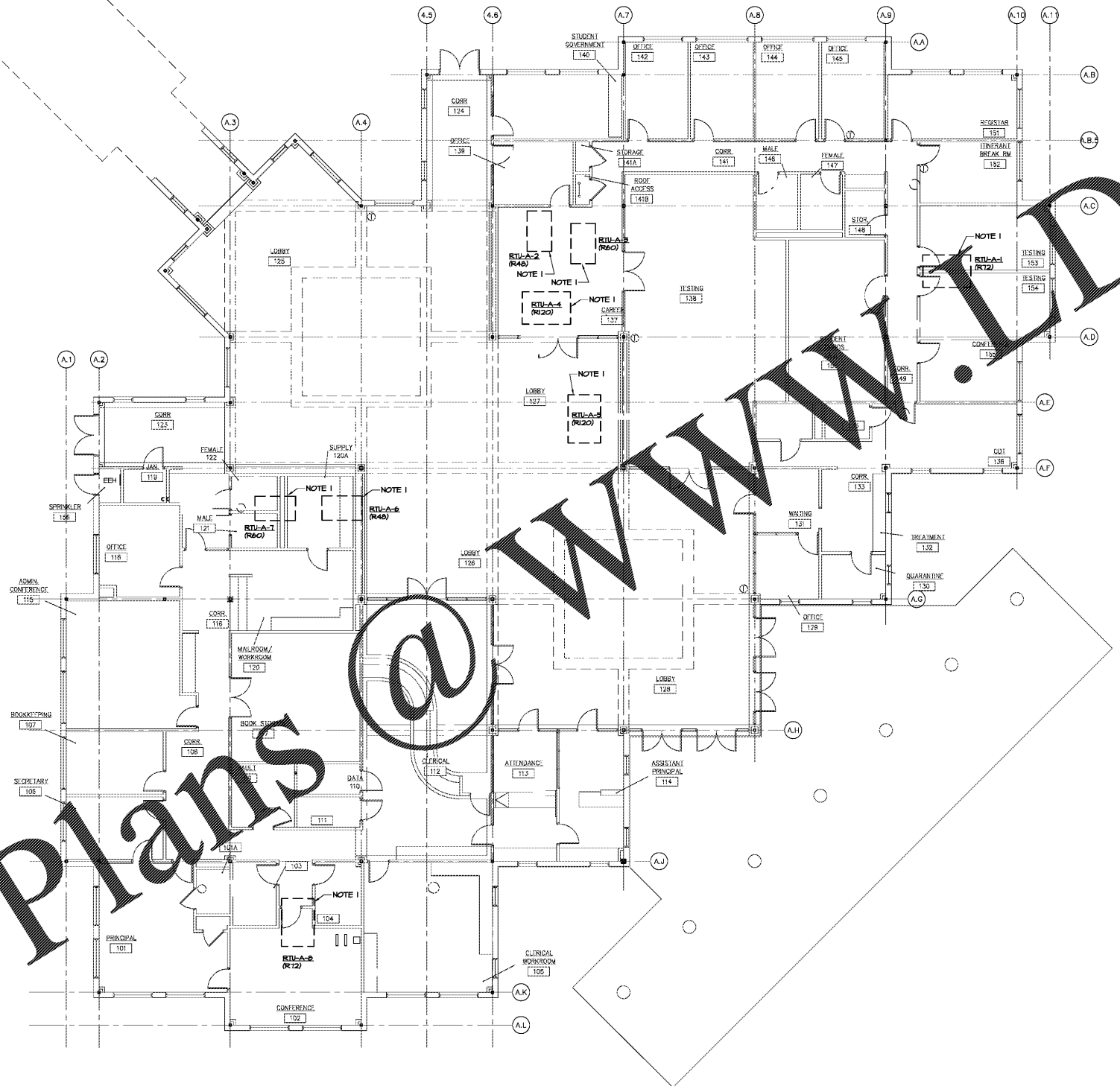
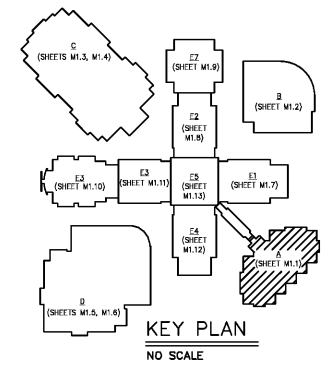

1 PARTIAL FLOOR PLAN - BLDG A - ELECTRICAL
 E1 | 1/8"=1'-0"



cunningham forhand matthews moore
 cunningham, forhand, matthews & moore, architects, inc. - 2011 manchester street, n. e. - atlanta, georgia 30324 - phone (404) 873-2152

Order Plans @ WWW.DIPLI.COM