

DRAWING ISSUE RECORD		
DATE	REVISIONS	NO.
10/30/18	BID SET	

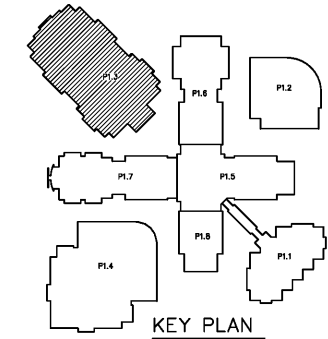

KEY PLAN
NO SCALE

EXIST GAS METER LOAD
 HEATING - 2822 CFH
 WATER HEATING - 1280 CFH
 TOTAL - 4102 CFH
 DELIVERY PRESSURE = 5 PSI

NEW GAS METER LOAD
 HEATING - 2369 CFH
 WATER HEATING - 1280 CFH
 TOTAL - 3649 CFH
 DELIVERY PRESSURE = 5 PSI

REMOVE EXISTING SECTION TO DISCONNECT GAS TO EXISTING GAS AND REMOVE NEW PIPING AND RECONNECT TO NEW RTU. INSTALL NEW SHUT OFF VALVE AND GAS PRESSURE REGULATOR. TYP FOR #

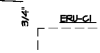
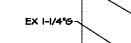
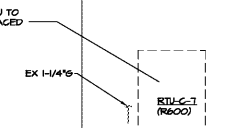
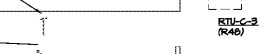
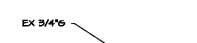
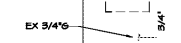
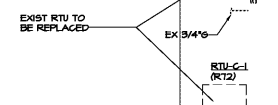
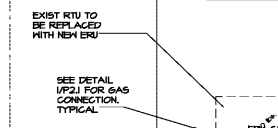
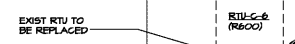
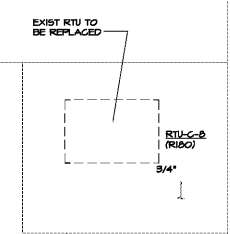
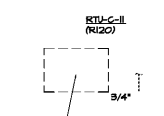
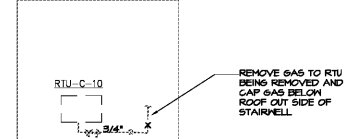
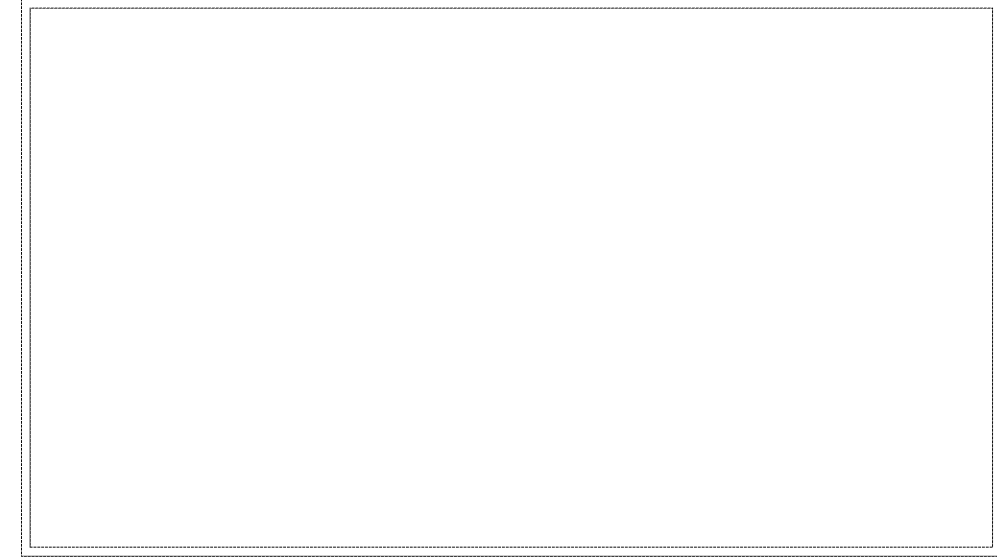

1 PARTIAL FLOOR PLAN - PLUMBING
 PLS 1/8"=1'-0"



SPURLOCK & ASSOCIATES, INC.
 consulting engineers
 2970 Clairmont Rd., Suite 620 | Atlanta, GA 30329
 P: 404.633.0245 | F: 404.633.1756
 JOB NO. 1809

cunningham forehand matthews moore

cunningham, forehand, matthews & moore, architects, inc. - 2011 manchester street, n.e. - atlanta, georgia 30324 - phone (404) 873-2152

DATE: SEPT 14, 2018
 JOB NO.: 8-L-1069-18
 DRAWN BY: J.C.F.
 PROJECT: HVAC REPLACEMENT FOR NORTH OCONEE HIGH SCHOOL
 EG: 108-0101
 FOR THE OCONEE COUNTY BOARD OF EDUCATION
 WATKINSVILLE, GEORGIA