

Order Plans @ www.LDLine.com

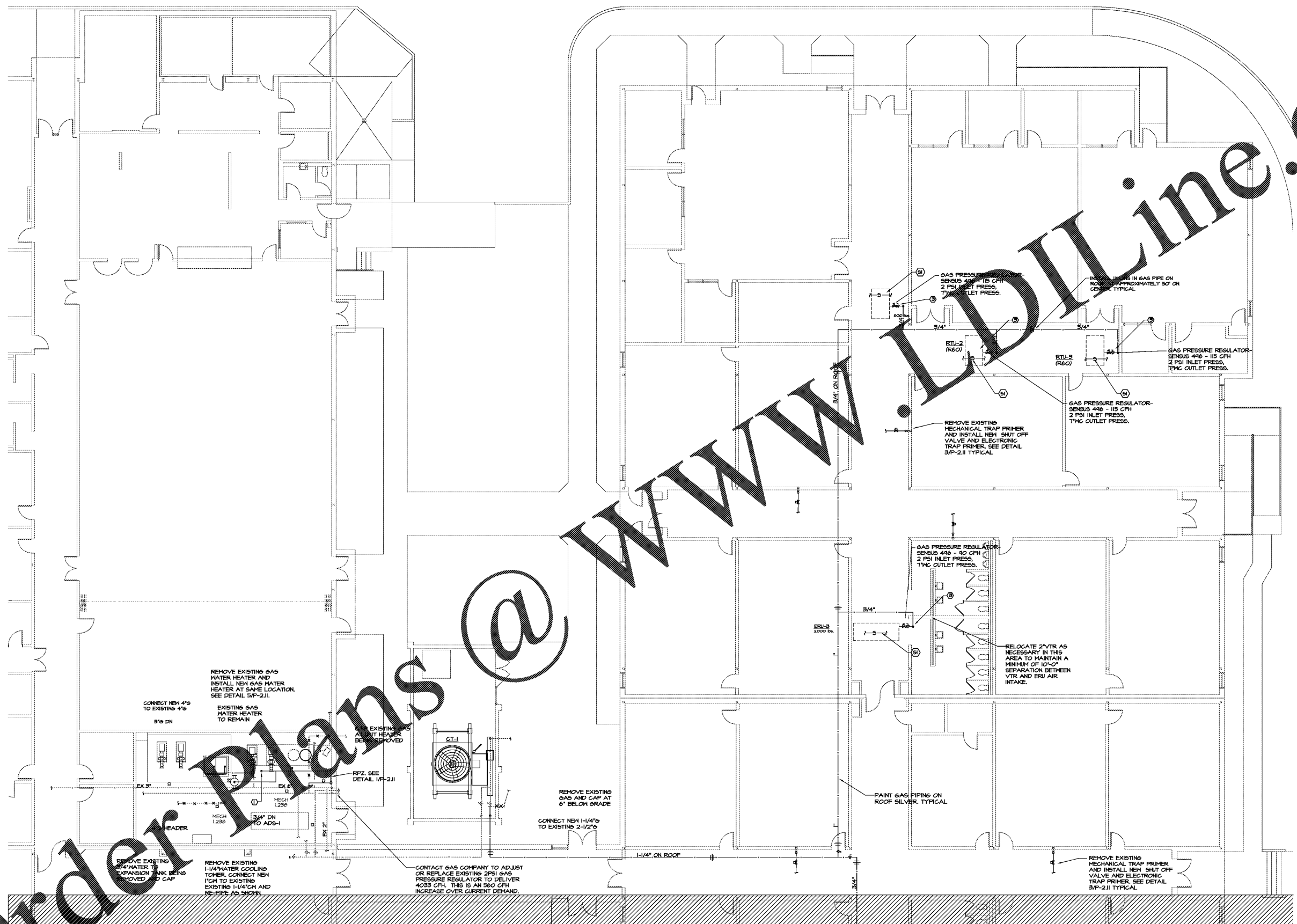

Ⓜ PARTIAL FLOOR PLAN - PLUMBING
 P1.12 1/8"=1'-0" SEE P-1.11 FOR NOTES

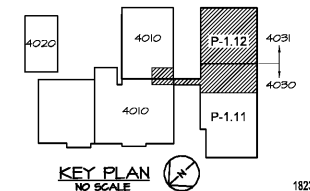

CHAPMAN GRIFFIN LANIER SUSSENBACH ARCHITECTS
 400 Oldfield, Suite 100, Atlanta, Georgia 30308 Phone: 404.733.5500 Fax: 404.733.6504

CHAPMAN GRIFFIN LANIER SUSSENBACH ARCHITECTS, INC.
 2970 Clairmont Rd., Suite 620
 Atlanta, GA 30329
 P: 404.633.0245
 F: 404.633.1756

**FIVE FORKS MIDDLE SCHOOL
 HVAC & ROOFING RENOVATIONS**
 FACILITY NO. 667-0279
 3250 River Drive, Lawrenceville, GA 30044
 GWINNETT COUNTY SCHOOL DISTRICT

PARTIAL FLOOR PLAN - PLUMBING

PROJECT NO. 18007.02
 DATE: OCTOBER 11, 2018
 DRAWN BY: J.C.F.
 CHECKED BY: M.W.D.

P-1.12

1823