

Order Plans

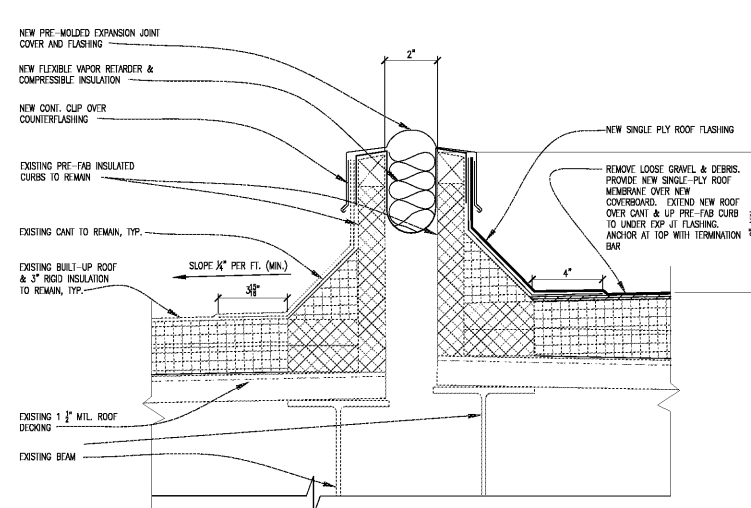

E1 EXPANSION JT. DETAIL
A-4.10 3'-1'-0"

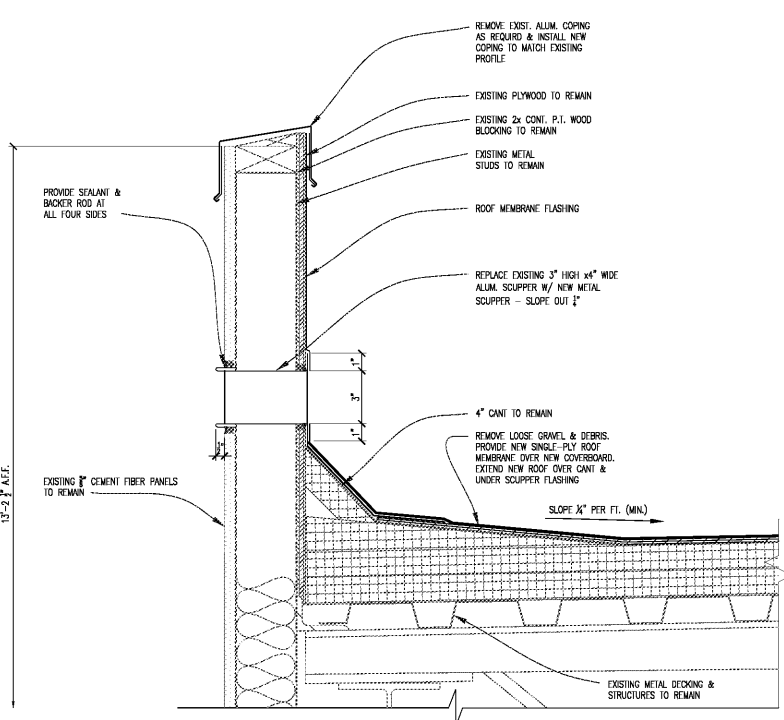

E4 ROOF SCUPPER DETAIL
A-4.10 3'-1'-0"

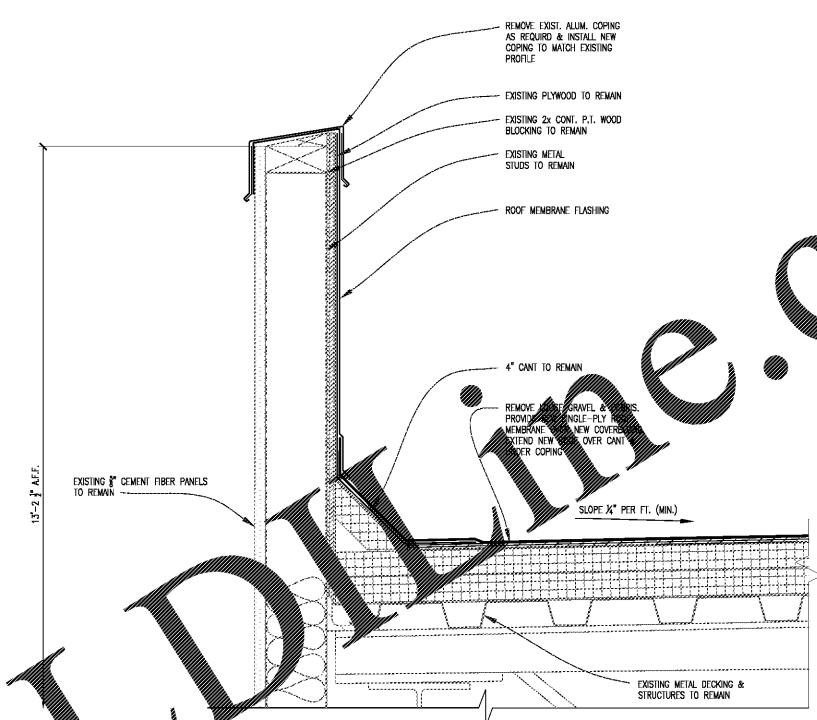

E7 ROOF PARAPET DETAIL
A-4.10 3'-1'-0"

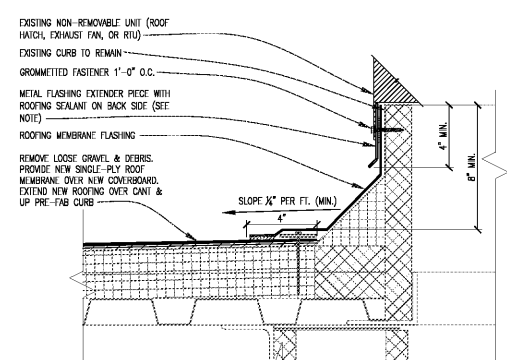

C1 EXISTING NON-REMOVABLE ROOF UNIT DETAIL
A-4.10 3'-1'-0"

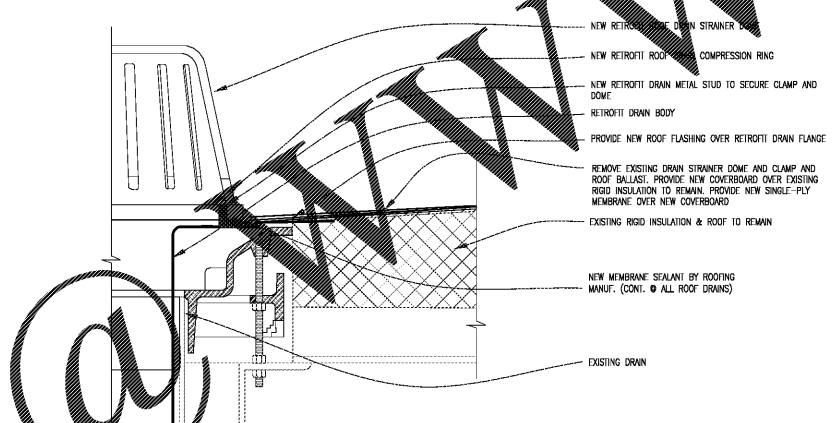

C4 REPLACEMENT ROOF DRAIN
A-4.10 3'-1'-0"

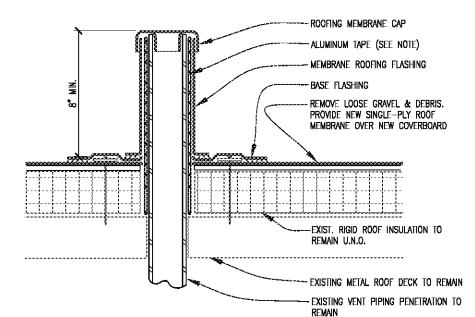

C7 DETAIL WASTE VENT TO REMAIN
A-4.10 3'-1'-0"



CHAPMAN GRIFFIN LANIER SUSENBACH ARCHITECTS
ARCHITECTURE
FACILITATION DESIGN



DATE	NO.	DESCRIPTION
10/11/18	1007	ISSUE FOR BID
10/28/18	1008	ISSUE FOR BID

ANNISTOWN ELEMENTARY SCHOOL
ROOFING RENOVATIONS
FACILITY NO. 667-0282
3150 Spain Road, Snellville, GA 30039
GWINNETT COUNTY SCHOOL DISTRICT

PROJECT TITLE
ROOF DETAILS

PROJECT NO.
18007.01

DATE
OCTOBER 11, 2018

PROJECT NO.
A-4.10

CHAPMAN GRIFFIN LANIER SUSENBACH ARCHITECTS
406 Griffin Parkway • Suite 105 • Atlanta, Georgia 30309 • Phone 404.732.4400